

Оборудование HUEBSCH КАТАЛОГ



Архангельск (8182)63-90-72
Астана (7172)727-132
Астрахань (8512)99-46-04
Барнаул (3852)73-04-60
Белгород (4722)40-23-64
Брянск (4832)59-03-52
Владивосток (423)249-28-31
Волгоград (844)278-03-48
Вологда (8172)26-41-59
Воронеж (473)204-51-73
Екатеринбург (343)384-55-89
Иваново (4932)77-34-06

Ижевск (3412)26-03-58
Иркутск (395)279-98-46
Казань (843)206-01-48
Калининград (4012)72-03-81
Калуга (4842)92-23-67
Кемерово (3842)65-04-62
Киров (8332)68-02-04
Краснодар (861)203-40-90
Красноярск (391)204-63-61
Курск (4712)77-13-04
Липецк (4742)52-20-81
Киргизия (996)312-96-26-47

Магнитогорск (3519)55-03-13
Москва (495)268-04-70
Мурманск (8152)59-64-93
Набережные Челны (8552)20-53-41
Нижний Новгород (831)429-08-12
Новокузнецк (3843)20-46-81
Новосибирск (383)227-86-73
Омск (3812)21-46-40
Орел (4862)44-53-42
Оренбург (3532)37-68-04
Пенза (8412)22-31-16
Казахстан (772)734-952-31

Пермь (342)205-81-47
Ростов-на-Дону (863)308-18-15
Рязань (4912)46-61-64
Самара (846)206-03-16
Санкт-Петербург (812)309-46-40
Саратов (845)249-38-78
Севастополь (8692)22-31-93
Симферополь (3652)67-13-56
Смоленск (4812)29-41-54
Сочи (862)225-72-31
Ставрополь (8652)20-65-13
Таджикистан (992)427-82-92-69

Сургут (3462)77-98-35
Тверь (4822)63-31-35
Томск (3822)98-41-53
Тула (4872)74-02-29
Тюмень (3452)66-21-18
Ульяновск (8422)24-23-59
Уфа (347)229-48-12
Хабаровск (4212)92-98-04
Челябинск (351)202-03-61
Череповец (8202)49-02-64
Ярославль (4852)69-52-93

Единый адрес для всех регионов: hcs@nt-rt.ru || www.huebsch.nt-rt.ru

Стиральные машины VENDED GALAXY™ 600.
Технические характеристики.



HUEBSCH®: YOUR SMART LAUNDRY PARTNER

Success in the laundromat business is determined long before the “Open” sign is switched on. That’s why it’s paramount to work with an experienced partner. With more than 100 years in the laundry business and a distribution network ranked at the top of the industry, Huebsch® truly is your smart laundry partner, guiding you every step of the way.

GALAXY™ 600: THE PINNACLE OF CONVENIENCE AND CONTROL

Your laundry is selling convenience and a high-quality wash. With Huebsch Galaxy™ 600 controls, your laundromat gives customers a user-friendly platform and the flexibility to tailor washes the way they like. Best of all, that flexibility brings additional revenue-generating opportunities. Galaxy 600 benefits include:

- 200 G-Force final extract to reduce drying times, lower utility bills and increase customer satisfaction
- 24 Cycle combinations for customers to choose from
- Time-of-day pricing to help manage peak-period business and attract new customers
- Multi-level vend and cycle modifiers to increase revenue
- Huebsch Command™ compatible for remote management ease

Control Aesthetics Options

Citron

Cityscape

Slate





HUEBSCH

The Huebsch Command™ Technology Suite changes the way you'll run your laundry business. Get unprecedented power over all your business data—

financial, operational, customer, service machine and maintenance—in a single 360-degree control center, enabling you to make informed business decisions and be in command of your business's growth.

- **Owner Dashboard**
- **Customer App**
- **Point of Sale (POS) System**
- **Customer Relationship Management (CRM)**

DISCOVER SMART, REVOLUTIONARY, EFFICIENT TECHNOLOGY

Uses 33% Less Electricity & 17% Less Water than Two-Speed Models

Our advanced inverter drive technology and improved cylinder and sump system design optimize water use, while reducing non-wash water below the cylinder.

High-Speed Extraction Reduces Drying Time

Our improved technology spins up to 200 G-Force, removing more water. This means shorter dry times and lower energy bills.

Advanced Leak Detection Eliminates Wasted Water

Patented Water Guardian™ leak detection uncovers leaks in both the drain and fill valves, eliminating wasted water—and resources.

BACKED BY OUR 10-YEAR LIMITED WARRANTY



Our Galaxy 600 washer-extractors are manufactured at our Ripon, Wisconsin headquarters. We offer an industry-leading, transferable warranty on every product:

- Frame
- Outer Tub
- Cylinder
- Shaft
- Seals and Bearings
- Bearing Housing

VENDED GALAXY™ 600 WASHER-EXTRACTORS

Models		HCT020	HCT030	HCT040	HCT060	HCT080	HCT100	
Control Options		Galaxy™ 600	Galaxy™ 600	Galaxy™ 600	Galaxy™ 600	Galaxy™ 600	Galaxy™ 600	
Capacity – lb (kg)		20 (9)	30 (13.6)	40 (18)	60 (27)	80 (36)	100 (45)	
Overall Width – in (mm)		26 (660)	29 (737)	30.6 (777)	34.1 (866)	41.5 (1054)	41.5 (1054)	
*Overall Depth – in (mm)		30.9 (785)	35.3 (897)	42.3 (1074)	44.7 (1135)	47.1 (1196)	51.1 (1298)	
Overall Height – in (mm)		43 (1092)	45 (1143)	47.2 (1199)	49.9 (1267)	57.2 (1453)	57.2 (1453)	
Cylinder Diameter – in (mm)		21 (533)	24 (610)	26.3 (668)	30 (762)	36 (914)	36 (914)	
Cylinder Depth – in (mm)		13.8 (351)	16 (406)	20.3 (516)	22 (559)	21.9 (556)	25.9 (658)	
Cylinder Volume – cu ft (liters)		2.8 (79)	4.2 (119)	6.3 (178)	9 (225)	12.9 (365)	15.2 (430)	
Door Opening Size – in (mm)		11.6 (295)	14.3 (363)	16.3 (414)	16.3 (414)	18.5 (470)	18.5(470)	
Door Bottom to Floor – in (mm)		14.4 (366)	14 (356)	14.6 (371)	14.9 (378)	17.9 (455)	17.9 (455)	
Water Inlet Connection – in (mm)		2 x 0.75 (19)	2 x 0.75 (19)	2 x 0.75 (19)	4 x 0.75 (19)	4 x 0.75 (19)	4 x 0.75 (19)	
Drain Diameter – in (mm)		1 x 3 (76)	1 x 3 (76)	1 x 3 (76)	1 x 3 (76)	1 x 3 (76)	1 x 3 (76)	
Drain Height to Floor – in (mm)		3.9 (99)	4.3 (109)	4.5 (114)	4.9 (124)	5.1 (130)	5.1 (130)	
Motor Power Consumption – HP(kW)		1 (0.75)	1 (0.75)	2 (1.5)	3 (2.2)	5 (3.7)	5 (3.7)	
Total # of Speeds		6, 9	6, 9	6, 9	6, 9	6, 9	6, 9	
Cylinder Speeds – RPM (G-Force)		Gentle	37 (0.4)	34 (0.4)	33 (0.4)	31 (0.4)	28 (0.4)	28 (0.4)
		Wash	51 (0.8)	48 (0.8)	46 (0.8)	43 (0.8)	39 (0.8)	39 (0.8)
		Distribution	92 (2.5)	86 (2.5)	82 (2.5)	77 (2.5)	70 (2.5)	70 (2.5)
		Very Low	301 (27)	282 (27)	269 (27)	252 (27)	230 (27)	230 (27)
		Low	518 (80)	485 (80)	464 (80)	434 (80)	396 (80)	396 (80)
		Medium	579 (100)	542 (100)	518 (100)	485 (100)	443 (100)	443 (100)
		High	648 (125)	606 (125)	579 (125)	542 (125)	495 (125)	495 (125)
		Very High	710 (150)	664 (150)	635 (150)	594 (150)	542 (150)	542 (150)
		Ultra High	819 (200)	766 (200)	733 (200)	686 (200)	626 (200)	568 (165)
**	B	120/60/1	15-9	15-12	20-15	N/A	N/A	N/A
Voltage/ Circuit Breaker - FLA	X	200-240/50-60/1/3	15-4 (1 Ph) 15-3 (3 Ph)	15-7 (1 Ph) 15-4 (3 Ph)	15-7 (1 Ph) 15-4 (3 Ph)	15-11 (1 Ph) 15-7 (3 Ph)	20-15 (1 Ph) 15-9 (3 Ph)	20-16 (1 Ph) 15-10 (3 Ph)
	Y	200-240/60/1/3 (Pump Drain Only)	15-4 (1 Ph)	15-7 (1 Ph) 15-4 (3 Ph)	15-7 (1 Ph) 15-4 (3 Ph)	N/A	N/A	N/A
Shipping Dimensions Approx. – in (mm)		Width	28 (711)	31.5 (800)	32.5 (826)	37.5 (953)	44 (1118)	44 (1118)
		Depth	33.8 (859)	38.3 (973)	43.5 (1105)	46.9 (1191)	54.5 (1384)	58.5 (1486)
		Height	49.4 (1255)	51.3 (1303)	53.6 (1361)	56.3 (1430)	59.6 (1514)	59.6 (1514)
Net Weight – lb (kg)		340 (154)	440 (200)	540 (245)	680 (308)	1250 (567)	1280 (581)	
Shipping Weight – lb (kg)		380 (172)	480 (218)	580 (263)	720 (327)	1300 (590)	1330 (603)	
Slat Crate Shipping Weight – lb (kg)		460 (209)	580 (263)	680 (308)	840 (381)	1430 (649)	1460 (662)	
***Agency Approvals		cULus	cULus	cULus	cULus	cULus	cULus	

*Overall depth includes vacuum breaker to door handle.

** Circuit breaker and amp draw data shown are for models without electric heat. Consult factory for other configurations. Manufacturer strongly recommends using a circuit breaker instead of fuses. Use 3-pole circuit breakers for 3-phase machines.

***Agency approvals may vary depending on configuration. Steam connection requires ½" N.P.T.

For the most accurate information, the installation guide should be used for all design and construction purposes. Due to continuous product improvements, design and specifications subject to change without notice. The quality management systems at Alliance Laundry Systems are registered to ISO 9001.

Vended Stack Washer-Dryer

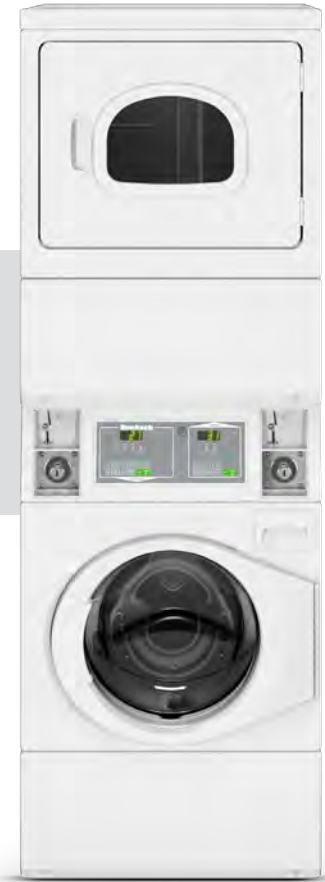

At Huebsch®, our priority is making commercial laundry equipment that's perfectly aligned with your business philosophy. In other words, because you believe that profit is the inevitable result of superior efficiency, durability, simplicity and service, that's exactly what we deliver.

CUTTING-EDGE BALANCE SENSING SYSTEM

An updated suspension and new sensing technologies combine to redistribute loads and maintain cycle times—resulting in reduced utility costs, shorter wait times and increased turns through your store.

FAST DRYING TIMES

Huebsch dryers offer a 7.0 cu. ft. cylinder with an 18 lb capacity offers ample space for large loads to tumble and product fast drying times, while lowering utility consumption.

UNMATCHED DURABILITY

Built with premium materials and tested to meet the demands of the harshest environments, these commercial-grade machines deliver reliable, efficient operation load after load—and they're backed up by Huebsch's standard three-year warranty.

INCREDIBLE 440 G-FORCE

Increased spin speed maximizes moisture removal and reduces drying times, getting customers in and out of your store faster—and ensuring they leave satisfied.

SPACE SAVINGS

A stack washer-dryer gives your vended laundry all the benefits of two stand-alone washers and dryers in a space of one machine. The stack utilizes all the same connections as a standard washer and dryer, so there are no special hookups required.



MICRO-DISPLAY CONTROL II

The Micro-Display Control II features a time-remaining countdown, coin countdown and cycle status lights.

Vended **Stack Washer-Dryer** specifications

Specifications	Washer	Dryer
Available Controls	MDC II	
Models	Electric Gas	HTEBCASPI75TW01, HTEBXASP285CW01, HTEBXASP295CW01, HTEBYASP285CW01 HTGBCASPI115TW01, HTGBYASPI115TW01, HTGBXASPO95CW01, HTGBYASPO95CW01
Capacity - lb (kg)	21.5 (9.5)	18 (8.2)
Cylinder Volume - cu. ft. (liters)	3.42 (96.8)	7.0 (198)
Width - in (mm)	26.875 (683)	
Depth - in (mm)	27.75 (704)	
Height - in (mm)	78.19 (1986)	
Spin Speed -G-Force (RPM)	440 (1200)	N/A
Motor Size - HP (kw)	Variable Speed Induction 0.9 (0.67)	0.33 (0.25)
Water Consumption per Cycle* - g (l)	13.68 (51.8)	N/A
IWF (Water Factor)	4.0	N/A
IMEF (Modified Energy Factor)	2.20	N/A
Available Heat Sources	N/A	Electric or Gas
Available Heating Element (Electric W)	N/A	4750 @ 208V 5350 @ 240V
Gas Inlet Connection - in (mm)	N/A	3/8 (9.5)
Gas Consumption - BTU/Hr	N/A	25,000
Exhaust Outlet Diameter - in (mm)	N/A	4 (102)
Exhaust Airflow - cfm (liters/sec)	N/A	220 (105)
Available Water Temperatures	3	N/A
Available Cycles*	Normal, Perm Press, Delicate	High, Medium, Low, Delicates
Water Pressure - PSI (Bar)	20-120 (1.4/8.3)	N/A
Cycle Indicator Lights	Yes	
Cylinder Finish	Stainless Steel	Galvanized
Available Colors	White	
Door Type (Solid/Window)	Window	
US Electrical Requirements - (Voltage/Hz/Ph)	120/60/1 - 15 Amp	Electric: 120/240/60/1 - 30 Amp Electric: 120/208/60/1 - 30 Amp Gas: 120/60/1 - 15 Amp
Canada Electrical Requirements - Single Supply Cord (Voltage/Hz/Ph)	Electric: 120/240/60/1 - 40 Amp Electric: 120/208/60/1 - 40 Amp Gas: 120/60/1 - 20 Amp	
Shipping Dimensions - in (mm)	Width Depth Height	29 (737) 32.75 (832) 80 (2032)
Net Weight - lb (kg)	390 (177)	
Shipping Weight - lb (kg)	425 (193)	
Available Agency Approvals	C ^{UL} US	Elec: C ^{UL} US, Gas: C ^{CSA} US

* Information shown applies to highest end control available.

Note: Not all options are available for all models.

Refer to the price list for the available models and options.

Lower unit is ADA Compliant.

For the most accurate information, the installation guide should be used for all design and construction purposes. Due to continuous product improvements, design and specifications subject to change without notice. The quality management systems at Alliance Laundry Systems are registered to ISO 9001.

Vended Top Load Washer with Galaxy™



At Huebsch®, our priority is making commercial laundry equipment that's perfectly aligned with your business philosophy. In other words, because you believe that profit is the inevitable result of superior efficiency, durability, simplicity and service, that's exactly what we deliver.

LOW WATER USE

Huebsch top load washers offer owners ultra-efficient cycle selections which average just 28 gallons of water consumption per cycle.

HIGH SPIN SPEED

With an industry-best final spin of 710 RPM, Huebsch top load washers remove more water from loads than many competing models. The end result is reduced drying times for customers and lower utility consumption for store owners.

HEAVY-DUTY POWER

Our top load washer is powered by a heavy-duty 1/2 horsepower motor. The washer performance is further fortified by an automatic balance system, which ensures cycles aren't interrupted by unbalanced loads.

UNMATCHED DURABILITY

Built with premium materials and tested to meet the demands of the harshest environments, these commercial-grade machines deliver reliable, efficient operation load after load—and they're backed up by Huebsch's standard three-year warranty.

NETWORK TECHNOLOGY

Huebsch top load washers with Galaxy™ 600 controls are now equipped with network-ready capabilities and network board installations.

GALAXY™ 600 CONTROLS

Integrating Galaxy 600 controls allows for intuitive operation and simple programming throughout your store with revenue-boosting options. Better yet, it means your vended top load washer is Huebsch Command™ compatible.

HUEBSCH COMMAND™

LAUNDROMAT DATA AND ANALYTICS THAT ARE CUSTOM-MADE FOR THE WAY YOU OPERATE

The Galaxy™ 600 Top Load Washer is Huebsch Command™ compatible. That means you get all features of the Galaxy control—but now you can use them remotely, from anywhere in the world with an internet connection. Huebsch Command also offers a convenient mobile app that not only delivers more flexible payment options, but also a Huebsch Rewards program to inspire greater customer loyalty to your store.



ADVANCED
PERFORMANCE DATA



REMOTE START AND
SYSTEM MONITORING



SERVICE ALERTS VIA
EMAIL OR TEXT



GENERATE CUSTOMER
LOYALTY WITH REWARDS



CONFIGURE MACHINES
FROM THE CLOUD



TURNS PER DAY



MOBILE APP PAYMENT
FLEXIBILITY

Vended **Top Load Washer** specifications

Specifications		
Control Options	Galaxy™ 600	Coin Drop
Models	HWNKC2SP115TW01 HWNKY2SP115CW01 HWNZC2SP115TW01	HWNSX2SP115TW01 HWNSX2SP115CW01
Capacity - lb (kg)	16 (7.3)	
Cylinder Volume - cu. ft. (liters)	3.19 (90.3)	
Width - in (mm)	25.63 (650)	
Depth - in (mm)	28 (711)	
Height - in (mm)	43 (1092)	
Maximum Spin Speed - G-Force (RPM)	150 (710)	
Motor Size - HP (kw)	0.5 (0.37)	
Water Consumption per Cycle* - g (l)	28.07 (106)	
WF (Water Factor)	8.8	
MEF (Modified Energy Factor)	1.35	
Available Water Temperatures	3	
Available Cycles*	Normal, Perm Press, Delicate	
Water Pressure - PSI (Bar)	20-120 (1.4/8.3)	
Cycle Indicator Lights	Yes	
Cylinder Finish	Stainless Steel	
Available Colors	White	
Available Electrical Requirements - (Voltage/Hz/Ph)	120/60/1 - 15 Amp	
Net Weight - lb (kg)	190 (86)	
Shipping Weight - lb (kg)	210 (95)	
Shipping Width - in (mm)	27.5 (699)	
Shipping Depth - in (mm)	30 (762)	
Shipping Height - in (mm)	44.25 (1124)	
Available Agency Approvals	cUL _{us}	

* Information shown applies to highest end control available.

Note: Not all options are available for all models.

Refer to the price list for the available models and options.

For the most accurate information, the installation guide should be used for all design and construction purposes. Due to continuous product improvements, design and specifications subject to change without notice. The quality management systems at Alliance Laundry Systems are registered to ISO 9001.

Vended Front Load Washer with Galaxy 600™



At Huebsch, our priority is making commercial laundry equipment that's perfectly aligned with your business philosophy. In other words, because you believe that profit is the inevitable result of superior efficiency, durability, simplicity and service, that's exactly what we deliver.

CUTTING-EDGE BALANCE SENSING SYSTEM

An updated suspension and new sensing technologies combine to redistribute loads and maintain cycle times—resulting in reduced utility costs, shorter wait times and increased turns through your store.

10-DEGREE TILTED CONTROL PANEL

Improved control visibility and ease-of-use make for an ideal user experience.

INNER & OUTER STAINLESS-STEEL TUBS

Built to be virtually indestructible.

INCREDIBLE 440 G-FORCE

Increased spin speed maximizes moisture removal and reduces drying times, getting customers in and out of your store faster—and ensuring they leave satisfied.

UNMATCHED DURABILITY

Built with premium materials and tested to meet the demands of the harshest environments, these commercial-grade machines deliver reliable, efficient operation load after load—and they're backed up by Huebsch's standard three-year warranty.

20% LARGER CAPACITY

Increased capacity means bigger loads, which allow for higher vend pricing. In addition, improved water and energy efficiencies lower utility bills and keep more money in your pocket.

GALAXY™ 600 CONTROLS

Integrating Galaxy 600 controls allows for intuitive operation and simple programming throughout your store with revenue-boosting options. Better yet, it means your Vended Front Load Washer is Huebsch Command-compatible.

HUEBSCH COMMAND™

LAUNDROMAT DATA AND ANALYTICS THAT ARE CUSTOM-MADE FOR THE WAY YOU OPERATE

The Galaxy™ 600 Washer-Extractor is Huebsch Command-compatible. That means you get all features of the Galaxy control—but now you can use them remotely, from anywhere in the world with an internet connection. Huebsch Command also offers a convenient mobile app that not only delivers more flexible payment options, but also a Huebsch Rewards program to inspire greater customer loyalty to your store.



Vended **Galaxy™ 600 Front Load Washer** specifications

Specifications	
Models	Slate - White HFNKCASG116TW01, HFNKCASP116TW01 Slate - Stainless Steel HFNKCASG116TN01, HFNKCASP116TN01, HFNKYASG116CN01, HFNKYASP116CN01
Color	White or Stainless Steel
Control Location	Front
Capacity - lb (kg)	21.5 (9.5)
Cylinder Volume - cu. ft. (liters)	3.42 (96.8)
Width - in (mm)	26.9 (683)
Depth - in (mm)	27.75 (704)
Height - in (mm)	44.38 (1126)
Maximum Spin Speed - G-Force (RPM)	440 (1200)
Motor Size - HP (kw)	Variable Speed Induction 0.9 (0.67)
Water Consumption per Cycle* - g (l)	13.68
WF (Water Factor)	4
MEF (Modified Energy Factor)	2.20
Available Water Temperatures	3
Available Cycles*	Hot, Warm, Cold, Blankets, Delicate Warm, Delicate Cold
Water Pressure - PSI (Bar)	20-120 (1.4/8.3)
Cycle Indicator Lights	Yes
Cylinder Finish	Stainless Steel
Available Colors	White, Stainless Steel
Door Type (Solid/Window)	Window
Available Electrical Requirements - (Voltage/Hz/Ph)	120/60/1 - 15 Amp
Net Weight - lb (kg)	260 (118)
Shipping Weight - lb (kg)	270 (122)
Shipping Width - in (mm)	30 (762)
Shipping Depth - in (mm)	34 (864)
Shipping Height - in (mm)	45.5 (1156)
Available Agency Approvals	cUL _{us}

* Information shown applies to highest end control available.

Note: Not all options are available for all models.

Refer to the price list for the available models and options.

Front control unit is ADA Compliant.

Aesthetic conversion package available.

Сушильные машины VENDED GALAXY™ 600.
Технические характеристики.



HUEBSCH®: YOUR SMART LAUNDRY PARTNER

Success in the laundromat business is determined long before the “Open” sign is switched on. That’s why it’s paramount to work with an experienced partner. With more than 100 years in the laundry business and a distribution network ranked at the top of the industry, Huebsch® truly is your smart laundry partner, guiding you every step of the way.

GALAXY™ 600: THE PINNACLE OF CONVENIENCE AND CONTROL

Galaxy controls make life easier for both laundromat owners and customers with intuitive operation, simple programming and easy-to-understand diagnostics and reports. Galaxy 600 benefits include:

- Four optimized drying cycles
- Time-of-day pricing to help manage peak-period business and attract new customers
- Digital display keeps customers aware of the cycle time remaining
- Huebsch Command™ compatible for remote management ease

Aesthetics Packages

Citron

Cityscape

Slate

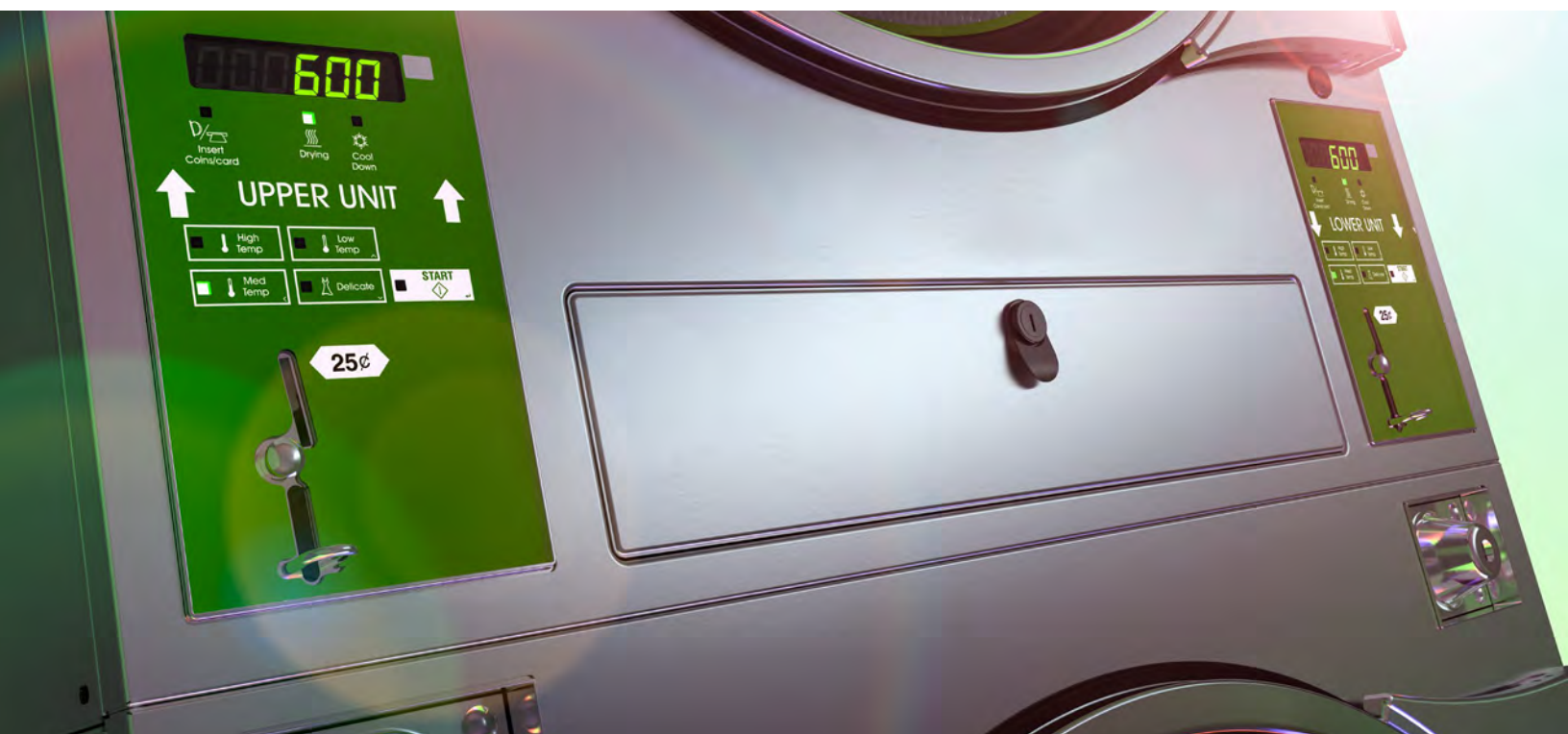



HUEBSCH

The Huesbch Command™ Technology Suite changes the way you'll run your laundry business. Get unprecedented power over all your business data—

financial, operational, customer, service machine and maintenance—in a single 360-degree control center, enabling you to make informed business decisions and be in command of your business's growth.

- **Owner Dashboard**
- **Customer App**
- **Point of Sale (POS) System**
- **Customer Relationship Management (CRM)**

INVEST IN ADVANTAGE WITH SUPERIOR ENGINEERING

Optimum Efficiency

Huesbch tumble dryers have been engineered to provide the fastest, most efficient drying cycles in the industry. Faster drying means less time spent at the laundromat and increased customer satisfaction, loyalty and store profits.

Damage-Resistant

Our patented, oblong cylinder perforations enable drywall screws forgotten in pockets to pass harmlessly through machines without damaging the tumblers' sweep sheets or a user's clothing.

Sleek Design

Streamlined and fastenerless fronts along with chrome doors and ergonomic handles give your machines a clean, professional look. Design upgrades ensure your customers know they are using top-quality equipment.

BACKED BY OUR 5-YEAR LIMITED WARRANTY



Built with premium materials and tested to meet the demands of the harshest environments, these commercial-grade machines deliver reliable, efficient operation—and they're backed by Huesbch's standard three-year warranty.

VENDED GALAXY™ 600 TUMBLE DRYERS

Models	HT030	HT035	HT050	HT055	HT075	HTT30	HTT45
Control Options	Galaxy™ 600	Galaxy™ 600,	Galaxy™ 600	Galaxy™ 600	Galaxy™ 600	Galaxy™ 600	Galaxy™ 600
Capacity – lb (kg)	30 (13)	35 (16)	50 (25)	55 (24)	75 (34)	30 (13) x 2	45 (20) x 2
Width – in (mm)	27.9 (710)	31.5 (800)	38.5 (980)	34.5 (876)	38.5 (980)	31.5 (800)	34.5 (875)
Depth – in (mm)	45.5 (1155)	45.5 (1155)	46.8 (1190)	53.1 (1350)	53.0 (1350)	42.8 (1090)	48.6 (1235)
Height – in (mm)	63.9 (1625)	63.9 (1625)	77.3 (1960)	66.7 (1700)	77.3 (1960)	76.3 (1940)	81.3 (2065)
Cylinder Depth – in (mm)	30.0 (762)	30.0 (762)	30.0 (762)	35.0 (889)	36.0 (914)	26.0 (660)	30.0 (762)
Cylinder Diameter – in (mm)	26.5 (673)	30 (762)	37.0 (940)	33 (838)	37.0 (940)	30.0 (762)	33.0 (838)
Cylinder Volume – cu ft (liters)	9.6 (270)	12.3 (350)	18.7 (530)	17.3 (490)	22.4 (634)	10.6 (300)	14.8 (420)
Reversing Cylinder	Standard	Standard	Standard	Standard	Standard	Standard	Standard
Door Opening Size – in (mm)	22.7 (577)	22.7 (577)	26.9 (683)	26.9 (683)	26.9 (683)	22.6 (574)	26.9 (683)
Air Outlet – in (mm)	6 (152)	8 (200)	8 (200)	8 (200)	8 (200)	1 x 8 (200) Oval	1 x 10 (250) Oval
Motor - HP	Fan	0.5	0.5	0.5	0.5	0.5	0.5
	Cylinder	0.3	0.3	0.5	0.5	0.5	0.3
Airflow – cfm (liters/sec)	500	600	700	700	800	2 x 400	2 x 600
Heat Input Power - Per Pocket – Btu/hr	73,000	90,000	122,000	112,000	165,000	73,000 x 2	95,000 x 2
Gas Connections – in (mm)	0.5	0.5	0.5	0.5	0.5	0.5	0.5
Electrical Specs - amps	(B) 100-120V/50/60/1	10	10	9	12	12	16
	(X) 200-240V/50/60/1/3	6	6	6	7	7	9
Shipping Dimensions Approx. – in (mm)	Width	30.0 (762)	33.0 (838)	41.5 (1054)	35.5 (902)	41.5 (1054)	32.5 (826)
	Depth	49.0 (1245)	49.0 (1245)	50.0 (1270)	57 (1448)	56.0 (1422)	47.0 (1194)
	Height	67.6 (1717)	67.6 (1717)	81.0 (2057)	70.5 (1791)	81.0 (2057)	79.9 (2029)
Net Weight – lb (kg)	320 (145)	340 (155)	660 (299)	430 (195)	690 (313)	570 (260)	710 (320)
Shipping Weight – lb (kg)	340 (155)	360 (165)	710 (322)	470 (215)	740 (336)	600 (270)	750 (340)
Agency Approvals	CSA	CSA	CSA	CSA	CSA	CSA	CSA

Tumble dryer models are made to suit a variety of electrical service characteristics. See your Huebsch distributor for specifications. For further details on installation, refer to Installation, Operation and Maintenance instructions supplied with the tumble dryer. USA and Canada models are certified by CSA International.

For the most accurate information, the installation guide should be used for all design and construction purposes. Due to continuous product improvements, design and specifications subject to change without notice. The quality management systems of Alliance Laundry Systems are registered to ISO 9001.



Vended Single Dryer



At Huebsch®, our priority is making commercial laundry equipment that's perfectly aligned with your business philosophy. In other words, because you believe that profit is the inevitable result of superior efficiency, durability, simplicity and service, that's exactly what we deliver.

FAST DRYING TIMES

Huebsch dryers offer a 7.0 cu. ft. cylinder with an 18 lb capacity offers ample space for large loads to tumble and product fast drying times, while lowering utility consumption.

LARGE, REVERSIBLE DOORS

Our dryers boast the industry's largest door opening at 2.06 sq. ft. Dryer doors also are reversible, making it easy to customize your laundry for your customers' convenience.

SOLID BASE

Huebsch dryers are built on sturdy steel bases to ensure years of worry-free performance.

UNMATCHED DURABILITY

Built with premium materials and tested to meet the demands of the harshest environments, these commercial-grade machines deliver reliable, efficient operation load after load—and they're backed up by Huebsch's standard three-year warranty.



MICRO-DISPLAY CONTROL II

The Micro-Display Control II features a time-remaining countdown, coin countdown and cycle status lights.

Vended **Single Dryer** specifications

Specifications		Front Control	Rear Control
Control Options		MDC II	MDC II Coin Slide
Models	Electric	HDEBXAGS173CW01 HDEBCAGS173TW01 HDEBYAGS173CW01	HDEBCRGS173TW01 HDEBYRGS173TW01 HDEBXRGS153CW01 HDEBYRGS173CW01 HDEBYRGS153CW01
	Gas	HDGBXAGS113CW01 HDGBCAGS113TW01 HDGBYAGS113CW01	HDGBCRGS113TW01 HDGBYRGS113TW01 HDGBXRGS113CW01 HDGBYRGS113CW01
Capacity - lb (kg)		18 (8.2)	18 (8.2)
Cylinder Volume - cu. ft. (liters)		7.0 (198)	7.0 (198)
Width - in (mm)		26.875 (683)	26.875 (683)
Depth - in (mm)		28 (711)	28 (711)
Height - in (mm)		44.375 (1126)	43 (1092)
Motor Size - HP (kw)		0.33 (0.25)	0.33 (0.25)
Available Heat Sources		Electric or Gas	Electric or Gas
Available Heating Element (Electric W)		4750 @ 208V 5350 @ 240V	4750 @ 208V 5350 @ 240V
Gas Inlet Connection - in (mm)		3/8 (9.5)	3/8 (9.5)
Gas Consumption - BTU/Hr		25,000	25,000
Exhaust Outlet Diameter - in (mm)		4 (102)	4 (102)
Exhaust Airflow - cfm (liters/sec)		220 (105)	220 (105)
Available Cycles*		High, Medium, Low, Delicates	High, Medium, Low, Delicates
Cycle Indicator Lights		Yes	Yes
Cylinder Finish		Galvanized	Galvanized
Available Colors		White	White
Door Type (Solid/Window)		Solid	Solid
Available Electrical Requirements - (Voltage/Hz/Ph)		Electric: 120/240/60/1 - 30 Amp Electric: 120/208/60/1 - 30 Amp Gas: 120/60/1 - 15 Amp	Electric: 120/240/60/1 - 30 Amp Electric: 120/208/60/1 - 30 Amp Gas: 120/60/1 - 15 Amp
Shipping Dimensions - in (mm)	Width	29 (737)	29 (737)
	Depth	32.75 (832)	32.75 (832)
	Height	45.5 (1156)	45.5 (1156)
Net Weight - lb (kg)		Elec/Gas 150/155 (68/70)	Elec/Gas 135/140 (61/64)
Shipping Weight - lb (kg)		Elec/Gas 160/165 (73/75)	Elec/Gas 145/150 (66/68)
Available Agency Approvals		Elec: c ^{UL} US, Gas: c ^{CSA} US	Elec: c ^{UL} US, Gas: c ^{CSA} US

* Information shown applies to highest end control available.

Note: Not all options are available for all models.

Refer to the price list for the available models and options.

Front control unit is ADA Compliant.

For the most accurate information, the installation guide should be used for all design and construction purposes. Due to continuous product improvements, design and specifications subject to change without notice. The quality management systems at Alliance Laundry Systems are registered to ISO 9001.

Vended Stack Dryer

At Huebsch®, our priority is making commercial laundry equipment that's perfectly aligned with your business philosophy. In other words, because you believe that profit is the inevitable result of superior efficiency, durability, simplicity and service, that's exactly what we deliver.

FAST DRYING TIMES

Huebsch dryers offer a 7.0 cu. ft. cylinder with an 18 lb capacity offers ample space for large loads to tumble and product fast drying times, while lowering utility consumption.

SOLID BASE

Huebsch dryers are built on sturdy steel bases to ensure years of worry-free performance.

SPACE SAVINGS

A stack dryer gives your vended laundry all the benefits of two stand-alone dryers in a space of one machine. The stack utilizes all the same connections as a standard dryer, so there are no special hookups required.

UNMATCHED DURABILITY

Built with premium materials and tested to meet the demands of the harshest environments, these commercial-grade machines deliver reliable, efficient operation load after load—and they're backed up by Huebsch's standard three-year warranty.

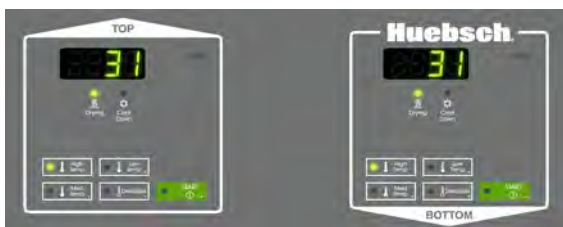

MICRO-DISPLAY CONTROL II

The Micro-Display Control II features a time-remaining countdown, coin countdown and cycle status lights.

Vended **Stack Dryer** specifications

Specifications			
Control Options		MDC II	Coin Slide
Models	Electric	HSEBCAGW173TW01 HSEBYAGW173TW01	HSEXAGW173TW01
	Gas	HSGBCAGW113TW01 HSGBYAGW113TW01	HSGSXAGW113TW01
Capacity - lb (kg)		18 (8.2)	
Cylinder Volume - cu. ft. (liters)		7.0 (198)	
Width - in (mm)		26.875 (683)	
Depth - in (mm)		28 (711)	
Height - in (mm)		78.19 (1986)	
Motor Size - HP (kw)		0.33 (0.25)	
Available Heat Sources		Electric or Gas	
Available Heating Element (Electric W)		4750 @ 208V 5350 @ 240V	
Gas Inlet Connection - in (mm)		3/8 (9.5)	
Gas Consumption - BTU/Hr		25,000	
Exhaust Outlet Diameter - in (mm)		4 (102)	
Exhaust Airflow - cfm (liters/sec)		220 (105)	
Available Cycles*		High, Medium, Low, Delicates	
Cycle Indicator Lights		Yes	
Cylinder Finish		Galvanized	
Available Colors		White	
Door Type (Solid/Window)		Solid or Window	
US Electrical Requirements - (Voltage/Hz/Ph)		Electric: 120/240/60/1 - 30 Amp Electric: 120/208/60/1 - 30 Amp Gas: 120/60/1 - 15 Amp	
Canada Electrical Requirements - Single Supply Cord (Voltage/Hz/Ph)		Electric: 120/240/60/1 - 60 Amp Electric: 120/208/60/1 - 60 Amp Gas: 120/60/1 - 20 Amp	
Shipping Dimensions - in (mm)	Width	29 (737)	
	Depth	32 3/4 (832)	
	Height	80 (2032)	
Net Weight - lb (kg)		Elec/Gas 265/275 (120/125)	
Shipping Weight - lb (kg)		Elec/Gas 280/290 (127/132)	
Available Agency Approvals		Elec: C ^{UL} US, Gas: C ^{CSA} US	

* Information shown applies to highest end control available.

Note: Not all options are available for all models.

Refer to the price list for the available models and options.

Lower unit is ADA Compliant.

For the most accurate information, the installation guide should be used for all design and construction purposes. Due to continuous product improvements, design and specifications subject to change without notice. The quality management systems at Alliance Laundry Systems are registered to ISO 9001.

On-Premises **Front Control** **Stack Washer/Dryer**

Get the complete package in a single unit, combining our efficient dryers with the powerful performance of our industry-leading front load washers. Our line of stack washer/dryers are designed as vertical combinations that provide all of the power of Huebsch washers and dryers, while occupying only half of the floor space of a conventional washer and dryer setup. Plus, these stacked units allow you to use the same connections and hookups required as a standard washer and dryer, so you won't have to make changes to your installation.



Power

Our high spin speed up to 440 G-Force removes more water from clothes, speeding up drying cycles and lowering dryer energy usage.

Smart

Improved suspension with new out-of-balance logic manages and redistributes unbalanced loads for uninterrupted wash cycles.

Efficient

Water use is trimmed to 11.7 gal (44.3L) per cycle to reduce operating costs.



English keypad



Icon keypad

Electronic Control

The Electronic Control keeps users informed throughout the wash process with cycle-status lights and a digital cycle countdown. Users also have the flexibility to control temperature, load type and soil levels, as well as options for prewash and/or additional rinse to achieve high levels of efficiency. Automatic (moisture-sensing) cycles come standard to prevent over-drying of your linens.

On-Premises **Front Control Stack Washer/Dryer** Specifications

SPECIFICATIONS		WASHER	DRYER
Available Controls		Electronic Homestyle	
Models	Electric	YTEE5ASP175TW01, YTEE5ASP285CW01	
	Gas	YTGE5ASP115TW01, YTGE5ASP095CW01	
Capacity - lb (kg)		21.5 (9.5)	18 (8.2)
Cylinder Volume - cu. Ft. (liters)		3.42 (96.8)	7.0 (198)
Width - in (mm)		26.875 (683)	
Depth - in (mm)		27.73 (704)	
Height - in (mm)		78.5 (1994)	
Spin Speed - G-Force (RPM)		440 (1200)	N/A
Motor Size - HP (kw)		Variable Speed Induction 0.9 (0.67)	0.33 (0.25)
Water Consumption per Cycle - g (l)		13.68 (51.8)	N/A
IWF (Water Factor)		4.0	N/A
IMEF (Modified Energy Factor)		2.20	N/A
Available Heat Sources		N/A	Electric or Gas
Available Heating Element (Electric W)		N/A	Can: 5000 @ 240V USA: 5350 @ 240V
Gas Inlet Connection - in (mm)		N/A	3/8 (9.5)
Gas Consumption - BTU/Hr		N/A	22,500
Exhaust Outlet Diameter - in (mm)		N/A	4 (102)
Exhaust Airflow - cfm (liters/sec)		N/A	220 (105)
Available Water Temperatures		3	N/A
Available Cycles		Heavy Duty, Normal Eco, Perm Press, Delicate, Rinse and Spin, Spin Only	Regular, Perm Press, Delicate, Time Dry, Quick Dry, Fluff Up
Water Pressure - PSI (Bar)		20-120 (1.4/8.3)	N/A
Cycle Indicator Lights		Yes	
Cylinder Finish		Stainless Steel	Galvanized
Available Colors		White	
Door Type (Solid/Window)		Window	
USA Electrical Requirements - (Voltage/Hz/Ph-Amp)		120/60/1 - 15	Elec: 208/240/60/1 - 30 Gas: 120/60/1 - 15
Canada Electrical Requirements - Single Supply Cord (Voltage/Hz/Ph-Amp)		Electric: 120/240/60/1 - 40 Gas: 120/60/1 - 20	
Net Weight - lb (kg)		350 (159)	
Shipping Weight - lb (kg)		380 (172)	
Shipping Width - in (mm)		30 (762)	
Shipping Depth - in (mm)		34 (864)	
Shipping Height - in (mm)		80 (2032)	
Available Agency Approvals		cULUS	Elec: ULUS Gas: C ^{UL} SAUS

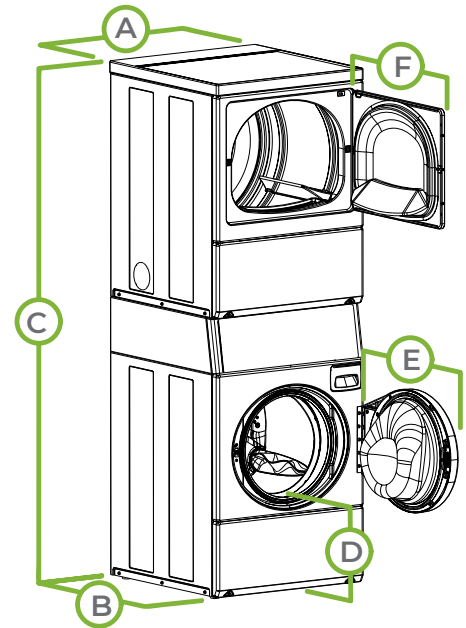

DIMENSIONS

A. Overall Width - in (mm)	26.875 (683)
B. Overall Depth - in (mm)	27.73 (704)
C. Overall Height - in (mm)	78.5 (1994)
D. Door Bottom to Floor - in (mm)	14.5 (368)
E. Washer Door Swing - in (mm)	24 (610)
F. Dryer Door Swing - in (mm)	23.5 (597)

Lower unit is ADA Compliant

Note: Not all options are available for all models. Refer to the price list for the available models and options.

* Information shown applies to highest end control available.

For the most accurate information, the installation guide should be used for all design and construction purposes. Due to continuous product improvements, design and specifications subject to change without notice. The quality management systems at Alliance Laundry Systems are registered to ISO 9001.

On-Premises Rear Control Top Load Washer

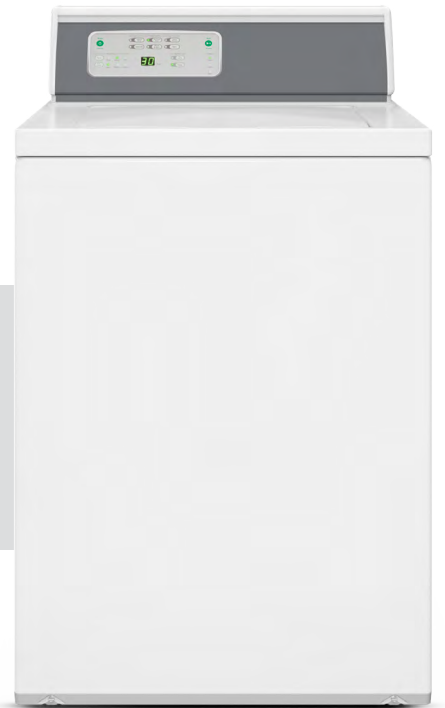

As timeless as they are reliable, Huebsch top load washers are built from the ground up with heavy-duty components guaranteed to stand up to rigorous use. Compliant with U.S. and many international water and energy standards for commercial washers, your laundry will realize savings in water and energy costs.

Durable

The top load washer is designed for durability and ease of use with intuitive controls ready for the heavy-use on-premises laundry environment.

Quality

A commercial-quality, all-metal transmission offers the highest quality and durability, while an advanced suspension system helps manage unbalanced loads.

Flexibility

Multi-cycle controls provide flexible washing options to fit your laundry needs.

Electronic Control

The Electronic Control keeps users informed throughout the wash process with cycle-status lights and a digital cycle countdown. Users also have the flexibility to control temperature, load type and soil levels, as well as options for prewash and/or additional rinse to achieve high levels of efficiency.

E-Mech Control

The E-Mech Control features an intuitive design offering users simple water-temperature and fabric selections, while using cue lights to monitor progress through the wash cycle.

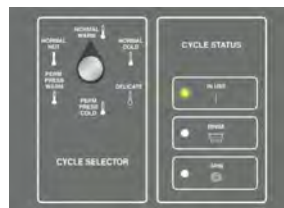

English keypad



Icon keypad

Mechanical Control

The Mechanical Homestyle control provides easy to start activation indicated by "In Use" light.



English & French language

On-Premises Rear Control Top Load Washer Specifications

SPECIFICATIONS

Available Controls	Electronic	E-Mech	Mechanical
Models	YWNE22SP115TW01 YWNE22SP115CW01	HWNMN2SP115TW01 HWNMN2SP115CW01	YWN432SP115CW01
Capacity - lb (kg)	16 (7.3)	16 (7.3)	16 (7.3)
Cylinder Volume - cu. Ft. (liters)	3.19 (90.3)	3.19 (90.3)	3.19 (90.3)
Overall Width - in (mm)	25.63 (651)	25.63 (651)	25.63 (651)
Overall Depth - in (mm)	28 (711)	28 (711)	28 (711)
Overall Height - in (mm)	43 (1092)	43 (1092)	43 (1092)
Spin Speed - G-Force (RPM)	150 (710)	150 (710)	150 (710)
Motor Size - HP (kw)	0.5 (0.37)	0.5 (0.37)	0.5 (0.37)
Water Consumption per Cycle* - g (l)	28.07 (106)	28.07 (106)	28.07 (106)
IWF (Water Factor)	8.8	8.8	8.8
IMEF (Modified Energy Factor)	1.35	1.35	1.35
Available Water Temperatures	3	3	3
Available Cycles	Heavy Duty, Normal Eco, Perm Press, Delicate, Rinse and Spin, Spin Only	Normal Hot, Normal Warm, Normal Cold, Delicate, Perm Press Warm, Perm Press Cold	Soak/Prewash, Heavy Duty/Permanent Press, Normal Eco, Delicate
Water Pressure - PSI (Bar)	20-120 (1.4/8.3)	20-120 (1.4/8.3)	20-120 (1.4/8.3)
Cycle Indicator Lights	Yes	Yes	Yes
Cylinder Finish	Stainless Steel	Stainless Steel	Stainless Steel
Available Colors	White	White	White
Available Electrical Requirements - (Voltage/Hz/Ph)	120/60/1	120/60/1	120/60/1
Shipping Dimensions - in (mm)	Width	28 (711)	28 (711)
	Depth	30 (762)	30 (762)
	Height	45 (1143)	45 (1143)
Net Weight - lb (kg)	186 (84)	186 (84)	186 (84)
Shipping Weight - lb (kg)	196 (89)	196 (89)	196 (89)
Available Agency Approvals	cUL _{US}	cUL _{US}	cUL _{US}

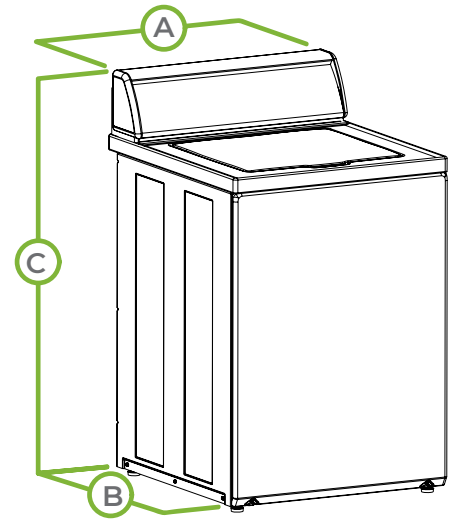

DIMENSIONS

A. Overall Width - in (mm)	25.63 (651)
B. Overall Depth - in (mm)	28 (711)
C. Overall Height - in (mm)	43 (1092)

* Information shown applies to highest end control available.

Note: Not all options are available for all models.

Refer to the price list for the available models and options.

For the most accurate information, the installation guide should be used for all design and construction purposes. Due to continuous product improvements, design and specifications subject to change without notice. The quality management systems at Alliance Laundry Systems are registered to ISO 9001.

On-Premises Rear Control Front Load Washer



Our front load washers use as little as 13.68 gallons (51.8 liters) per cycle, saving 40 percent more than many commercial top load washers. Fast cycle times get the job done quickly, while a large-capacity cylinder provides room for bulky items.

Power

Our high spin speed up to 440 G-Force removes more water from clothes, speeding up drying cycles and lowering dryer energy usage.

Smart

Improved suspension with new out-of-balance logic manages and redistributes unbalanced loads for uninterrupted wash cycles.

Flexibility

A pump drain allows our front load washers to be installed adjacent to, or replace, top load washers with no special plumbing. (A gravity drain option is also available.)

Electronic Control

The Electronic Control keeps users informed throughout the wash process with cycle-status lights and a digital cycle countdown. Users also have the flexibility to control temperature, load type and soil levels, as well as options for prewash and/or additional rinse to achieve high levels of efficiency.



English keypad



Icon keypad

On-Premises Rear Control Front Load Washer Specifications

SPECIFICATIONS

Models	YFNE5RSP115TW01	
Control Option	Electronic Homestyle	
Control Location	Rear	
Capacity - lb (kg)	21.5 (10)	
Cylinder Volume - cu. ft. (liters)	3.42 (96.8)	
Overall Width - in (mm)	26.875 (683)	
Overall Depth - in (mm)	27.73 (704)	
Overall Height - in (mm)	43 (1092)	
Spin Speed G-Force -RPM	440 (1200)	
Motor Power Consumption - hp (kw) Variable Speed Induction	0.9 (0.67)	
Water Consumption Per Cycle -g (l)	13.68 (51.8)	
IWF (Water Factor)	4.0 (0.53)	
IMEF (Modified Energy Factor)	2.20 (62.3)	
Available Water Temperatures	3	
*Available Cycles	Heavy Duty, Normal Eco, Perm Press, Delicate, Rinse & Spin, Spin Only	
Water Pressure -PSI (Bar)	20-120 (1.4/8.3)	
Cycle Indicator Lights	Yes	
Cylinder Finish	Stainless Steel	
Available Colors	White	
Door Type (Solid/Window)	Window	
Available Electrical Requirements - Voltage/Hz/Ph - Circuit Amperage	120/60/1 - 15	
Shipping Dimensions Approx. - in (mm)	Width	30 (762)
	Depth	34 (864)
	Height	44.5 (1130)
Net Weight - lb (kg)	260 (118)	
Shipping Weight - lb (kg)	270 (122)	
Agency Approvals	cULus	

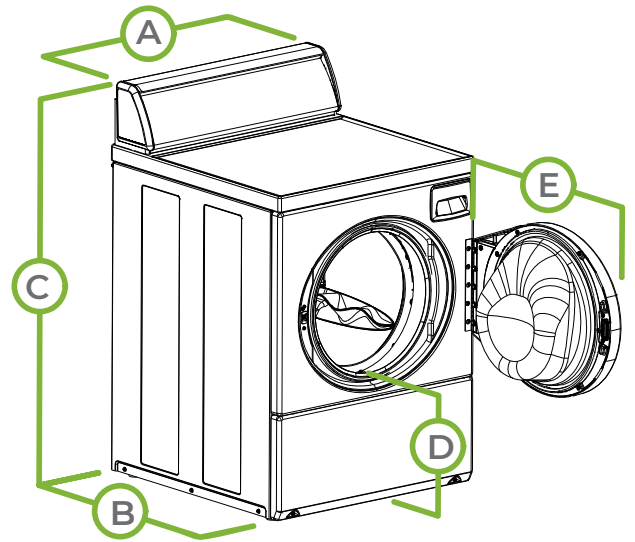

DIMENSIONS

A.	Overall Width - in (mm)	26.875 (683)
B.	Overall Depth - in (mm)	27.73 (704)
C.	Overall Height - in (mm)	43 (1092)
D.	Door Bottom To Floor - in (mm)	14.6 (371)
E.	Door Swing - in (mm)	24.06 (611)

* Information shown applies to highest end control available.

Note: Not all options are available for all models.

Refer to the price list for the available models and options.

For the most accurate information, the installation guide should be used for all design and construction purposes. Due to continuous product improvements, design and specifications subject to change without notice. The quality management systems at Alliance Laundry Systems are registered to ISO 9001.

On-Premises 30-lb Tumble Dryer



Our single-pocket tumble dryers* feature concentrated airflow and sealed cylinder rims to ensure energy savings. This superior drying performance helps laundries maximize throughput to meet the daily workload every time. Our tumble dryers are designed with fewer moving parts, so you'll face less maintenance and wear and tear.

Efficient

High-performance heater box increases energy efficiency and reduces drying times to help on-premises laundries increase throughput, while decreasing operating costs.

Performance

Available in 30 lb, 35 lb, 50 lb, 55 lb, 75 lb, 120 lb, 170 lb and 200 lb capacities, there's a tumble dryer to meet the needs of any on-premises laundry.



Galaxy™

The Galaxy Control offers the flexibility of 30 programmable cycles combined with the accuracy of our moisture-sensing technology saving time and energy increasing the life of your linens, saving time and energy.



Dual Digital

With features including one-touch cycle repeat, automatic extended tumble and a large digital countdown display, it's simple to set your drying time, temperature and cool down with the Dual Digital Control.

* Not all models are available in all markets. In order to highlight key details, machine images do not adhere to a standard scale.

On-Premises 30-lb Tumble Dryer Specifications

MODEL		HT030	
CONTROL OPTION		Galaxy, Dual Digital	
CAPACITY - lb (kg)		30 (13)	
OVERALL WIDTH - in (mm)		27.9 (710)	
OVERALL DEPTH - in (mm)		45.5 (1155)	
OVERALL HEIGHT - in (mm)		63.9 (1625)	
CYLINDER DIAMETER - in (mm)		26.5 (673)	
CYLINDER DEPTH - in (mm)		30.0 (762)	
CYLINDER VOLUME - cu. ft. (liters)		9.6 (270)	
REVERSING CYLINDER		Option	
DOOR OPENING SIZE - in (mm)		22.7 (577)	
HEAT INPUT POWER	Gas Models - Per Pocket	73,000 Btu/hr	
	Electric Models	21kW	
GAS CONNECTIONS* - in (npt)		0.5	
AIR OUTLET - in (mm)		6 (152)	
MOTOR - hp	Fan	0.5	
	Cylinder	0.3	
AIRFLOW - cfm		500	
ELECTRICAL SPECS - amps	Gas		
	B	100-120V/50/60/1	10
	X	200-240V/50/60/1/3	6
	N	440-480V/50/60/3	3
	Electric		
	D	200-208V/50/60/1	104
	E	230-240V/50/60/1	90
	F	200-208V/50/60/3	61
	G	230-240V/50/60/3	52
	K	440V/50/60/3	29
L	460-480V/50/60/3	27	
SHIPPING DIMENSIONS APPROX. - in (mm)	Width	30.0 (762)	
	Depth	49.0 (1245)	
	Height	67.6 (1717)	
NET WEIGHT - lb (kg)	Gas	320 (145)	
	Electric	330 (150)	
SHIPPING WEIGHT - lb (kg)	Gas	340 (155)	
	Electric	350 (160)	
AGENCY APPROVALS		CSA	

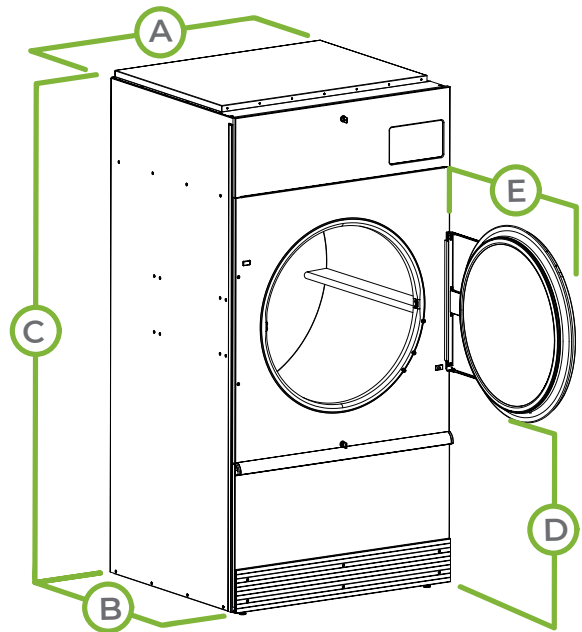

MODEL	HT030	
A.	OVERALL WIDTH - in (mm)	27.9 (710)
B.	OVERALL DEPTH - in (mm)	45.5 (1155)
C.	OVERALL HEIGHT - in (mm)	63.9 (1625)
D.	DOOR BOTTOM TO FLOOR - in (mm)	27.5 (700)
E.	DOOR SWING - in (mm)	26.3 (670)

* LP gas available for 50,75 lb capacities only. Field conversion kits available for other capacities.

Tumble dryer models are made to suit a variety of electrical service characteristics. See your Huebsch distributor for specifications. For further details on installation, refer to Installation, Operation and Maintenance instructions supplied with the tumble dryer. Amperage ratings available in Installation Manual.

For the most accurate information, the installation guide should be used for all design and construction purposes. Due to continuous product improvements, design and specifications subject to change without notice. The quality management systems at Alliance Laundry Systems are registered to ISO 9001.

On-Premises 35-lb Tumble Dryer



Our single-pocket tumble dryers* feature concentrated airflow and sealed cylinder rims to ensure energy savings. This superior drying performance helps laundries maximize throughput to meet the daily workload every time. Our tumble dryers are designed with fewer moving parts, so you'll face less maintenance and wear and tear.

Efficient

High-performance heater box increases energy efficiency and reduces drying times to help on-premises laundries increase throughput, while decreasing operating costs.

Performance

Available in 30 lb, 35 lb, 50 lb, 55 lb, 75 lb, 120 lb, 170 lb and 200 lb capacities, there's a tumble dryer to meet the needs of any on-premises laundry.



Galaxy™

The Galaxy Control offers the flexibility of 30 programmable cycles combined with the accuracy of our moisture-sensing technology saving time and energy increasing the life of your linens, saving time and energy.



Dual Digital

With features including one-touch cycle repeat, automatic extended tumble and a large digital countdown display, it's simple to set your drying time, temperature and cool down with the Dual Digital Control.

* Not all models are available in all markets. In order to highlight key details, machine images do not adhere to a standard scale.

On-Premises **35-lb Tumble Dryer** Specifications

MODEL		HT035	
CONTROL OPTION		Galaxy, Dual Digital	
CAPACITY - lb (kg)		35 (16)	
OVERALL WIDTH - in (mm)		31.5 (800)	
OVERALL DEPTH - in (mm)		45.5 (1155)	
OVERALL HEIGHT - in (mm)		63.9 (1625)	
CYLINDER DIAMETER - in (mm)		30 (762)	
CYLINDER DEPTH - in (mm)		30.0 (762)	
CYLINDER VOLUME - cu. ft. (liters)		12.3 (350)	
REVERSING CYLINDER		Option	
DOOR OPENING SIZE - in (mm)		22.7 (577)	
HEAT INPUT POWER	Gas Models - Per Pocket	90,000 Btu/hr	
	Electric Models	24kW	
GAS CONNECTIONS* - in (npt)		0.5	
AIR OUTLET - in (mm)		8 (200)	
MOTOR - hp	Fan	0.5	
	Cylinder	0.3	
AIRFLOW - cfm		600	
ELECTRICAL SPECS - amps	Gas		
	B	100-120V/50/60/1	10
	X	200-240V/50/60/1/3	6
	N	440-480V/50/60/3	3
	Electric		
	D	200-208V/50/60/1	118
	E	230-240V/50/60/1	102
	F	200-208V/50/60/3	69
	G	230-240V/50/60/3	59
	K	440V/50/60/3	32
L	460-480V/50/60/3	30	
SHIPPING DIMENSIONS APPROX. - in (mm)	Width	33.0 (838)	
	Depth	49.0 (1245)	
	Height	67.6 (1717)	
NET WEIGHT - lb (kg)	Gas	340 (155)	
	Electric	350 (160)	
SHIPPING WEIGHT - lb (kg)	Gas	360 (165)	
	Electric	370 (170)	
AGENCY APPROVALS		CSA	

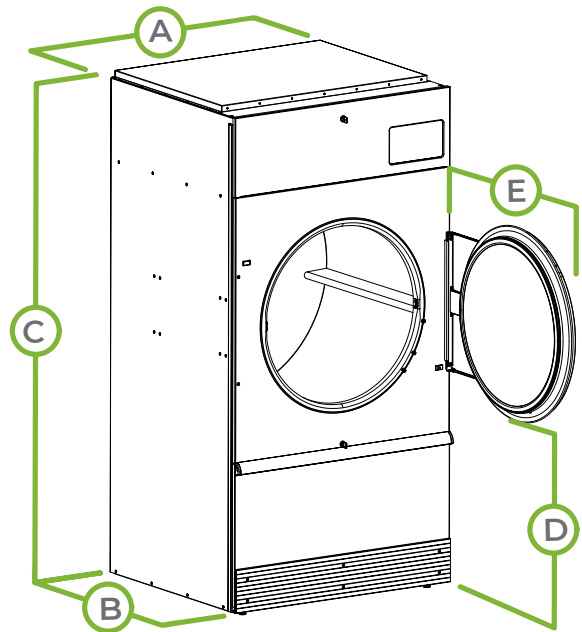

MODEL	HT035
A. OVERALL WIDTH - in (mm)	31.5 (800)
B. OVERALL DEPTH - in (mm)	45.5 (1155)
C. OVERALL HEIGHT - in (mm)	63.9 (1625)
D. DOOR BOTTOM TO FLOOR - in (mm)	27.5 (700)
E. DOOR SWING - in (mm)	28 (710)

* LP gas available for 50,75 lb capacities only. Field conversion kits available for other capacities.

Tumble dryer models are made to suit a variety of electrical service characteristics. See your Huebsch distributor for specifications. For further details on installation, refer to Installation, Operation and Maintenance instructions supplied with the tumble dryer. Amperage ratings available in Installation Manual.

For the most accurate information, the installation guide should be used for all design and construction purposes. Due to continuous product improvements, design and specifications subject to change without notice. The quality management systems at Alliance Laundry Systems are registered to ISO 9001.

On-Premises 50-lb Tumble Dryer



Our single-pocket tumble dryers* feature concentrated airflow and sealed cylinder rims to ensure energy savings. This superior drying performance helps laundries maximize throughput to meet the daily workload every time. Our tumble dryers are designed with fewer moving parts, so you'll face less maintenance and wear and tear.

Efficient

High-performance heater box increases energy efficiency and reduces drying times to help on-premises laundries increase throughput, while decreasing operating costs.

Performance

Available in 30 lb, 35 lb, 50 lb, 55 lb, 75 lb, 120 lb, 170 lb and 200 lb capacities, there's a tumble dryer to meet the needs of any on-premises laundry.



Galaxy™

The Galaxy Control offers the flexibility of 30 programmable cycles combined with the accuracy of our moisture-sensing technology saving time and energy increasing the life of your linens, saving time and energy.



Dual Digital

With features including one-touch cycle repeat, automatic extended tumble and a large digital countdown display, it's simple to set your drying time, temperature and cool down with the Dual Digital Control.

* Not all models are available in all markets. In order to highlight key details, machine images do not adhere to a standard scale.

On-Premises 50-lb Tumble Dryer Specifications

MODEL		HT050	
CONTROL OPTION		Galaxy, Dual Digital	
CAPACITY - lb (kg)		50 (25)	
OVERALL WIDTH - in (mm)		38.5 (980)	
OVERALL DEPTH - in (mm)		46.8 (1190)	
OVERALL HEIGHT - in (mm)		77.3 (1960)	
CYLINDER DIAMETER - in (mm)		37.0 (940)	
CYLINDER DEPTH - in (mm)		30.0 (762)	
CYLINDER VOLUME - cu. ft. (liters)		18.7 (530)	
DOOR OPENING SIZE - in (mm)		26.9 (683)	
HEAT INPUT POWER	Gas Models - Per Pocket	130,000 Btu/hr	
	Steam Models - Per Pocket	113,600 Btu/hr	
	Electric Models	30kW	
GAS CONNECTIONS* - in (npt)		0.5	
PLUMBING CONNECTIONS - STEAM - in (npt)		0.75	
AIR OUTLET - in (mm)		8 (200)	
MOTOR -hp	Fan	0.5	
	Cylinder	0.5	
AIRFLOW - cfm		700	
ELECTRICAL SPECS - amps	Gas & Steam		
	B	100-120V/50/60/1	9
	X	200-240V/50/60/1/3	6
	N	440-480V/50/60/3	3
	Electric		
	E	230-240V/50/60/1	91
	F	200-208V/50/60/3	87
	G	230-240V/50/60/3	75
	K	440V/50/60/3	41
	L	460-480V/50/60/3	38
SHIPPING DIMENSIONS APPROX. - in (mm)	Width	41.5 (1054)	
	Depth	50.0 (1270)	
	Height	Gas & Electric - 81.0 (2057) Steam - 83.5 (2121)	
NET WEIGHT - lb (kg)	Gas	660 (299)	
	Electric	690 (313)	
	Steam	680 (308)	
SHIPPING WEIGHT - lb (kg)	Gas	710 (322)	
	Electric	740 (336)	
	Steam	730 (331)	
AGENCY APPROVALS		CSA	

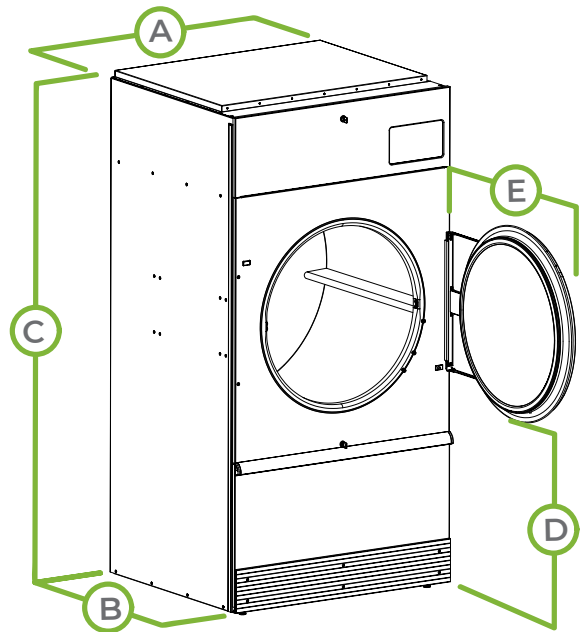

MODEL	HT050
A. OVERALL WIDTH - in (mm)	38.5 (980)
B. OVERALL DEPTH - in (mm)	46.8 (1190)
C. OVERALL HEIGHT - in (mm)	77.3 (1960)
D. DOOR BOTTOM TO FLOOR - in (mm)	29.2 (740)
E. DOOR SWING - in (mm)	33.9 (860)

* LP gas available for 50,75 lb capacities only. Field conversion kits available for other capacities.

Tumble dryer models are made to suit a variety of electrical service characteristics. See your Huebsch distributor for specifications. For further details on installation, refer to Installation, Operation and Maintenance instructions supplied with the tumble dryer. Amperage ratings available in Installation Manual.

For the most accurate information, the installation guide should be used for all design and construction purposes. Due to continuous product improvements, design and specifications subject to change without notice. The quality management systems at Alliance Laundry Systems are registered to ISO 9001.

On-Premises 55-lb Tumble Dryer



Our single-pocket tumble dryers* feature concentrated airflow and sealed cylinder rims to ensure energy savings. This superior drying performance helps laundries maximize throughput to meet the daily workload every time. Our tumble dryers are designed with fewer moving parts, so you'll face less maintenance and wear and tear.

Efficient

High-performance heater box increases energy efficiency and reduces drying times to help on-premises laundries increase throughput, while decreasing operating costs.

Spacesaver

The 55 lb (24.9 kg) capacity model fits through a 36 in (914 mm) door opening and is 10 in (251 mm) shorter than our 50 lb (22.7 kg) unit, making it an option for laundries with limited space.

Performance

Available in 30 lb, 35 lb, 50 lb, 55 lb, 75 lb, 120 lb, 170 lb and 200 lb capacities, there's a tumble dryer to meet the needs of any on-premises laundry.



Galaxy™

The Galaxy Control offers the flexibility of 30 programmable cycles combined with the accuracy of our moisture-sensing technology saving time and energy increasing the life of your linens, saving time and energy.



Dual Digital

With features including one-touch cycle repeat, automatic extended tumble and a large digital countdown display, it's simple to set your drying time, temperature and cool down with the Dual Digital Control.

* Not all models are available in all markets. In order to highlight key details, machine images do not adhere to a standard scale.

On-Premises **55-lb Tumble Dryer** Specifications

MODEL		HT055	
CONTROL OPTION		Galaxy, Dual Digital	
CAPACITY - lb (kg)		55 (24)	
OVERALL WIDTH - in (mm)		34.5 (876)	
OVERALL DEPTH - in (mm)		53.1 (1350)	
OVERALL HEIGHT - in (mm)		66.7 (1700)	
CYLINDER DIAMETER - in (mm)		33 (838)	
CYLINDER DEPTH - in (mm)		35.0 (889)	
CYLINDER VOLUME - cu. ft. (liters)		17.3 (490)	
REVERSING CYLINDER		Option	
DOOR OPENING SIZE - in (mm)		26.9 (683)	
HEAT INPUT POWER	Gas Models - Per Pocket	112,000 Btu/hr	
	Electric Models	27kW	
GAS CONNECTIONS* - in (npt)		0.5	
AIR OUTLET - in (mm)		8 (200)	
MOTOR - hp	Fan	0.5	
	Cylinder	0.5	
AIRFLOW - cfm		700	
ELECTRICAL SPECS - amps	Gas		
	B	100-120V/50/60/1	12
	X	200-240V/50/60/1/3	7
	N	440-480V/50/60/3	3
	Electric		
	D	200-208V/50/60/1	133
	E	230-240V/50/60/1	116
	F	200-208V/50/60/3	78
	G	230-240V/50/60/3	67
	K	440V/50/60/3	37
L	460-480V/50/60/3	34	
SHIPPING DIMENSIONS APPROX. - in (mm)	Width	35.5 (902)	
	Depth	57 (1448)	
	Height	70.5 (1791)	
NET WEIGHT - lb (kg)	Gas	430 (195)	
	Electric	440 (200)	
SHIPPING WEIGHT - lb (kg)	Gas	470 (215)	
	Electric	480 (220)	
AGENCY APPROVALS		CSA	

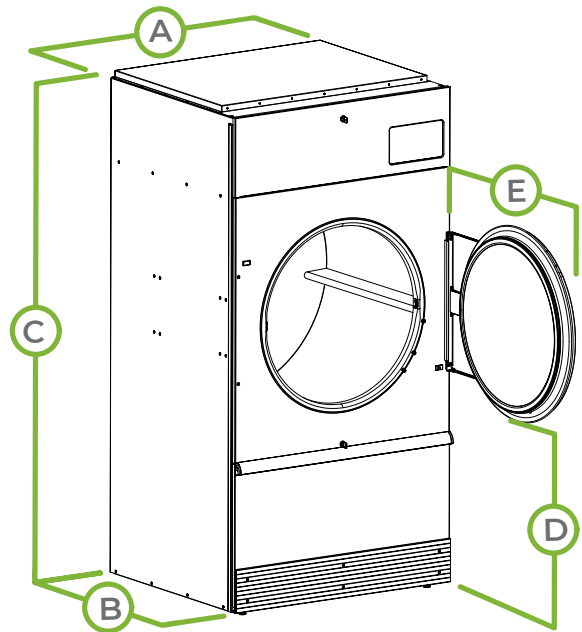

MODEL	HT055
A. OVERALL WIDTH - in (mm)	34.5 (876)
B. OVERALL DEPTH - in (mm)	53.1 (1350)
C. OVERALL HEIGHT - in (mm)	66.7 (1700)
D. DOOR BOTTOM TO FLOOR - in (mm)	26.9 (680)
E. DOOR SWING - in (mm)	31.9 (810)

* LP gas available for 50,75 lb capacities only. Field conversion kits available for other capacities.

Tumble dryer models are made to suit a variety of electrical service characteristics. See your Huebsch distributor for specifications. For further details on installation, refer to Installation, Operation and Maintenance instructions supplied with the tumble dryer. Amperage ratings available in Installation Manual.

For the most accurate information, the installation guide should be used for all design and construction purposes. Due to continuous product improvements, design and specifications subject to change without notice. The quality management systems at Alliance Laundry Systems are registered to ISO 9001.

On-Premises 75-lb Tumble Dryer



Our single-pocket tumble dryers* feature concentrated airflow and sealed cylinder rims to ensure energy savings. This superior drying performance helps laundries maximize throughput to meet the daily workload every time. Our tumble dryers are designed with fewer moving parts, so you'll face less maintenance and wear and tear.

Efficient

High-performance heater box increases energy efficiency and reduces drying times to help on-premises laundries increase throughput, while decreasing operating costs.

Performance

Available in 30 lb, 35 lb, 50 lb, 55 lb, 75 lb, 120 lb, 170 lb and 200 lb capacities, there's a tumble dryer to meet the needs of any on-premises laundry.



Galaxy™

The Galaxy Control offers the flexibility of 30 programmable cycles combined with the accuracy of our moisture-sensing technology saving time and energy increasing the life of your linens, saving time and energy.



Dual Digital

With features including one-touch cycle repeat, automatic extended tumble and a large digital countdown display, it's simple to set your drying time, temperature and cool down with the Dual Digital Control.

* Not all models are available in all markets. In order to highlight key details, machine images do not adhere to a standard scale.

On-Premises **75-lb Tumble Dryer** Specifications

MODEL		HT075	
CONTROL OPTION		Galaxy, Dual Digital	
CAPACITY - lb (kg)		75 (34)	
OVERALL WIDTH - in (mm)		38.5 (980)	
OVERALL DEPTH - in (mm)		53.0 (1350)	
OVERALL HEIGHT - in (mm)		77.3 (1960)	
CYLINDER DIAMETER - in (mm)		37.0 (940)	
CYLINDER DEPTH - in (mm)		36.0 (914)	
CYLINDER VOLUME - cu. ft. (liters)		22.4 (634)	
DOOR OPENING SIZE - in (mm)		26.9 (683)	
HEAT INPUT POWER	Gas Models - Per Pocket	165,000 Btu/hr	
	Steam Models - Per Pocket	113,900 Btu/hr	
	Electric Models	36kW	
GAS CONNECTIONS* - in (npt)		0.5	
PLUMBING CONNECTIONS - STEAM - in (npt)		0.75	
AIR OUTLET - in (mm)		8 (200)	
MOTOR -hp	Fan	0.5	
	Cylinder	0.5	
AIRFLOW - cfm		800	
ELECTRICAL SPECS - amps	Gas & Steam		
	B	100-120V/50/60/1	12
	X	200-240V/50/60/1/3	7
	N	440-480V/50/60/3	3
	Electric		
	F	200-208V/50/60/3	104
	G	230-240V/50/60/3	90
	K	440V/50/60/3	49
	L	460-480V/50/60/3	45
SHIPPING DIMENSIONS APPROX. - in (mm)	Width	41.5 (1054)	
	Depth	56.0 (1422)	
	Height	Gas & Electric - 81.0 (2057) Steam - 83.5 (2121)	
NET WEIGHT - lb (kg)	Gas	690 (313)	
	Electric	710 (322)	
	Steam	720 (327)	
SHIPPING WEIGHT - lb (kg)	Gas	740 (336)	
	Electric	760 (345)	
	Steam	770 (349)	
AGENCY APPROVALS		CSA	

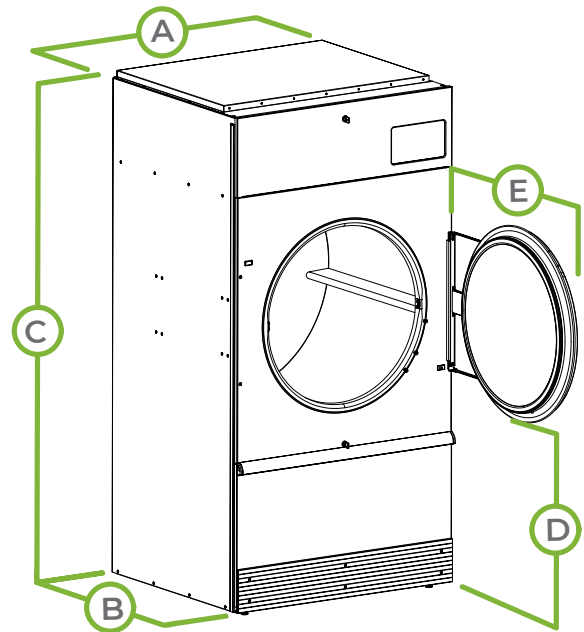

MODEL	HT075
A. OVERALL WIDTH - in (mm)	38.5 (980)
B. OVERALL DEPTH - in (mm)	53.0 (1350)
C. OVERALL HEIGHT - in (mm)	77.3 (1960)
D. DOOR BOTTOM TO FLOOR - in (mm)	29.2 (740)
E. DOOR SWING - in (mm)	33.9 (860)

* LP gas available for 50,75 lb capacities only. Field conversion kits available for other capacities.

Tumble dryer models are made to suit a variety of electrical service characteristics. See your Huebsch distributor for specifications. For further details on installation, refer to Installation, Operation and Maintenance instructions supplied with the tumble dryer. Amperage ratings available in Installation Manual.

For the most accurate information, the installation guide should be used for all design and construction purposes. Due to continuous product improvements, design and specifications subject to change without notice. The quality management systems at Alliance Laundry Systems are registered to ISO 9001.

On-Premises 120-lb Tumble Dryer



Our single-pocket tumble dryers* feature concentrated airflow and sealed cylinder rims to ensure energy savings. This superior drying performance helps laundries maximize throughput to meet the daily workload every time. Our tumble dryers are designed with fewer moving parts, so you'll face less maintenance and wear and tear.

Efficient

High-performance heater box increases energy efficiency and reduces drying times to help on-premises laundries increase throughput, while decreasing operating costs.

Performance

Available in 30 lb, 35 lb, 50 lb, 55 lb, 75 lb, 120 lb, 170 lb and 200 lb capacities, there's a tumble dryer to meet the needs of any on-premises laundry.



Galaxy™

The Galaxy Control offers the flexibility of 30 programmable cycles combined with the accuracy of our moisture-sensing technology saving time and energy increasing the life of your linens, saving time and energy.

* Not all models are available in all markets. In order to highlight key details, machine images do not adhere to a standard scale.

On-Premises 120-lb Tumble Dryer Specifications

MODEL		HT120	
CONTROL OPTION		Galaxy	
CAPACITY - lb (kg)		120 (54)	
OVERALL WIDTH - in (mm)		46.1 (1170)	
OVERALL DEPTH - in (mm)		67.9 (1725)	
OVERALL HEIGHT - in (mm)		85.7 (2175)	
CYLINDER DIAMETER - in (mm)		44 (1120)	
CYLINDER DEPTH - in (mm)		41 (1040)	
CYLINDER VOLUME - cu. ft. (liters)		36.1 (1020)	
DOOR OPENING SIZE - in (mm)		26.9 (683)	
ENERGY DATA	Gas Models - Per Pocket	270,000 Btu/hr	
	Steam Models - Per Pocket	187,560 Btu/hr	
	Electric Models	60kW	
GAS CONNECTIONS* - in (npt)		1	
PLUMBING CONNECTIONS - STEAM - in (npt)	Inlet	0.75	
	Outlet	0.75	
AIR OUTLET - in (mm)		10 (254)	
MOTOR -hp	Fan	1.5	
	Cylinder	1.5	
AIRFLOW - cfm		1400	
ELECTRICAL SPECS - amps	Gas & Steam		
	Q	200-240V/50/60/3	7
	N	440-480V/50/60/3	4
	Electric		
	G	230-240V/50/60/3	147
	K	440V/50/60/3	82
	L	460-480V/50/60/3	75
SHIPPING DIMENSIONS APPROX. - in (mm)	Width	48 (1220)	
	Depth	71.5 (1820)	
	Height	90 (2290)	
NET WEIGHT - lb (kg)	Gas	1220 (555)	
	Electric	1250 (575)	
	Steam	1330 (605)	
SHIPPING WEIGHT - lb (kg)	Gas	1290 (585)	
	Electric	1320 (600)	
	Steam	1400 (635)	
AGENCY APPROVALS		CSA	

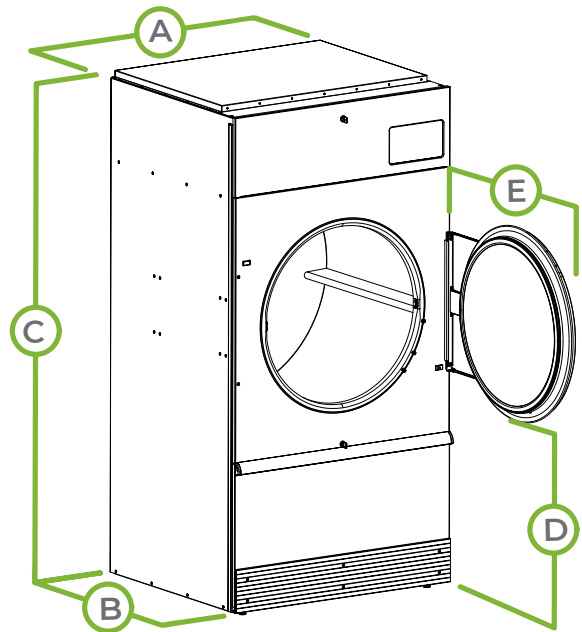

MODEL	HT120	
A.	OVERALL WIDTH - in (mm)	46.1 (1170)
B.	OVERALL DEPTH - in (mm)	67.9 (1725)
C.	OVERALL HEIGHT - in (mm)	85.7 (2175)
D.	DOOR BOTTOM TO FLOOR - in (mm)	31.4 (800)
E.	DOOR SWING - in (mm)	32.5 (825)

* LP gas available for 50,75 lb capacities only. Field conversion kits available for other capacities.

Tumble dryer models are made to suit a variety of electrical service characteristics. See your Huebsch distributor for specifications. For further details on installation, refer to Installation, Operation and Maintenance instructions supplied with the tumble dryer. Amperage ratings available in Installation Manual.

For the most accurate information, the installation guide should be used for all design and construction purposes. Due to continuous product improvements, design and specifications subject to change without notice. The quality management systems at Alliance Laundry Systems are registered to ISO 9001.

On-Premises 170-lb Tumble Dryer



Our single-pocket tumble dryers* feature concentrated airflow and sealed cylinder rims to ensure energy savings. This superior drying performance helps laundries maximize throughput to meet the daily workload every time. Our tumble dryers are designed with fewer moving parts, so you'll face less maintenance and wear and tear.

Efficient

High-performance heater box increases energy efficiency and reduces drying times to help on-premises laundries increase throughput, while decreasing operating costs.

Performance

Available in 30 lb, 35 lb, 50 lb, 55 lb, 75 lb, 120 lb, 170 lb and 200 lb capacities, there's a tumble dryer to meet the needs of any on-premises laundry.



Galaxy™

The Galaxy Control offers the flexibility of 30 programmable cycles combined with the accuracy of our moisture-sensing technology saving time and energy increasing the life of your linens, saving time and energy.

* Not all models are available in all markets. In order to highlight key details, machine images do not adhere to a standard scale.

On-Premises **170-lb Tumble Dryer** Specifications

MODEL		HT170	
CONTROL OPTION		Galaxy	
CAPACITY - lb (kg)		170 (77)	
OVERALL WIDTH - in (mm)		52.9 (1345)	
OVERALL DEPTH - in (mm)		69.8 (1772)	
OVERALL HEIGHT - in (mm)		94 (2390)	
CYLINDER DIAMETER - in (mm)		50.8 (1290)	
CYLINDER DEPTH - in (mm)		42.5 (1080)	
CYLINDER VOLUME - cu. ft. (liters)		49.8 (1410)	
DOOR OPENING SIZE - in (mm)		26.9 (683)	
ENERGY DATA	Gas Models - Per Pocket	395,000 Btu/hr	
	Steam Models - Per Pocket	265,563 Btu/hr	
GAS CONNECTIONS* - in (npt)		1	
PLUMBING CONNECTIONS - STEAM - in (npt)	Inlet	0.75	
	Outlet	1	
AIR OUTLET - in (mm)		12 (305)	
MOTOR -hp	Fan	1.5	
	Cylinder	1.5	
AIRFLOW - cfm		2150	
ELECTRICAL SPECS - amps	Gas & Steam		
	Q	200-240V50/60/3	11
	N	440-480V/50/60/3	6
SHIPPING DIMENSIONS APPROX. - in (mm)	Width	52.1 (1320)	
	Depth	73.8 (1870)	
	Height	99 (2510)	
NET WEIGHT - lb (kg)	Gas	1400 (635)	
	Steam	1550 (705)	
SHIPPING WEIGHT - lb (kg)	Gas	1480 (670)	
	Steam	1630 (740)	
AGENCY APPROVALS		CSA	

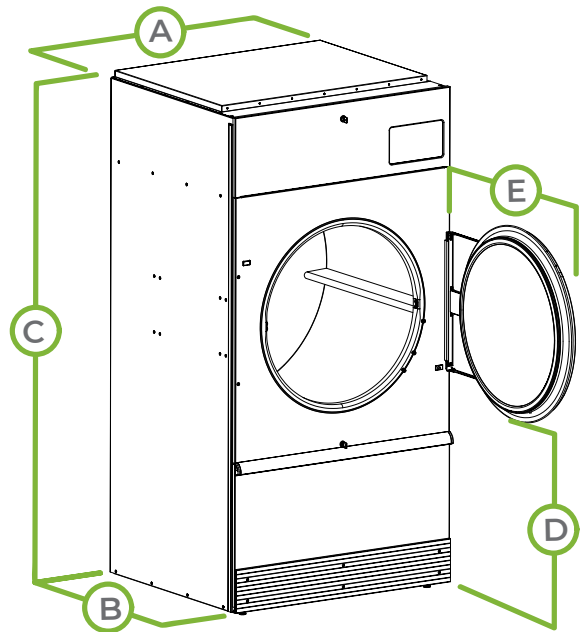

MODEL	HT170	
A.	OVERALL WIDTH - in (mm)	52.9 (1345)
B.	OVERALL DEPTH - in (mm)	69.8 (1772)
C.	OVERALL HEIGHT - in (mm)	94 (2390)
D.	DOOR BOTTOM TO FLOOR - in (mm)	33.9 (860)
E.	DOOR SWING - in (mm)	32.5 (825)

* LP gas available for 50,75 lb capacities only. Field conversion kits available for other capacities.

Tumble dryer models are made to suit a variety of electrical service characteristics. See your Huebsch distributor for specifications. For further details on installation, refer to Installation, Operation and Maintenance instructions supplied with the tumble dryer. Amperage ratings available in Installation Manual.

For the most accurate information, the installation guide should be used for all design and construction purposes. Due to continuous product improvements, design and specifications subject to change without notice. The quality management systems at Alliance Laundry Systems are registered to ISO 9001.

On-Premises 200-lb Tumble Dryer



Our single-pocket tumble dryers* feature concentrated airflow and sealed cylinder rims to ensure energy savings. This superior drying performance helps laundries maximize throughput to meet the daily workload every time. Our tumble dryers are designed with fewer moving parts, so you'll face less maintenance and wear and tear.

Efficient

High-performance heater box increases energy efficiency and reduces drying times to help on-premises laundries increase throughput, while decreasing operating costs.

Performance

Available in 30 lb, 35 lb, 50 lb, 55 lb, 75 lb, 120 lb, 170 lb and 200 lb capacities, there's a tumble dryer to meet the needs of any on-premises laundry.



Galaxy™

The Galaxy Control offers the flexibility of 30 programmable cycles combined with the accuracy of our moisture-sensing technology saving time and energy increasing the life of your linens, saving time and energy.

* Not all models are available in all markets. In order to highlight key details, machine images do not adhere to a standard scale.

On-Premises 200-lb Tumble Dryer Specifications

MODEL		HT200	
CONTROL OPTION		Galaxy	
CAPACITY - lb (kg)		200 (91)	
OVERALL WIDTH - in (mm)		52.9 (1345)	
OVERALL DEPTH - in (mm)		77.3 (1965)	
OVERALL HEIGHT - in (mm)		94 (2390)	
CYLINDER DIAMETER - in (mm)		50.8 (1290)	
CYLINDER DEPTH - in (mm)		50 (1270)	
CYLINDER VOLUME - cu. ft. (liters)		58.6 (1660)	
DOOR OPENING SIZE - in (mm)		26.9 (683)	
ENERGY DATA	Gas Models - Per Pocket	425,000 Btu/hr	
	Steam Models - Per Pocket	265,564 Btu/hr	
GAS CONNECTIONS* - in (npt)		1	
PLUMBING CONNECTIONS - STEAM - in (npt)	Inlet	0.75	
	Outlet	1	
AIR OUTLET - in (mm)		12 (305)	
MOTOR -hp	Fan	3	
	Cylinder	0.75	
AIRFLOW - cfm		2150	
ELECTRICAL SPECS - amps	Gas & Steam		
	Q	200-240V/50/60/3	12
	N	440-480V/50/60/3	6
SHIPPING DIMENSIONS APPROX. - in (mm)	Width	52.1 (1320)	
	Depth	81.3 (2070)	
	Height	99 (2510)	
NET WEIGHT - lb (kg)	Gas	1550 (705)	
	Steam	1700 (770)	
SHIPPING WEIGHT - lb (kg)	Gas	1630 (740)	
	Steam	1780 (805)	
AGENCY APPROVALS		CSA	

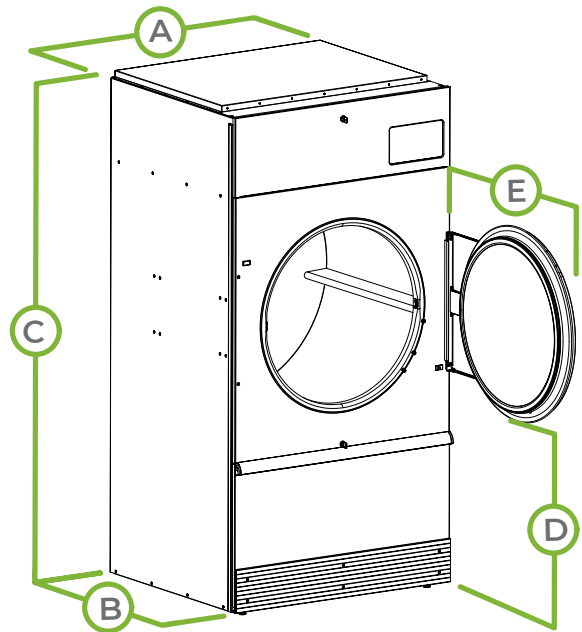

MODEL	HT200
A. OVERALL WIDTH - in (mm)	52.9 (1345)
B. OVERALL DEPTH - in (mm)	77.3 (1965)
C. OVERALL HEIGHT - in (mm)	94 (2390)
D. DOOR BOTTOM TO FLOOR - in (mm)	32.1 (815)
E. DOOR SWING - in (mm)	34 (865)

* LP gas available for 50,75 lb capacities only. Field conversion kits available for other capacities.

Tumble dryer models are made to suit a variety of electrical service characteristics. See your Huebsch distributor for specifications. For further details on installation, refer to Installation, Operation and Maintenance instructions supplied with the tumble dryer. Amperage ratings available in Installation Manual.

For the most accurate information, the installation guide should be used for all design and construction purposes. Due to continuous product improvements, design and specifications subject to change without notice. The quality management systems at Alliance Laundry Systems are registered to ISO 9001.

On-Premises 30-lb Stack Tumble Dryer



Our line of stack tumble dryers* provides double the capacity of Huebsch single-pocket tumble dryers, while using only half the floor space. Plus, you'll still only need one set of gas, electric and exhaust hookups, simplifying installation.

Efficient

A high-performance heater box and axial airflow pattern with sealed cylinder rims delivers the fastest, most efficient drying results in the industry. This efficiency reduces drying times and helps on-premises laundries increase throughput, while decreasing operating costs.

Easy to Operate

Fewer moving parts mean fewer maintenance problems and less wear, while large lint compartments are easy to keep clean, saving additional operator time.

Performance

Available in 30 lb per pocket and 45 lb per pocket capacities, there's a stack tumble dryer to meet the needs of any on-premises laundry.



Galaxy™

The Galaxy Control offers the flexibility of 30 programmable cycles combined with the accuracy of our moisture-sensing technology saving time and energy increasing the life of your linens, saving time and energy.

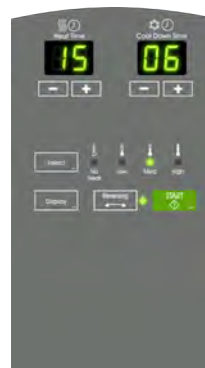

Dual Digital

With features including one-touch repeat, automatic extended tumble and a large digital countdown display, it's simple to set your drying time, temperature and cool down with the Dual Digital Control.

* Not all models are available in all markets. In order to highlight key details, machine images do not adhere to a standard scale.

On-Premises 30-lb Stack Tumble Dryer Specifications

MODEL		HTT30	
CONTROL OPTION		Galaxy, Dual Digital	
CAPACITY - lb (kg)		30 (13) x 2	
OVERALL WIDTH - in (mm)		31.5 (800)	
OVERALL DEPTH - in (mm)		42.8 (1090)	
OVERALL HEIGHT - in (mm)		76.3 (1940)	
CYLINDER DIAMETER - in (mm)		30.0 (762)	
CYLINDER DEPTH - in (mm)		26.0 (660)	
CYLINDER VOLUME - cu. ft. (liters)		10.6 (300)	
REVERSING CYLINDER		Option	
DOOR OPENING SIZE - in (mm)		22.6 (574)	
HEAT INPUT POWER	Gas Models - Per Pocket	73,000 x 2 Btu/hr	
	Electric Models	21 x 2 kW	
GAS CONNECTIONS* - in (npt)		0.5	
AIR OUTLET - in (mm)		1 x 8 (200) Oval	
MOTOR - hp	Fan	0.5	
	Cylinder	0.3	
AIRFLOW - cfm		2 x 400	
ELECTRICAL SPECS - amps	Gas		
	B	100-120V/50/60/1	16
	X	200-240V/50/60/1/3	9
	N	440-480V/50/60/3	6
	Electric		
	F	200-208V/50/60/3	61 x 2
	G	230-240V/50/60/3	52 x 2
	K	440V/50/60/3	29 x 2
L	460-480V/50/60/3	27 x 2	
SHIPPING DIMENSIONS APPROX. - in (mm)	Width		32.5 (826)
	Depth		47.0 (1194)
	Height		79.9 (2029)
NET WEIGHT - lb (kg)	Gas	570 (260)	
	Electric	660 (300)	
SHIPPING WEIGHT - lb (kg)	Gas	600 (270)	
	Electric	690 (313)	
AGENCY APPROVALS		CSA	

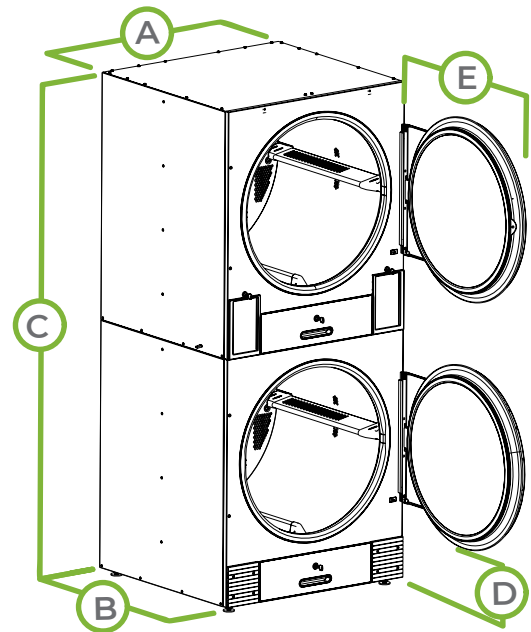

MODEL	HTT30
A. OVERALL WIDTH - in (mm)	31.5 (800)
B. OVERALL DEPTH - in (mm)	42.8 (1090)
C. OVERALL HEIGHT - in (mm)	76.3 (1940)
D. DOOR BOTTOM TO FLOOR - in (mm)	10.7 (270)
E. DOOR SWING - in (mm)	28 (710)

* LP gas available for 50,75 lb capacities only. Field conversion kits available for other capacities.

Tumble dryer models are made to suit a variety of electrical service characteristics. See your Huebsch distributor for specifications. For further details on installation, refer to Installation, Operation and Maintenance instructions supplied with the tumble dryer. Amperage ratings available in Installation Manual.

For the most accurate information, the installation guide should be used for all design and construction purposes. Due to continuous product improvements, design and specifications subject to change without notice. The quality management systems at Alliance Laundry Systems are registered to ISO 9001.

On-Premises 45-lb Stack Tumble Dryer

Our line of stack tumble dryers* provides double the capacity of Huebsch single-pocket tumble dryers, while using only half the floor space. Plus, you'll still only need one set of gas, electric and exhaust hookups, simplifying installation.



Efficient

A high-performance heater box and axial airflow pattern with sealed cylinder rims delivers the fastest, most efficient drying results in the industry. This efficiency reduces drying times and helps on-premises laundries increase throughput, while decreasing operating costs.

Easy to Operate

Fewer moving parts mean fewer maintenance problems and less wear, while large lint compartments are easy to keep clean, saving additional operator time.

Performance

Available in 30 lb per pocket and 45 lb per pocket capacities, there's a stack tumble dryer to meet the needs of any on-premises laundry.



Galaxy™

The Galaxy Control offers the flexibility of 30 programmable cycles combined with the accuracy of our moisture-sensing technology saving time and energy increasing the life of your linens, saving time and energy.

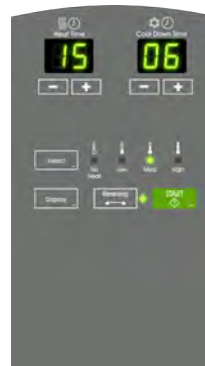

Dual Digital

With features including one-touch repeat, automatic extended tumble and a large digital countdown display, it's simple to set your drying time, temperature and cool down with the Dual Digital Control.

* Not all models are available in all markets. In order to highlight key details, machine images do not adhere to a standard scale.

On-Premises 45-lb Stack Tumble Dryer Specifications

MODEL		HTT45	
CONTROL OPTION		Galaxy, Dual Digital	
CAPACITY - lb (kg)		45 (20) x 2	
OVERALL WIDTH - in (mm)		34.5 (875)	
OVERALL DEPTH - in (mm)		48.6 (1235)	
OVERALL HEIGHT - in (mm)		81.3 (2065)	
CYLINDER DIAMETER - in (mm)		33.0 (838)	
CYLINDER DEPTH - in (mm)		30.0 (762)	
CYLINDER VOLUME - cu. ft. (liters)		14.8 (420)	
REVERSING CYLINDER		Option	
DOOR OPENING SIZE - in (mm)		26.9 (683)	
HEAT INPUT POWER		95,000 x 2 Btu/hr	
GAS CONNECTIONS* - in (npt)		0.5	
AIR OUTLET - in (mm)		1 x 10 (250) Oval	
MOTOR - hp		2 x 0.5	
AIRFLOW - cfm		2x 600	
ELECTRICAL SPECS - amps	X	200-240V/50/60/1/3	12
	N	440-480V/50/60/3	6
SHIPPING DIMENSIONS APPROX. - in (mm)	Width	35.5 (902)	
	Depth	54.0 (1372)	
	Height	84.9 (2156)	
NET WEIGHT - lb (kg)		710 (320)	
SHIPPING WEIGHT - lb (kg)		750 (340)	
AGENCY APPROVALS		CSA	

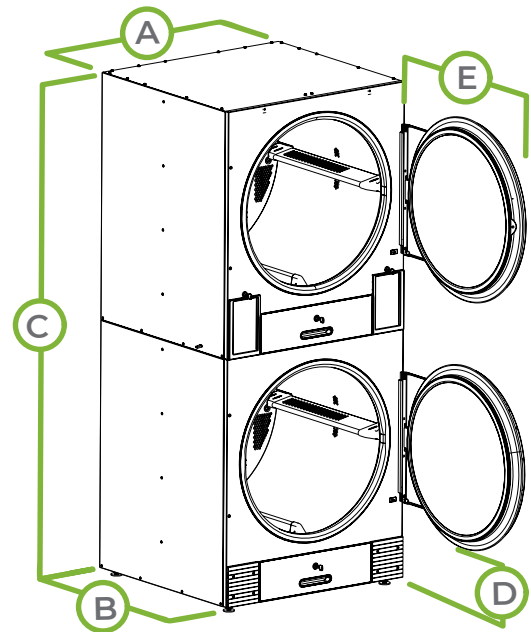

MODEL	HTT45
A. OVERALL WIDTH - in (mm)	34.5 (875)
B. OVERALL DEPTH - in (mm)	48.6 (1235)
C. OVERALL HEIGHT - in (mm)	81.3 (2065)
D. DOOR BOTTOM TO FLOOR - in (mm)	9.3 (235)
E. DOOR SWING - in (mm)	31.9 (810)

* LP gas available for 50,75 lb capacities only. Field conversion kits available for other capacities.

Tumble dryer models are made to suit a variety of electrical service characteristics. See your Huebsch distributor for specifications. For further details on installation, refer to Installation, Operation and Maintenance instructions supplied with the tumble dryer. Amperage ratings available in Installation Manual.

For the most accurate information, the installation guide should be used for all design and construction purposes. Due to continuous product improvements, design and specifications subject to change without notice. The quality management systems at Alliance Laundry Systems are registered to ISO 9001.

On-Premises **Front Control** Dryer



With a large load capacity in a compact frame, each one of our single dryers is all business, all the time. This Huebsch dryer features an easy-to-clean lint compartment and the industry's largest door opening (2.06 sq ft, 1,913.8 sq cm) for faster loading and unloading. Huebsch single dryers are designed to suit your needs.

Quality

Durable, galvanized-steel cylinder with an extra-large 7 cu ft (198L) of volume handles your biggest loads.

Efficient

Efficient dryer heating with 20,000 Btu (5,043 kCal) (gas models) and up to 5,200 W (electric models), helps keep costs down and productivity up.



Icon keypad

Electronic Control

The Electronic Control keeps users informed throughout the drying process with cycle-status lights and a digital cycle countdown. Users also have the flexibility to control temperature and dryness levels to achieve high levels of efficiency. Automatic (moisture-sensing) cycles come standard to prevent over-drying of your linens.

On-Premises **Front Control Dryer** Specifications

SPECIFICATIONS

Models	Electric	YDEE5BGS173CW01
	Gas	YDGE5BGS113CW01
Control Option	Electronic Homestyle	
Control Location	Front	
Capacity - lb (kg)	18 (8.2)	
Cylinder Volume - cu. ft. (liters)	7.0 (198)	
Overall Width - in (mm)	26.875 (683)	
Overall Depth - in (mm)	28 (711)	
Overall Height - in (mm)	40.42 (1027)	
Motor Power Consumption - hp (kw)	0.33 (0.25)	
Available Heat Sources	Gas or Electric	
Available Heating Element (Electric W)	5350 @ 240V	
Gas Inlet Connection - in (mm)	3/8 (9.5)	
Gas Consumption - BTU/Hr	22,500	
Exhaust Outlet Dia. - in (mm)	4 (102)	
Exhaust Airflow - cfm (liters/sec)	220 (105)	
*Available Cycles	Regular, Perm Press, Delicate, Time Dry, Quick Dry, Fluff Up	
Cycle Indicator Lights	Yes	
Cylinder Finish	Galvanized	
Available Colors	White	
Door Type (Solid/Window)	Solid	
Available Electrical Requirements - Voltage/Hz/Ph - Circuit Amperage	Electric	208/240/60/1 -30
	Gas	120/60/1 - 15
Shipping Dimensions Approx. - in (mm)	Width	29.5 (749)
	Depth	30.5 (775)
	Height	45 (1143)
Net Weight - lb (kg)	Electric	126 (57)
	Gas	130 (59)
Shipping Weight - lb (kg)	Electric	136 (62)
	Gas	140 (64)
Agency Approvals	Electric	cULus
	Gas	cCSAus

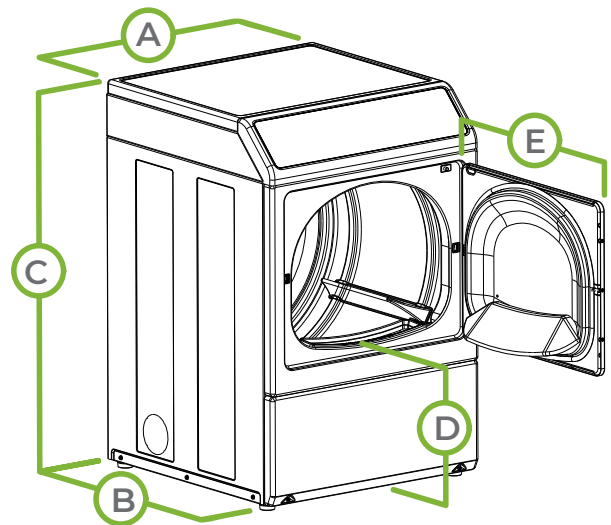

DIMENSIONS

A.	Overall Width - in (mm)	26.875 (683)
B.	Overall Depth - in (mm)	28 (711)
C.	Overall Height - in (mm)	40.42 (1027)
D.	Door Bottom to Floor - in (mm)	15.44 (392)
E.	Door Swing - in (mm)	23.5 (597)

ADA Compliant

Note: Not all options are available for all models. Refer to the price list for the available models and options. Twelfth digit in model number indicates US or Canadian unit. C=Canada and T=US.

* Information shown applies to highest end control available.

For the most accurate information, the installation guide should be used for all design and construction purposes. Due to continuous product improvements, design and specifications subject to change without notice. The quality management systems at Alliance Laundry Systems are registered to ISO 9001.

On-Premises **Front Control Stack Dryer**



Get the double the drying capacity in the space of one machine with Huebsch's stack dryer. With easy-to-clean lint compartments and the industry's largest doors (2.06 sq ft, or 1,913.8 sq cm) for faster loading and unloading, Huebsch stack dryers are designed to keep loads moving through the laundry.

Quality

Durable, galvanized-steel cylinders with an extra-large 7 cu ft (198L) of volume handle your biggest loads.

Efficient

Efficient dryer heating with 20,000 Btu (5,043 kCal) (gas models) and up to 5350W (electric models), helps keep costs down and productivity up.



English keypad

Electronic Control

The Electronic Control keeps users informed throughout the drying process with cycle-status lights and a digital cycle countdown. Users also have the flexibility to control temperature and dryness levels to achieve high levels of efficiency. Automatic (moisture-sensing) cycles come standard to prevent over-drying of your linens.

On-Premises **Front Control Stack Dryer** Specifications

SPECIFICATIONS

Available Controls	Electronic Homestyle	
Models	Electric	YSEE5AGS173TW01
	Gas	YSGE5AGS113TW01
Capacity - lb (kg)	18 (8.2)	
Cylinder Volume - cu. Ft. (liters)	7.0 (198)	
Width - in (mm)	26.875 (683)	
Depth - in (mm)	28 (711)	
Height - in (mm)	78.17 (1986)	
Motor Size - HP (kw)	0.33 (0.25)	
Available Heat Sources	Electric or Gas	
Available Heating Element (Electric W)	4750 @ 208V 5350 @ 240V	
Gas Inlet Connection - in (mm)	3/8 (9.5)	
Gas Consumption - BTU/Hr	22,500	
Exhaust Outlet Diameter - in (mm)	4 (102)	
Exhaust Airflow - cfm (liters/sec)	220 (105)	
Available Cycles	Regular, Perm Press, Delicate, Time Dry, Quick Dry, Fluff Up	
Cycle Indicator Lights	Yes	
Cylinder Finish	Galvanized	
Available Colors	White	
Door Type (Solid/Window)	Solid	
Available Electrical Requirements - (Voltage/Hz/Ph-Amp)	Electric	120/240/60/1 - 30
	Gas	120/60/1 - 15
Net Weight - lb (kg)	Electric	262 (119)
	Gas	270 (122)
Shipping Weight - lb (kg)	Electric	272 (123)
	Gas	280 (127)
Shipping Width - in (mm)	30 (762)	
Shipping Depth - in (mm)	33 (838)	
Shipping Height - in (mm)	80 (2032)	
Available Agency Approvals	Electric	C _{UL} US
	Gas	C _{CSA} US

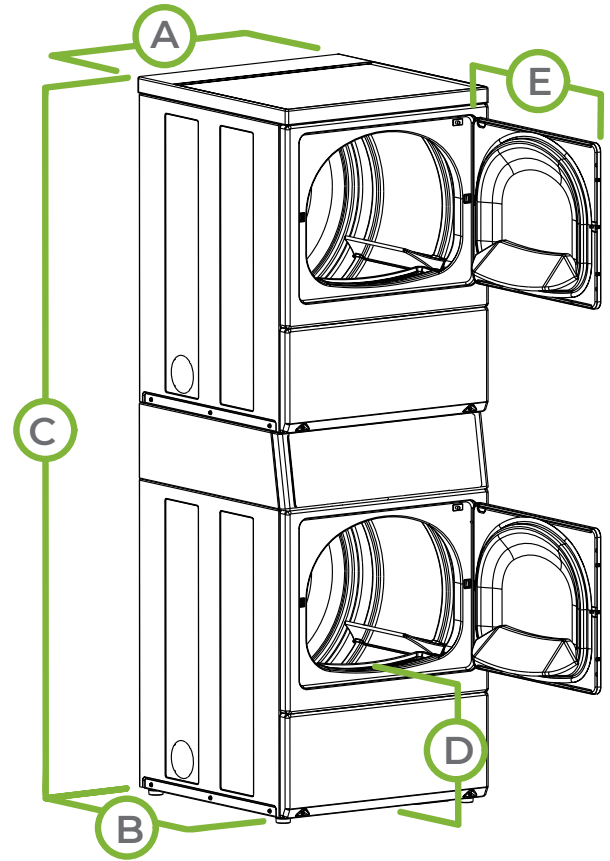

DIMENSIONS

A. Overall Width - in (mm)	26.875 (683)
B. Overall Depth - in (mm)	28 (711)
C. Overall Height - in (mm)	78.17 (1986)
D. Door Bottom to Floor - in (mm)	15.44 (392)
E. Door Swing - in (mm)	23.5 (597)

* Information shown applies to highest end control available.

Refer to the price list for the available models and options.

Lower unit is ADA Compliant.

For the most accurate information, the installation guide should be used for all design and construction purposes. Due to continuous product improvements, design and specifications subject to change without notice. The quality management systems at Alliance Laundry Systems are registered to ISO 9001.

On-Premises **Front Control** **Stack Washer/Dryer**

Get the complete package in a single unit, combining our efficient dryers with the powerful performance of our industry-leading front load washers. Our line of stack washer/dryers are designed as vertical combinations that provide all of the power of Huebsch washers and dryers, while occupying only half of the floor space of a conventional washer and dryer setup. Plus, these stacked units allow you to use the same connections and hookups required as a standard washer and dryer, so you won't have to make changes to your installation.



Power

Our high spin speed up to 440 G-Force removes more water from clothes, speeding up drying cycles and lowering dryer energy usage.

Smart

Improved suspension with new out-of-balance logic manages and redistributes unbalanced loads for uninterrupted wash cycles.

Efficient

Water use is trimmed to 11.7 gal (44.3L) per cycle to reduce operating costs.



English keypad



Icon keypad

Electronic Control

The Electronic Control keeps users informed throughout the wash process with cycle-status lights and a digital cycle countdown. Users also have the flexibility to control temperature, load type and soil levels, as well as options for prewash and/or additional rinse to achieve high levels of efficiency. Automatic (moisture-sensing) cycles come standard to prevent over-drying of your linens.

On-Premises **Front Control Stack Washer/Dryer** Specifications

SPECIFICATIONS		WASHER	DRYER
Available Controls		Electronic Homestyle	
Models	Electric	YTEE5ASP175TW01, YTEE5ASP285CW01	
	Gas	YTGE5ASP115TW01, YTGE5ASP095CW01	
Capacity - lb (kg)		21.5 (9.5)	18 (8.2)
Cylinder Volume - cu. Ft. (liters)		3.42 (96.8)	7.0 (198)
Width - in (mm)		26.875 (683)	
Depth - in (mm)		27.73 (704)	
Height - in (mm)		78.5 (1994)	
Spin Speed - G-Force (RPM)		440 (1200)	N/A
Motor Size - HP (kw)		Variable Speed Induction 0.9 (0.67)	0.33 (0.25)
Water Consumption per Cycle - g (l)		13.68 (51.8)	N/A
IWF (Water Factor)		4.0	N/A
IMEF (Modified Energy Factor)		2.20	N/A
Available Heat Sources		N/A	Electric or Gas
Available Heating Element (Electric W)		N/A	Can: 5000 @ 240V USA: 5350 @ 240V
Gas Inlet Connection - in (mm)		N/A	3/8 (9.5)
Gas Consumption - BTU/Hr		N/A	22,500
Exhaust Outlet Diameter - in (mm)		N/A	4 (102)
Exhaust Airflow - cfm (liters/sec)		N/A	220 (105)
Available Water Temperatures		3	N/A
Available Cycles		Heavy Duty, Normal Eco, Perm Press, Delicate, Rinse and Spin, Spin Only	Regular, Perm Press, Delicate, Time Dry, Quick Dry, Fluff Up
Water Pressure - PSI (Bar)		20-120 (1.4/8.3)	N/A
Cycle Indicator Lights		Yes	
Cylinder Finish		Stainless Steel	Galvanized
Available Colors		White	
Door Type (Solid/Window)		Window	
USA Electrical Requirements - (Voltage/Hz/Ph-Amp)		120/60/1 - 15	Elec: 208/240/60/1 - 30 Gas: 120/60/1 - 15
Canada Electrical Requirements - Single Supply Cord (Voltage/Hz/Ph-Amp)		Electric: 120/240/60/1 - 40 Gas: 120/60/1 - 20	
Net Weight - lb (kg)		350 (159)	
Shipping Weight - lb (kg)		380 (172)	
Shipping Width - in (mm)		30 (762)	
Shipping Depth - in (mm)		34 (864)	
Shipping Height - in (mm)		80 (2032)	
Available Agency Approvals		cULUS	Elec: ULUS Gas: C ^{UL} SAUS

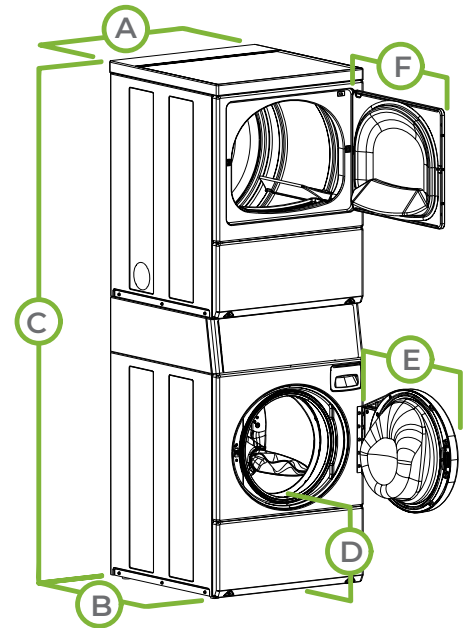

DIMENSIONS

A. Overall Width - in (mm)	26.875 (683)
B. Overall Depth - in (mm)	27.73 (704)
C. Overall Height - in (mm)	78.5 (1994)
D. Door Bottom to Floor - in (mm)	14.5 (368)
E. Washer Door Swing - in (mm)	24 (610)
F. Dryer Door Swing - in (mm)	23.5 (597)

Lower unit is ADA Compliant

Note: Not all options are available for all models. Refer to the price list for the available models and options.

* Information shown applies to highest end control available.

For the most accurate information, the installation guide should be used for all design and construction purposes. Due to continuous product improvements, design and specifications subject to change without notice. The quality management systems at Alliance Laundry Systems are registered to ISO 9001.

On-Premises Rear Control Dryer



With a large load capacity in a compact frame, each one of our single dryers is all business, all the time. This Huebsch dryer features an easy-to-clean lint compartment and the industry's largest door opening (2.06 sq ft, 1,913.8 sq cm) for faster loading and unloading. Huebsch single dryers are designed to suit your needs.

Quality

Durable, galvanized-steel cylinder with an extra-large 7 cu ft (198L) of volume handles your biggest loads.

Efficient

Efficient dryer heating with 20,000 Btu (5,043 kCal) (gas models) and up to 5,200 W (electric models), helps keep costs down and productivity up.

Electronic Control

The Electronic Control keeps users informed throughout the drying process with cycle-status lights and a digital cycle countdown. Users also have the flexibility to control temperature and dryness levels to achieve high levels of efficiency. Automatic (moisture-sensing) cycles come standard to prevent over-drying of your linens.



English keypad

E-Mech Control

The E-Mech Control features an intuitive design offering users simple fabric selections and drying time while using cue lights to monitor progress through the drying cycle (available on rear-control models only).

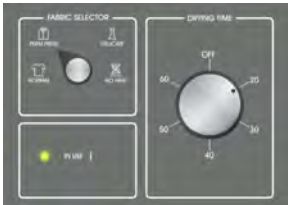

Icon keypad

Mechanical Control

The Mechanical Control is designed for durability and is easy to operate with a multi-cycle timer knob and automatic dry cycles.

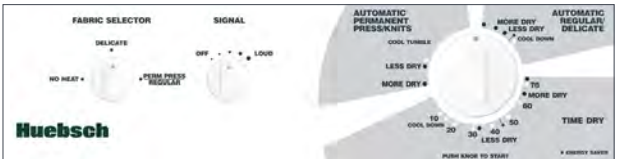

English & French language

On-Premises Rear Control Dryer Specifications

SPECIFICATIONS

Available Controls		Electronic	E-Mech	Mechanical
Models	Electric	YDEE7RGS173CW01 YDEE7RGS173TW01	HDEMNRGS173CW01	YDE3TRGS171CW01
	Gas	YDGE7RGS113CW01 YDGE7RGS113TW01	HDGMNRGS113CW01	YDG3TRGS111CW01
Control Location		Rear		
Capacity - lb (kg)		18 (8.2)		
Cylinder Volume - cu. Ft. (liters)		7.0 (198)		
Overall Width - in (mm)		26.875 (683)		
Overall Depth - in (mm)		28 (711)		
Overall Height - in (mm)		43 (1092)		
Motor Power Consumption - HP (kw)		0.33 (0.25)		
Available Heat Sources		Electric or Gas		
Available Heating Element (Electric W)		4750 @ 208V 5350 @ 240V		
Gas Inlet Connection - in (mm)		3/8 (9.5)		
Gas Consumption - BTU/Hr		22,500		
Exhaust Outlet DIA - in (mm)		4 (102)		
Exhaust Airflow - cfm (liters/sec)		220 (105)		
*Available Cycles		Regular, Perm Press, Delicate, Time Dry, Quick Dry, Fluff Up		
Cycle Indicator Lights		Yes		
Cylinder Finish		Galvanized		
Available Colors		White		
Door Type (Solid/Window)		Solid		
Available Electrical Requirements - (Voltage/Hz/Ph)		Electric: 120/240/60/1 - 30 Amp Electric: 120/208/60/1 - 30 Amp Gas: 120/60/1 - 15 Amp		
Net Weight - lb (kg)		Elec/Gas 130/135 (59/61)		
Shipping Weight - lb (kg)		Elec/Gas 140/145 (64/66)		
Shipping Width - in (mm)		29 (737)		
Shipping Depth - in (mm)		32.75 (832)		
Shipping Height - in (mm)		45.5 (1156)		
Available Agency Approvals		Elec: cUL _{US} , Gas: cCSA _{US}		

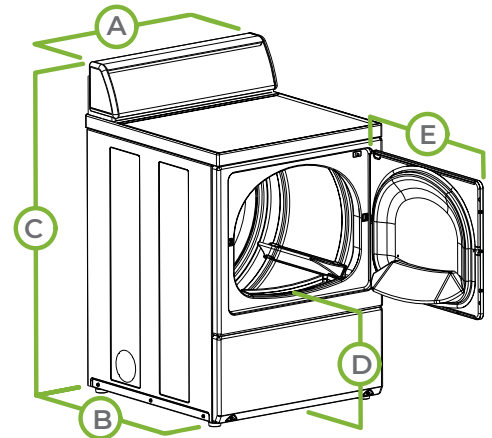

DIMENSIONS

A.	Overall Width - in (mm)	26.875 (683)
B.	Overall Depth - in (mm)	28 (711)
C.	Overall Height - in (mm)	43 (1092)
D.	Door Bottom to Floor - in (mm)	15.44 (392)
E.	Door Swing - in (mm)	23.5 (597)

ADA Compliant

Note: Not all options are available for all models. Refer to the price list for the available models and options. Twelfth digit in model number indicates US or Canadian unit. C=Canada and T=US.

* Information shown applies to highest end control available.

For the most accurate information, the installation guide should be used for all design and construction purposes. Due to continuous product improvements, design and specifications subject to change without notice. The quality management systems at Alliance Laundry Systems are registered to ISO 9001.

On-Premises 20-lb Softmount Washer-Extractor



Maximized throughput, minimized costs. That's what busy on-premises laundries demand. Huebsch® softmount washer-extractors deliver those results, while producing exceptional finished wash quality. In addition, their durability ensures the machines will be consistent laundry performers for years to come.

Strength

A heavy-duty suspension system absorbs vibrations without the need for special foundations. Reinforced stainless steel side panels and oversized door and hinges contribute to durability and a long life for the machine.

Power

High G-Force extraction speeds of between 350 and 400 G-Force deliver exceptional power to remove more water from loads and reduce drying time – combining for increased throughput.

Performance

Available in a variety of capacities, including 20 lb, 25 lb, 30 lb, 40 lb, 55 lb, 70 lb, 90 lb and 125 lb Huebsch has a softmount washer-extractor model to meet the needs of any on-premises laundry.



HC200

The HC200 Control provides up to 99 cycle programs. Versatile and easy to use, the advanced computer control meets a variety of specialized needs. With more than 20 languages available, our HC200 is intuitive for bilingual operators. Users can easily follow the status of every phase of the wash cycle and modify data and parameters at any time to monitor for maximum efficiency.

On-Premises 20-lb Softmount Washer-Extractor Specifications

MODEL		HY020
CONTROL OPTION		HC200
CAPACITY - lb (kg)		20 (8)
OVERALL WIDTH - in (mm)		27.95 (710)
OVERALL DEPTH - in (mm)		31.1 (790)
OVERALL HEIGHT - in (mm)		43.89 (1115)
CYLINDER DIAMETER - in (mm)		20.87 (530)
CYLINDER DEPTH - in (mm)		13.78 (350)
CYLINDER VOLUME - cu. ft. (liters)		2.6 (75)
DOOR OPENING SIZE - in (mm)		13 (330)
DOOR BOTTOM TO FLOOR - in (mm)		13.74 (349)
WASH SPEED - RPM		49
EXTRACT SPEED - RPM		1165
EXTRACT G-FORCE		400
WATER INLET CONNECTION - in (mm)		2 x 0.75 (19)
STEAM INLET CONNECTION - in (mm)		0.5 (13)
DRAIN DIAMETER - in (mm)		3 (76)
MOTOR POWER CONSUMPTION - hp (kw)		1.00 (.75)
VOLTAGE/ CIRCUIT BREAKER - FLA *	200-240/50/60/1/3**	10-6.7 (1 Ph) 10-6.7 (3 Ph)
SHIPPING DIMEN- SIONS APPROX. - in (mm)	Width	29.53 (750)
	Depth	33.01 (840)
	Height	49.02 (1245)
NET WEIGHT - lb (kg)		408 (185)
SHIPPING WEIGHT - lb (kg)		441 (200)
AGENCY APPROVALS		CSA

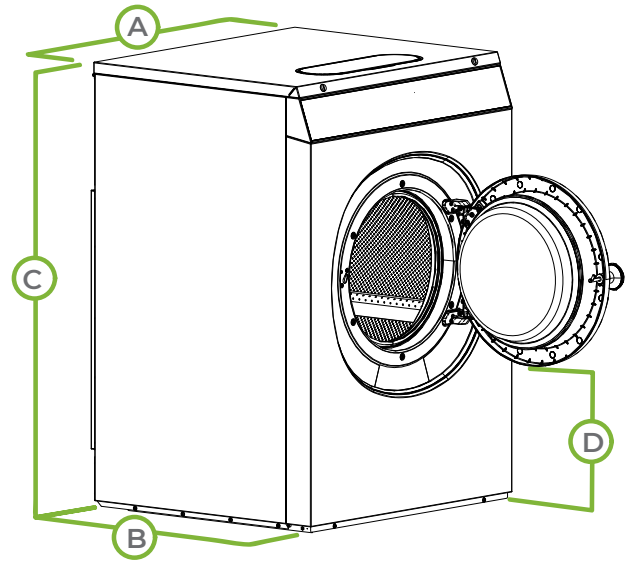

MODEL	HY020
A. OVERALL WIDTH - in (mm)	27.95 (710)
B. OVERALL DEPTH - in (mm)	31.10 (790)
C. OVERALL HEIGHT - in (mm)	43.89 (1115)
D. DOOR BOTTOM TO FLOOR - in (mm)	13.74 (349)

* Circuit breaker and amp draw data shown are for models without electric heat. Consult factory for other configurations. Manufacturing strongly recommends using a circuit breaker instead of fuses.

** Operates on single or three phase systems as single phase

For the most accurate information, the installation guide should be used for all design and construction purposes. Due to continuous product improvements, design and specifications subject to change without notice. The quality management system of Alliance Laundry Systems has been registered to ISO 9001.

On-Premises 25-lb Softmount Washer-Extractor



Maximized throughput, minimized costs. That's what busy on-premises laundries demand. Huebsch® softmount washer-extractors deliver those results, while producing exceptional finished wash quality. In addition, their durability ensures the machines will be consistent laundry performers for years to come.

Strength

A heavy-duty suspension system absorbs vibrations without the need for special foundations. Reinforced stainless steel side panels and oversized door and hinges contribute to durability and a long life for the machine.

Power

High G-Force extraction speeds of between 350 and 400 G-Force deliver exceptional power to remove more water from loads and reduce drying time – combining for increased throughput.

Performance

Available in a variety of capacities, including 20 lb, 25 lb, 30 lb, 40 lb, 55 lb, 70 lb, 90 lb and 125 lb Huebsch has a softmount washer-extractor model to meet the needs of any on-premises laundry.



HC200

The HC200 Control provides up to 99 cycle programs. Versatile and easy to use, the advanced computer control meets a variety of specialized needs. With more than 20 languages available, our HC200 is intuitive for bilingual operators. Users can easily follow the status of every phase of the wash cycle and modify data and parameters at any time to monitor for maximum efficiency.

On-Premises 25-lb Softmount Washer-Extractor Specifications

MODEL		HY025
CONTROL OPTION		HC200
CAPACITY - lb (kg)		25 (11)
OVERALL WIDTH - in (mm)		31.29 (795)
OVERALL DEPTH - in (mm)		31.29 (795)
OVERALL HEIGHT - in (mm)		48.22 (1225)
CYLINDER DIAMETER - in (mm)		24.40 (620)
CYLINDER DEPTH - in (mm)		13.78 (350)
CYLINDER VOLUME - cu. ft. (liters)		3.7 (105)
DOOR OPENING SIZE - in (mm)		16.14 (410)
DOOR BOTTOM TO FLOOR - in (mm)		13.46 (342)
WASH SPEED - RPM		49
EXTRACT SPEED - RPM		1075
EXTRACT G-FORCE		400
WATER INLET CONNECTION - in (mm)		2 x 0.75 (19)
STEAM INLET CONNECTION - in (mm)		0.5 (13)
DRAIN DIAMETER - in (mm)		3 (76)
MOTOR POWER CONSUMPTION - hp (kw)		1.48 (1.10)
VOLTAGE/ CIRCUIT BREAKER - FLA *	200-240/50/60/1/3**	15-9.8 (1 Ph) 15-9.8 (3 Ph)
SHIPPING DIMEN- SIONS APPROX. - in (mm)	Width	32.87 (835)
	Depth	33.01 (840)
	Height	52.95 (1345)
NET WEIGHT - lb (kg)		463 (210)
SHIPPING WEIGHT - lb (kg)		518 (235)
AGENCY APPROVALS		CSA

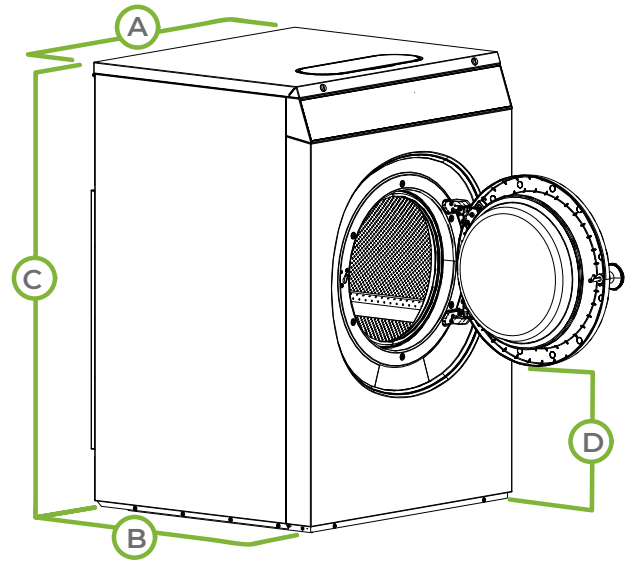

MODEL	HY025
A. OVERALL WIDTH - in (mm)	31.29 (795)
B. OVERALL DEPTH - in (mm)	31.29 (795)
C. OVERALL HEIGHT - in (mm)	48.22 (1225)
D. DOOR BOTTOM TO FLOOR - in (mm)	13.46 (342)

* Circuit breaker and amp draw data shown are for models without electric heat. Consult factory for other configurations. Manufacturing strongly recommends using a circuit breaker instead of fuses.

** Operates on single or three phase systems as single phase

For the most accurate information, the installation guide should be used for all design and construction purposes. Due to continuous product improvements, design and specifications subject to change without notice. The quality management system of Alliance Laundry Systems has been registered to ISO 9001.

On-Premises 30-lb Softmount Washer-Extractor



Maximized throughput, minimized costs. That's what busy on-premises laundries demand. Huebsch® softmount washer-extractors deliver those results, while producing exceptional finished wash quality. In addition, their durability ensures the machines will be consistent laundry performers for years to come.

Strength

A heavy-duty suspension system absorbs vibrations without the need for special foundations. Reinforced stainless steel side panels and oversized door and hinges contribute to durability and a long life for the machine.

Power

High G-Force extraction speeds of between 350 and 400 G-Force deliver exceptional power to remove more water from loads and reduce drying time – combining for increased throughput.

Performance

Available in a variety of capacities, including 20 lb, 25 lb, 30 lb, 40 lb, 55 lb, 70 lb, 90 lb and 125 lb Huebsch has a softmount washer-extractor model to meet the needs of any on-premises laundry.



HC200

The HC200 Control provides up to 99 cycle programs. Versatile and easy to use, the advanced computer control meets a variety of specialized needs. With more than 20 languages available, our HC200 is intuitive for bilingual operators. Users can easily follow the status of every phase of the wash cycle and modify data and parameters at any time to monitor for maximum efficiency.

On-Premises **30-lb Softmount Washer-Extractor** Specifications

MODEL		HY030
CONTROL OPTION		HC200
CAPACITY - lb (kg)		30 (14)
OVERALL WIDTH - in (mm)		31.29 (795)
OVERALL DEPTH - in (mm)		37.2 (945)
OVERALL HEIGHT - in (mm)		48.22 (1225)
CYLINDER DIAMETER - in (mm)		24.4 (620)
CYLINDER DEPTH - in (mm)		17.72 (450)
CYLINDER VOLUME - cu. ft. (liters)		4.8 (135)
DOOR OPENING SIZE - in (mm)		16.14 (410)
DOOR BOTTOM TO FLOOR - in (mm)		13.46 (342)
WASH SPEED - RPM		49
EXTRACT SPEED - RPM		1075
EXTRACT G-FORCE		400
WATER INLET CONNECTION - in (mm)		2 x 0.75 (19)
STEAM INLET CONNECTION - in (mm)		0.5 (13)
DRAIN DIAMETER - in (mm)		3 (76)
MOTOR POWER CONSUMPTION - hp (kw)		2.01 (1.50)
VOLTAGE/ CIRCUIT BREAKER - FLA*	200-240/50/60/1/3**	15-10.1 (1 Ph) 15-10.1 (3 Ph)
SHIPPING DIMEN- SIONS APPROX. - in (mm)	Width	32.87 (835)
	Depth	38.78 (985)
	Height	52.95 (1345)
NET WEIGHT - lb (kg)		563 (255)
SHIPPING WEIGHT - lb (kg)		606 (275)
AGENCY APPROVALS		CSA

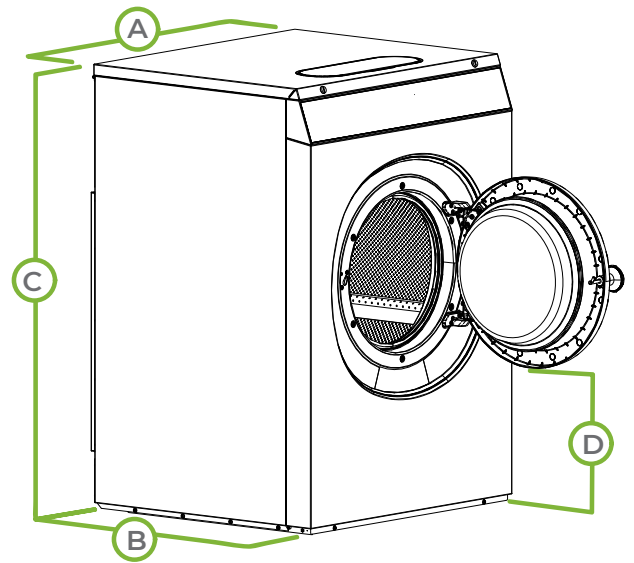

MODEL	HY030
A. OVERALL WIDTH - in (mm)	31.29 (795)
B. OVERALL DEPTH - in (mm)	37.2 (945)
C. OVERALL HEIGHT - in (mm)	48.22 (1225)
D. DOOR BOTTOM TO FLOOR - in (mm)	13.46 (342)

* Circuit breaker and amp draw data shown are for models without electric heat. Consult factory for other configurations. Manufacturing strongly recommends using a circuit breaker instead of fuses.

** Operates on single or three phase systems as single phase

For the most accurate information, the installation guide should be used for all design and construction purposes. Due to continuous product improvements, design and specifications subject to change without notice. The quality management system of Alliance Laundry Systems has been registered to ISO 9001.

On-Premises 40-lb Softmount Washer-Extractor



Maximized throughput, minimized costs. That's what busy on-premises laundries demand. Huebsch® softmount washer-extractors deliver those results, while producing exceptional finished wash quality. In addition, their durability ensures the machines will be consistent laundry performers for years to come.

Strength

A heavy-duty suspension system absorbs vibrations without the need for special foundations. Reinforced stainless steel side panels and oversized door and hinges contribute to durability and a long life for the machine.

Power

High G-Force extraction speeds of between 350 and 400 G-Force deliver exceptional power to remove more water from loads and reduce drying time – combining for increased throughput.

Performance

Available in a variety of capacities, including 20 lb, 25 lb, 30 lb, 40 lb, 55 lb, 70 lb, 90 lb and 125 lb Huebsch has a softmount washer-extractor model to meet the needs of any on-premises laundry.



HC200

The HC200 Control provides up to 99 cycle programs. Versatile and easy to use, the advanced computer control meets a variety of specialized needs. With more than 20 languages available, our HC200 is intuitive for bilingual operators. Users can easily follow the status of every phase of the wash cycle and modify data and parameters at any time to monitor for maximum efficiency.

On-Premises 40-lb Softmount Washer-Extractor Specifications

MODEL		HY040
CONTROL OPTION		HC200
CAPACITY - lb (kg)		40 (18)
OVERALL WIDTH - in (mm)		38.18 (970)
OVERALL DEPTH - in (mm)		38.18 (970)
OVERALL HEIGHT - in (mm)		55.51 (1410)
CYLINDER DIAMETER - in (mm)		29.53 (750)
CYLINDER DEPTH - in (mm)		16.14 (410)
CYLINDER VOLUME - cu. ft. (liters)		6.4 (180)
DOOR OPENING SIZE - in (mm)		18.11 (460)
DOOR BOTTOM TO FLOOR - in (mm)		18.77 (477)
WASH SPEED - RPM		42
EXTRACT SPEED - RPM		980
EXTRACT G-FORCE		400
WATER INLET CONNECTION - in (mm)		2 x 0.75 (19)
STEAM INLET CONNECTION - in (mm)		0.5 (13)
DRAIN DIAMETER - in (mm)		3 (76)
MOTOR POWER CONSUMPTION - hp (kw)		2.95 (2.20)
VOLTAGE/ CIRCUIT BREAKER - FLA*	200-240/50/60/1/3**	20-14.2 (1 Ph) 20-14.2 (3 Ph)
SHIPPING DIMEN- SIONS APPROX. - in (mm)	Width	40.35 (1025)
	Depth	39.96 (1015)
	Height	61.02 (1550)
NET WEIGHT - lb (kg)		838 (380)
SHIPPING WEIGHT - lb (kg)		871 (395)
AGENCY APPROVALS		CSA

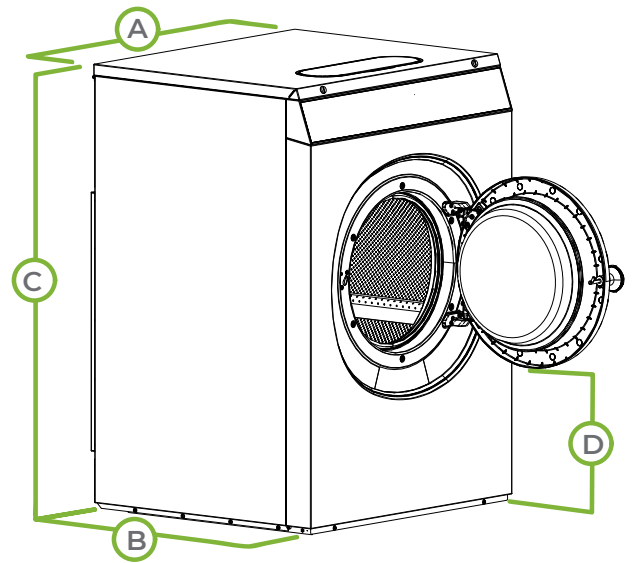

MODEL	HY040
A. OVERALL WIDTH - in (mm)	38.18 (970)
B. OVERALL DEPTH - in (mm)	38.18 (970)
C. OVERALL HEIGHT - in (mm)	55.51 (1410)
D. DOOR BOTTOM TO FLOOR - in (mm)	18.77 (477)

* Circuit breaker and amp draw data shown are for models without electric heat. Consult factory for other configurations. Manufacturing strongly recommends using a circuit breaker instead of fuses.

** Operates on single or three phase systems as single phase

For the most accurate information, the installation guide should be used for all design and construction purposes. Due to continuous product improvements, design and specifications subject to change without notice. The quality management system of Alliance Laundry Systems has been registered to ISO 9001.

On-Premises **55-lb** Softmount Washer-Extractor



Maximized throughput, minimized costs. That's what busy on-premises laundries demand. Huebsch® softmount washer-extractors deliver those results, while producing exceptional finished wash quality. In addition, their durability ensures the machines will be consistent laundry performers for years to come.

Strength

A heavy-duty suspension system absorbs vibrations without the need for special foundations. Reinforced stainless steel side panels and oversized door and hinges contribute to durability and a long life for the machine.

Power

High G-Force extraction speeds of between 350 and 400 G-Force deliver exceptional power to remove more water from loads and reduce drying time – combining for increased throughput.

Performance

Available in a variety of capacities, including 20 lb, 25 lb, 30 lb, 40 lb, 55 lb, 70 lb, 90 lb and 125 lb Huebsch has a softmount washer-extractor model to meet the needs of any on-premises laundry.



HC200

The HC200 Control provides up to 99 cycle programs. Versatile and easy to use, the advanced computer control meets a variety of specialized needs. With more than 20 languages available, our HC200 is intuitive for bilingual operators. Users can easily follow the status of every phase of the wash cycle and modify data and parameters at any time to monitor for maximum efficiency.

On-Premises **55-lb Softmount Washer-Extractor** Specifications

MODEL		HY055	
CONTROL OPTION		HC200	
CAPACITY - lb (kg)		55 (24)	
OVERALL WIDTH - in (mm)		38.18 (970)	
OVERALL DEPTH - in (mm)		43.5 (1105)	
OVERALL HEIGHT - in (mm)		55.51 (1410)	
CYLINDER DIAMETER - in (mm)		29.53 (750)	
CYLINDER DEPTH - in (mm)		21.46 (545)	
CYLINDER VOLUME - cu. ft. (liters)		8.5 (240)	
DOOR OPENING SIZE - in (mm)		18.11 (460)	
DOOR BOTTOM TO FLOOR - in (mm)		18.77 (477)	
WASH SPEED - RPM		42	
EXTRACT SPEED - RPM		980	
EXTRACT G-FORCE		400	
WATER INLET CONNECTION - in (mm)		2 x 0.75 (19)	
STEAM INLET CONNECTION - in (mm)		0.5 (13)	
DRAIN DIAMETER - in (mm)		3 (76)	
MOTOR POWER CONSUMPTION - hp (kw)		4.02 (3.00)	
VOLTAGE/ CIRCUIT BREAKER - FLA *	200-240/50/60/1/3**	20-15 (1 Ph)	20-15 (3 Ph)
	440-480/50/60/3	10-7.1	
SHIPPING DIMEN- SIONS APPROX. - in (mm)	Width	40.35 (1025)	
	Depth	45.28 (1150)	
	Height	61.02 (1550)	
NET WEIGHT - lb (kg)		948 (430)	
SHIPPING WEIGHT - lb (kg)		992 (450)	
AGENCY APPROVALS		CSA	

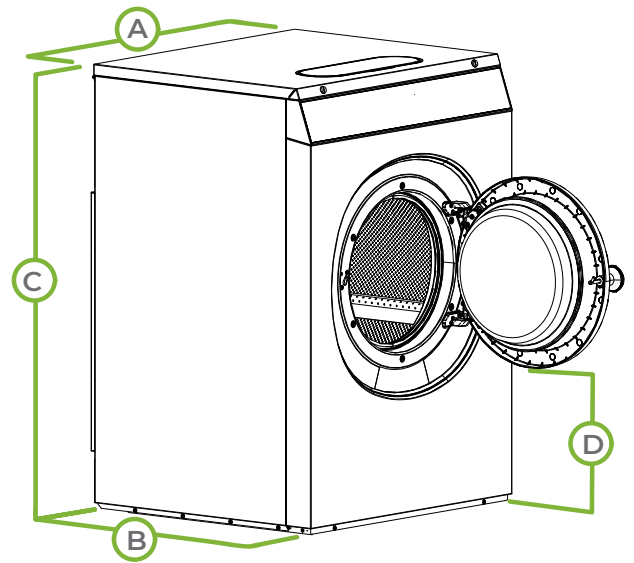

MODEL		HY055	
A.	OVERALL WIDTH - in (mm)	38.18 (970)	
B.	OVERALL DEPTH - in (mm)	43.5 (1105)	
C.	OVERALL HEIGHT - in (mm)	55.51 (1410)	
D.	DOOR BOTTOM TO FLOOR - in (mm)	18.77 (477)	

* Circuit breaker and amp draw data shown are for models without electric heat. Consult factory for other configurations. Manufacturing strongly recommends using a circuit breaker instead of fuses.

** Operates on single or three phase systems as single phase

For the most accurate information, the installation guide should be used for all design and construction purposes. Due to continuous product improvements, design and specifications subject to change without notice. The quality management system of Alliance Laundry Systems has been registered to ISO 9001.

On-Premises 70-lb Softmount Washer-Extractor



Maximized throughput, minimized costs. That's what busy on-premises laundries demand. Huebsch® softmount washer-extractors deliver those results, while producing exceptional finished wash quality. In addition, their durability ensures the machines will be consistent laundry performers for years to come.

Strength

A heavy-duty suspension system absorbs vibrations without the need for special foundations. Reinforced stainless steel side panels and oversized door and hinges contribute to durability and a long life for the machine.

Power

High G-Force extraction speeds of between 350 and 400 G-Force deliver exceptional power to remove more water from loads and reduce drying time – combining for increased throughput.

Performance

Available in a variety of capacities, including 20 lb, 25 lb, 30 lb, 40 lb, 55 lb, 70 lb, 90 lb and 125 lb Huebsch has a softmount washer-extractor model to meet the needs of any on-premises laundry.



HC200

The HC200 Control provides up to 99 cycle programs. Versatile and easy to use, the advanced computer control meets a variety of specialized needs. With more than 20 languages available, our HC200 is intuitive for bilingual operators. Users can easily follow the status of every phase of the wash cycle and modify data and parameters at any time to monitor for maximum efficiency.

On-Premises **70-lb Softmount Washer-Extractor** Specifications

MODEL		HY070	
CONTROL OPTION		HC200	
CAPACITY - lb (kg)		70 (28)	
OVERALL WIDTH - in (mm)		38.18 (970)	
OVERALL DEPTH - in (mm)		46.65 (1185)	
OVERALL HEIGHT - in (mm)		55.51 (1410)	
CYLINDER DIAMETER - in (mm)		29.53 (750)	
CYLINDER DEPTH - in (mm)		24.41 (620)	
CYLINDER VOLUME - cu. ft. (liters)		9.9 (280)	
DOOR OPENING SIZE - in (mm)		18.11 (460)	
DOOR BOTTOM TO FLOOR - in (mm)		18.77 (477)	
WASH SPEED - RPM		42	
EXTRACT SPEED - RPM		915	
EXTRACT G-FORCE		350	
WATER INLET CONNECTION - in (mm)		2 x 0.75 (19)	
STEAM INLET CONNECTION - in (mm)		0.5 (13)	
DRAIN DIAMETER - in (mm)		3 (76)	
MOTOR POWER CONSUMPTION - hp (kw)		4.02 (3.00)	
VOLTAGE/ CIRCUIT BREAKER - FLA *	200-240/50/60/1/3**	20-16 (1 Ph)	20-16 (3 Ph)
	440-480/50/60/3	10-7.2	
SHIPPING DIMEN- SIONS APPROX. - in (mm)	Width	40.35 (1025)	
	Depth	48.23 (1225)	
	Height	61.02 (1550)	
NET WEIGHT - lb (kg)		1092 (495)	
SHIPPING WEIGHT - lb (kg)		1135 (515)	
AGENCY APPROVALS		CSA	

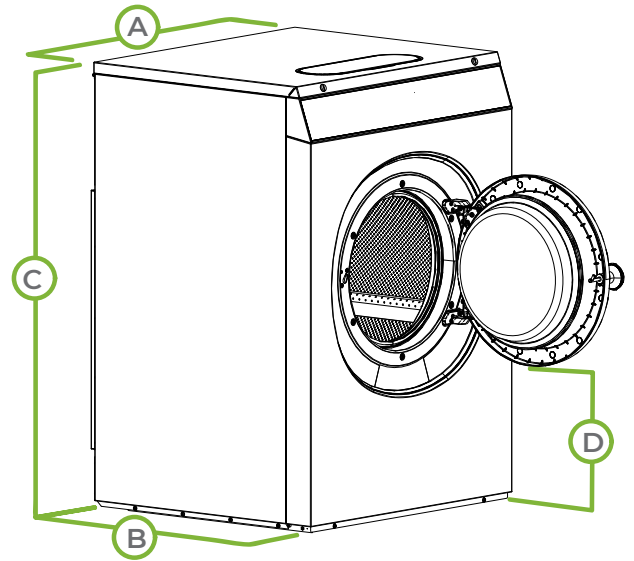

MODEL		HY070	
A.	OVERALL WIDTH - in (mm)	38.18 (970)	
B.	OVERALL DEPTH - in (mm)	46.65 (1185)	
C.	OVERALL HEIGHT - in (mm)	55.51 (1410)	
D.	DOOR BOTTOM TO FLOOR - in (mm)	18.77 (477)	

* Circuit breaker and amp draw data shown are for models without electric heat. Consult factory for other configurations. Manufacturing strongly recommends using a circuit breaker instead of fuses.

** Operates on single or three phase systems as single phase

For the most accurate information, the installation guide should be used for all design and construction purposes. Due to continuous product improvements, design and specifications subject to change without notice. The quality management system of Alliance Laundry Systems has been registered to ISO 9001.

On-Premises 90-lb Softmount Washer-Extractor



Maximized throughput, minimized costs. That's what busy on-premises laundries demand. Huebsch® softmount washer-extractors deliver those results, while producing exceptional finished wash quality. In addition, their durability ensures the machines will be consistent laundry performers for years to come.

Strength

A heavy-duty suspension system absorbs vibrations without the need for special foundations. Reinforced stainless steel side panels and oversized door and hinges contribute to durability and a long life for the machine.

Power

High G-Force extraction speeds of between 350 and 400 G-Force deliver exceptional power to remove more water from loads and reduce drying time – combining for increased throughput.

Performance

Available in a variety of capacities, including 20 lb, 25 lb, 30 lb, 40 lb, 55 lb, 70 lb, 90 lb and 125 lb Huebsch has a softmount washer-extractor model to meet the needs of any on-premises laundry.



HC200

The HC200 Control provides up to 99 cycle programs. Versatile and easy to use, the advanced computer control meets a variety of specialized needs. With more than 20 languages available, our HC200 is intuitive for bilingual operators. Users can easily follow the status of every phase of the wash cycle and modify data and parameters at any time to monitor for maximum efficiency.

On-Premises 90-lb Softmount Washer-Extractor Specifications

MODEL		HY090
CONTROL OPTION		HC200
CAPACITY - lb (kg)		90 (40)
OVERALL WIDTH - in (mm)		47.04 (1195)
OVERALL DEPTH - in (mm)		56.3 (1430)
OVERALL HEIGHT - in (mm)		75 (1905)
CYLINDER DIAMETER - in (mm)		36 (914)
CYLINDER DEPTH - in (mm)		24 (610)
CYLINDER VOLUME - cu. ft. (liters)		14.1 (400)
DOOR OPENING SIZE - in (mm)		21.3 (540)
DOOR BOTTOM TO FLOOR - in (mm)		28.74 (730)
WASH SPEED - RPM		38
EXTRACT SPEED - RPM		830
EXTRACT G-FORCE		350
WATER INLET CONNECTION - in (mm)		3 x 1 (25)
STEAM INLET CONNECTION - in (mm)		0.75 (19)
DRAIN DIAMETER - in (mm)		2 x 3 (76)
MOTOR POWER CONSUMPTION - hp (kw)		10.06 (7.50)
VOLTAGE/ CIRCUIT BREAKER - FLA*	No Heat	
	200-240/50/60/3	40-25.4
	440-480/50/60/3	20-14.6
	Heat	
	200-240/50/60/3	120-105
	440-480/50/60/3	63-58
SHIPPING DIMEN- SIONS APPROX. - in (mm)	Width	56.3 (1430)
	Depth	61.8 (1570)
	Height	82.9 (2105)
NET WEIGHT - lb (kg)		3439 (1560)
SHIPPING WEIGHT - lb (kg)		3748 (1700)
AGENCY APPROVALS		CSA

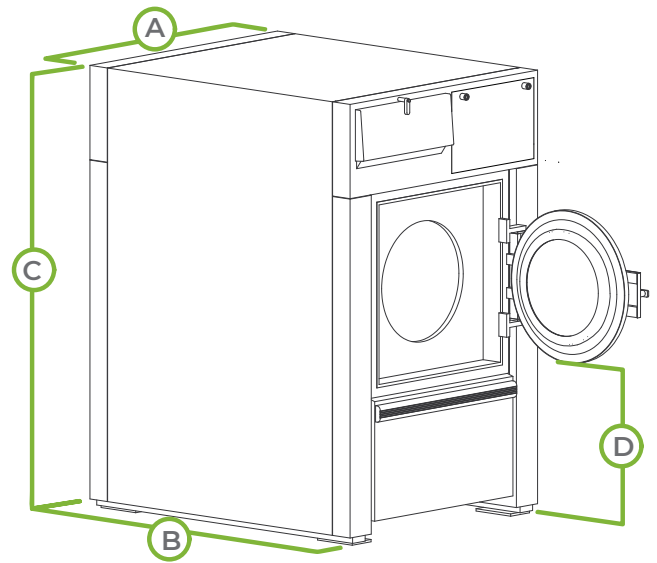

MODEL	HY090
A. OVERALL WIDTH - in (mm)	47.04 (1195)
B. OVERALL DEPTH - in (mm)	56.3 (1430)
C. OVERALL HEIGHT - in (mm)	75 (1905)
D. DOOR BOTTOM TO FLOOR - in (mm)	28.74 (730)

* Circuit breaker and amp draw data shown are for models without electric heat. Consult factory for other configurations. Manufacturing strongly recommends using a circuit breaker instead of fuses.

For the most accurate information, the installation guide should be used for all design and construction purposes. Due to continuous product improvements, design and specifications subject to change without notice. The quality management system of Alliance Laundry Systems has been registered to ISO 9001.

On-Premises **125-lb** Softmount Washer-Extractor



Maximized throughput, minimized costs. That's what busy on-premises laundries demand. Huebsch® softmount washer-extractors deliver those results, while producing exceptional finished wash quality. In addition, their durability ensures the machines will be consistent laundry performers for years to come.

Strength

A heavy-duty suspension system absorbs vibrations without the need for special foundations. Reinforced stainless steel side panels and oversized door and hinges contribute to durability and a long life for the machine.

Power

High G-Force extraction speeds of between 350 and 400 G-Force deliver exceptional power to remove more water from loads and reduce drying time – combining for increased throughput.

Performance

Available in a variety of capacities, including 20 lb, 25 lb, 30 lb, 40 lb, 55 lb, 70 lb, 90 lb and 125 lb Huebsch has a softmount washer-extractor model to meet the needs of any on-premises laundry.



HC200

The HC200 Control provides up to 99 cycle programs. Versatile and easy to use, the advanced computer control meets a variety of specialized needs. With more than 20 languages available, our HC200 is intuitive for bilingual operators. Users can easily follow the status of every phase of the wash cycle and modify data and parameters at any time to monitor for maximum efficiency.

On-Premises 125-lb Softmount Washer-Extractor Specifications

MODEL		HY125
CONTROL OPTION		HC200
CAPACITY - lb (kg)		125 (55)
OVERALL WIDTH - in (mm)		47.04 (1195)
OVERALL DEPTH - in (mm)		63.39 (1610)
OVERALL HEIGHT - in (mm)		75 (1905)
CYLINDER DIAMETER - in (mm)		36 (914)
CYLINDER DEPTH - in (mm)		31.1 (790)
CYLINDER VOLUME - cu. ft. (liters)		18.3 (518)
DOOR OPENING SIZE - in (mm)		21.3 (540)
DOOR BOTTOM TO FLOOR - in (mm)		28.74 (730)
WASH SPEED - RPM		38
EXTRACT SPEED - RPM		830
EXTRACT G-FORCE		350
WATER INLET CONNECTION - in (mm)		3 x 1 (25)
STEAM INLET CONNECTION - in (mm)		0.75 (19)
DRAIN DIAMETER - in (mm)		2 x 3 (76)
MOTOR POWER CONSUMPTION - hp (kw)		10.06 (7.50)
VOLTAGE/ CIRCUIT BREAKER - FLA*	No Heat	
	200-240/50/60/3	40-28
	440-480/50/60/3	20-16
	Heat	
	200-240/50/60/3	160-147
	440-480/50/60/3	100-79
SHIPPING DIMEN- SIONS APPROX. - in (mm)	Width	56.3 (1430)
	Depth	68.9 (1750)
	Height	82.9 (2105)
NET WEIGHT - lb (kg)		3594 (1630)
SHIPPING WEIGHT - lb (kg)		3902 (1770)
AGENCY APPROVALS		CSA

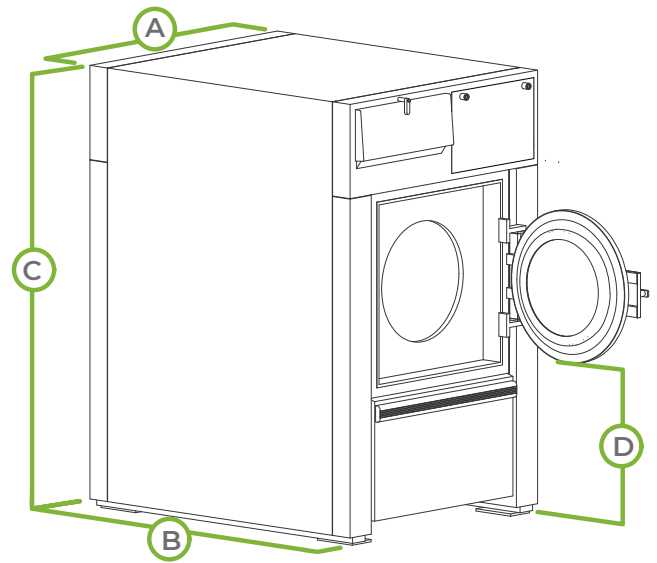

MODEL	HY125
A. OVERALL WIDTH - in (mm)	47.04 (1195)
B. OVERALL DEPTH - in (mm)	63.39 (1610)
C. OVERALL HEIGHT - in (mm)	75 (1905)
D. DOOR BOTTOM TO FLOOR - in (mm)	28.74 (730)

* Circuit breaker and amp draw data shown are for models without electric heat. Consult factory for other configurations. Manufacturing strongly recommends using a circuit breaker instead of fuses.

For the most accurate information, the installation guide should be used for all design and construction purposes. Due to continuous product improvements, design and specifications subject to change without notice. The quality management system of Alliance Laundry Systems has been registered to ISO 9001.

On-Premises 20-lb Hardmount Washer-Extractor



Maximized throughput, minimized costs. That's what busy on-premises laundries demand. Huebsch® hardmount washer-extractors deliver those results, while producing exceptional finished wash quality. In addition, their durability ensures the machines will be consistent laundry performers for years to come.

Strength

Our computer-optimized, heavy-duty frame is lighter, lasts longer, balances loads more efficiently, and reduces sound and vibration levels. Huebsch washer-extractors also boast two triple-lip seals and an excluder-face seal for seven layers of bearing protection.

Performance

Available in a variety of capacities, including 20 lb, 30 lb, 40 lb, 60 lb, 80 lb and 100 lb capacities, Huebsch cabinet hardmount washer-extractors also offer a variety of control options to match your operation's unique requirements.

Power

Proprietary inverter-drive technology provides smooth, reliable power, saving you 33% on electricity while maximizing cleaning power. Our inverter also exerts 200 G-Force extraction to remove more moisture from loads and reduce drying time.



Galaxy™ with eBoost™

Customize your washing power with the ability to choose between three water levels while eliminating wasted water with advanced leak detection. PC programming, audit data retrieval and advanced diagnostics save time, while 200 G-Force extraction speeds reduce drying time and utility consumption.

On-Premises 20-lb Hardmount Washer-Extractor Specifications

MODEL		HCT020	
CONTROL OPTION		Galaxy	
CAPACITY - lb (kg)		20 (9)	
OVERALL WIDTH - in (mm)		26 (660)	
*OVERALL DEPTH - in (mm)		30 1/4 (767)	
OVERALL HEIGHT - in (mm)		43 (1092)	
CYLINDER DIAMETER - in (mm)		21 (533)	
CYLINDER DEPTH - in (mm)		13 3/4 (349)	
CYLINDER VOLUME - cu. ft. (liters)		2.76 (78.1)	
DOOR OPENING SIZE - in (mm)		11 5/8 (295)	
DOOR BOTTOM TO FLOOR - in (mm)		14 3/8 (365)	
WATER INLET CONNECTION - in (mm)		2 x 3/4 (19)	
DRAIN DIAMETER - in (mm)		1 x 3 (76)	
DRAIN HEIGHT TO FLOOR - in (mm)		4 1/2 (114)	
MOTOR POWER CONSUMPTION - hp (kw)		1 (.75)	
TOTAL # OF SPEEDS		6, 9	
CYLINDER SPEEDS - RPM (G-FORCE)	Gentle	37 (0.4)	
	Wash	51 (.8)	
	Distribution	92 (2.5)	
	Very Low	301 (27)	
	Low	518 (80)	
	Medium	580 (100)	
	** High	648 (120)	
	**Very High	710 (150)	
	**Ultra High	819 (200)	
*** VOLTAGE/ CIRCUIT BREAK- ER - FLA	B	120/60/1	15-8
	X	200-208/220- 240/50/60/1/3	15-4 (1 Ph) 15-3 (3 Ph)
	N	440-480/50/60/3	15-2
SHIPPING DIMENSIONS APPROX. - in (mm)	Width	28 (711)	
	Depth	33 13/16 (859)	
	Height	48 7/16 (1229)	
NET WEIGHT - lb (kg)		335 (152)	
SHIPPING WEIGHT - lb (kg)		365 (166)	
***AGENCY APPROVALS		cUL _{us}	

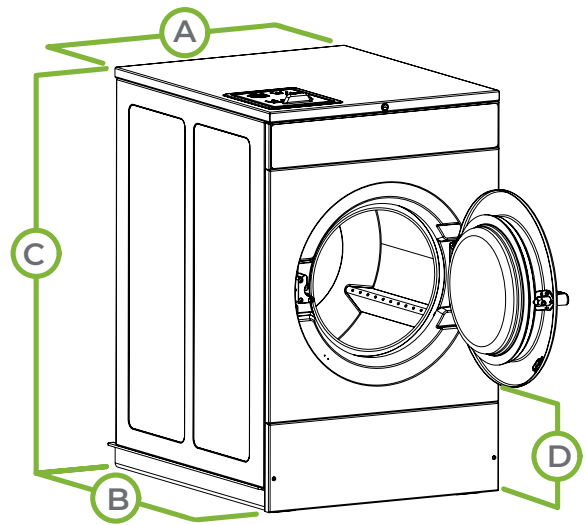

MODEL	HCT020	
A. OVERALL WIDTH - in (mm)	26 (660)	
B. *OVERALL DEPTH - in (mm)	30 1/4 (767)	
C. OVERALL HEIGHT - in (mm)	43 (1092)	
D. DOOR BOTTOM TO FLOOR - in (mm)	14 3/8 (365)	

*Overall depth includes vacuum breaker to door handle.

**High, Very High, and Ultra High Spin Speeds are available on the Galaxy 400 models only.

***Circuit breaker and amp draw data shown are for models without electric heat. Consult factory for other configurations. Manufacturer strongly recommends using a circuit breaker instead of fuses. Use 3-pole circuit breakers for 3-phase machines.

****Agency approvals may vary depending on configuration. Consult factory for details. Steam connection requires 1/2" N.P.T.

For the most accurate information, the installation guide should be used for all design and construction purposes. Due to continuous product improvements, design and specifications subject to change without notice. The quality management systems at Alliance Laundry Systems are registered to ISO 9001.

On-Premises 30-lb Hardmount Washer-Extractor



Maximized throughput, minimized costs. That's what busy on-premises laundries demand. Huebsch® hardmount washer-extractors deliver those results, while producing exceptional finished wash quality. In addition, their durability ensures the machines will be consistent laundry performers for years to come.

Strength

Our computer-optimized, heavy-duty frame is lighter, lasts longer, balances loads more efficiently, and reduces sound and vibration levels. Huebsch washer-extractors also boast two triple-lip seals and an excluder-face seal for seven layers of bearing protection.

Power

Proprietary inverter-drive technology provides smooth, reliable power, saving you 33% on electricity while maximizing cleaning power. Our inverter also exerts 200 G-Force extraction to remove more moisture from loads and reduce drying time.

Performance

Available in a variety of capacities, including 20 lb, 30 lb, 40 lb, 60 lb, 80 lb and 100 lb capacities, Huebsch cabinet hardmount washer-extractors also offer a variety of control options to match your operation's unique requirements.



Galaxy™ with eBoost™

Customize your washing power with the ability to choose between three water levels while eliminating wasted water with advanced leak detection. PC programming, audit data retrieval and advanced diagnostics save time, while 200 G-Force extraction speeds reduce drying time and utility consumption.

On-Premises **30-lb Hardmount Washer-Extractor** Specifications

MODEL		HCT030	
CONTROL OPTION		Galaxy	
CAPACITY - lb (kg)		30 (13.6)	
OVERALL WIDTH - in (mm)		29 (737)	
*OVERALL DEPTH - in (mm)		34 9/16 (878)	
OVERALL HEIGHT - in (mm)		45 (1142)	
CYLINDER DIAMETER - in (mm)		24 (610)	
CYLINDER DEPTH - in (mm)		16 (406)	
CYLINDER VOLUME - cu. ft. (liters)		4.19 (118)	
DOOR OPENING SIZE - in (mm)		14 5/16 (364)	
DOOR BOTTOM TO FLOOR - in (mm)		14 (356)	
WATER INLET CONNECTION - in (mm)		2 x 3/4 (19)	
DRAIN DIAMETER - in (mm)		1 x 3 (76)	
DRAIN HEIGHT TO FLOOR - in (mm)		4 1/2 (114)	
MOTOR POWER CONSUMPTION - hp (kw)		1 (.75)	
TOTAL # OF SPEEDS		6, 9	
CYLINDER SPEEDS - RPM (G-FORCE)	Gentle	34 (0.4)	
	Wash	48 (.8)	
	Distribution	86 (2.5)	
	Very Low	282 (27)	
	Low	485 (80)	
	Medium	542 (100)	
	** High	606 (120)	
	**Very High	664 (150)	
	**Ultra High	766 (200)	
*** VOLTAGE/ CIRCUIT BREAKER - FLA	B	120/60/1	20-16
	X	200-208/220- 240/50/60/1/3	15-6 (1 Ph) 15-4 (3 Ph)
	N	440-480/50/60/3	15-3
SHIPPING DIMENSIONS APPROX. - in (mm)	Width	31 1/2 (800)	
	Depth	38 5/16 (973)	
	Height	51 5/16 (1303)	
NET WEIGHT - lb (kg)		460 (209)	
SHIPPING WEIGHT - lb (kg)		495 (225)	
***AGENCY APPROVALS		cUL _{us}	

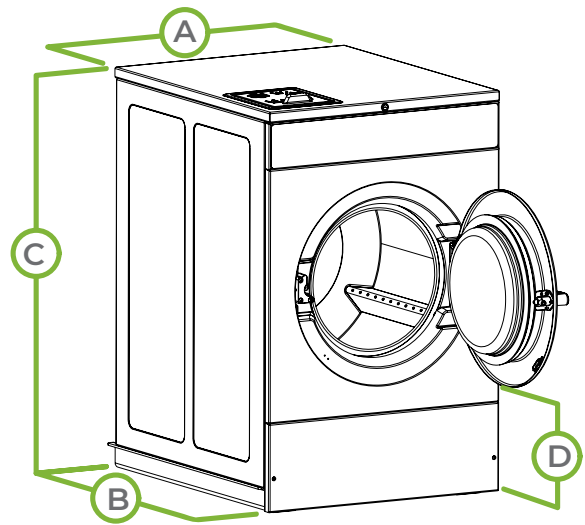

MODEL	HCT030
A. OVERALL WIDTH - in (mm)	29 (737)
B. *OVERALL DEPTH - in (mm)	34 9/16 (878)
C. OVERALL HEIGHT - in (mm)	45 (1142)
D. DOOR BOTTOM TO FLOOR - in (mm)	14 (356)

*Overall depth includes vacuum breaker to door handle.

**High, Very High, and Ultra High Spin Speeds are available on the Galaxy 400 models only.

***Circuit breaker and amp draw data shown are for models without electric heat. Consult factory for other configurations. Manufacturer strongly recommends using a circuit breaker instead of fuses. Use 3-pole circuit breakers for 3-phase machines.

****Agency approvals may vary depending on configuration. Consult factory for details. Steam connection requires 1/2" N.P.T.

For the most accurate information, the installation guide should be used for all design and construction purposes. Due to continuous product improvements, design and specifications subject to change without notice. The quality management systems at Alliance Laundry Systems are registered to ISO 9001.

On-Premises 40-lb Hardmount Washer-Extractor



Maximized throughput, minimized costs. That's what busy on-premises laundries demand. Huebsch® hardmount washer-extractors deliver those results, while producing exceptional finished wash quality. In addition, their durability ensures the machines will be consistent laundry performers for years to come.

Strength

Our computer-optimized, heavy-duty frame is lighter, lasts longer, balances loads more efficiently, and reduces sound and vibration levels. Huebsch washer-extractors also boast two triple-lip seals and an excluder-face seal for seven layers of bearing protection.

Power

Proprietary inverter-drive technology provides smooth, reliable power, saving you 33% on electricity while maximizing cleaning power. Our inverter also exerts 200 G-Force extraction to remove more moisture from loads and reduce drying time.

Performance

Available in a variety of capacities, including 20 lb, 30 lb, 40 lb, 60 lb, 80 lb and 100 lb capacities, Huebsch cabinet hardmount washer-extractors also offer a variety of control options to match your operation's unique requirements.



Galaxy™ with eBoost™

Customize your washing power with the ability to choose between three water levels while eliminating wasted water with advanced leak detection. PC programming, audit data retrieval and advanced diagnostics save time, while 200 G-Force extraction speeds reduce drying time and utility consumption.

On-Premises 40-lb Hardmount Washer-Extractor Specifications

MODEL		HCT040	
CONTROL OPTION		Galaxy	
CAPACITY - lb (kg)		40 (18)	
OVERALL WIDTH - in (mm)		30 5/8 (778)	
*OVERALL DEPTH - in (mm)		39 3/4 (1009)	
OVERALL HEIGHT - in (mm)		47 1/4 (1199)	
CYLINDER DIAMETER - in (mm)		26 1/4 (667)	
CYLINDER DEPTH - in (mm)		20 1/4 (514)	
CYLINDER VOLUME - cu. ft. (liters)		6.34 (180)	
DOOR OPENING SIZE - in (mm)		16 1/4 (413)	
DOOR BOTTOM TO FLOOR - in (mm)		14 1/2 (368)	
WATER INLET CONNECTION - in (mm)		2 x 3/4 (19)	
DRAIN DIAMETER - in (mm)		1 x 3 (76)	
DRAIN HEIGHT TO FLOOR - in (mm)		4 13/16 (122)	
MOTOR POWER CONSUMPTION - hp (kw)		2 (1.7)	
TOTAL # OF SPEEDS		6, 9	
CYLINDER SPEEDS - RPM (G-FORCE)	Gentle	33 (0.4)	
	Wash	46 (.8)	
	Distribution	82 (2.5)	
	Very Low	269 (27)	
	Low	464 (80)	
	Medium	518 (100)	
	** High	579 (120)	
	**Very High	635 (150)	
	**Ultra High	733 (200)	
*** VOLTAGE/ CIRCUIT BREAKER - FLA	B	120/60/1	20-16
	X	200-208/220- 240/50/60/1/3	15-7 (1 Ph) 15-4 (3 Ph)
	N	440-480/50/60/3	15-3
SHIPPING DIMENSIONS APPROX. - in (mm)	Width	32 1/2 (826)	
	Depth	43 1/2 (1105)	
	Height	53 5/8 (1361)	
NET WEIGHT - lb (kg)		550 (249)	
SHIPPING WEIGHT - lb (kg)		590 (268)	
***AGENCY APPROVALS		cUL _{us}	

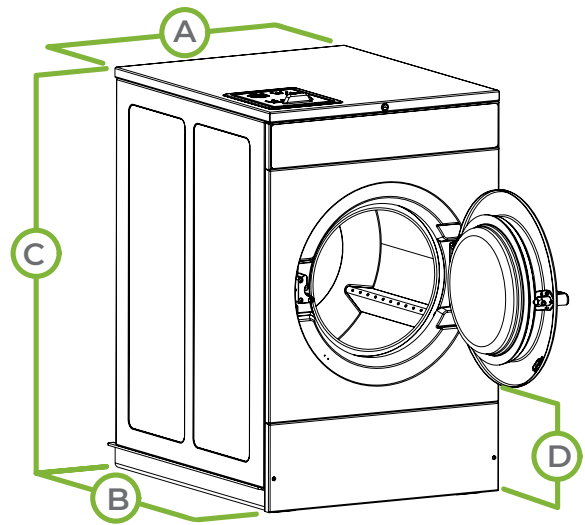

MODEL	HCT040	
A. OVERALL WIDTH - in (mm)	30 5/8 (778)	
B. *OVERALL DEPTH - in (mm)	39 3/4 (1009)	
C. OVERALL HEIGHT - in (mm)	47 1/4 (1199)	
D. DOOR BOTTOM TO FLOOR - in (mm)	14 1/2 (368)	

*Overall depth includes vacuum breaker to door handle.

**High, Very High, and Ultra High Spin Speeds are available on the Galaxy 400 models only.

***Circuit breaker and amp draw data shown are for models without electric heat. Consult factory for other configurations. Manufacturer strongly recommends using a circuit breaker instead of fuses. Use 3-pole circuit breakers for 3-phase machines.

****Agency approvals may vary depending on configuration. Consult factory for details. Steam connection requires 1/2" N.P.T.

For the most accurate information, the installation guide should be used for all design and construction purposes. Due to continuous product improvements, design and specifications subject to change without notice. The quality management systems at Alliance Laundry Systems are registered to ISO 9001.

On-Premises 60-lb Hardmount Washer-Extractor



Maximized throughput, minimized costs. That's what busy on-premises laundries demand. Huebsch® hardmount washer-extractors deliver those results, while producing exceptional finished wash quality. In addition, their durability ensures the machines will be consistent laundry performers for years to come.

Strength

Our computer-optimized, heavy-duty frame is lighter, lasts longer, balances loads more efficiently, and reduces sound and vibration levels. Huebsch washer-extractors also boast two triple-lip seals and an excluder-face seal for seven layers of bearing protection.

Power

Proprietary inverter-drive technology provides smooth, reliable power, saving you 33% on electricity while maximizing cleaning power. Our inverter also exerts 200 G-Force extraction to remove more moisture from loads and reduce drying time.

Performance

Available in a variety of capacities, including 20 lb, 30 lb, 40 lb, 60 lb, 80 lb and 100 lb capacities, Huebsch cabinet hardmount washer-extractors also offer a variety of control options to match your operation's unique requirements.



Galaxy™ with eBoost™

Customize your washing power with the ability to choose between three water levels while eliminating wasted water with advanced leak detection. PC programming, audit data retrieval and advanced diagnostics save time, while 200 G-Force extraction speeds reduce drying time and utility consumption.

On-Premises 60-lb Hardmount Washer-Extractor Specifications

MODEL		HCT060	
CONTROL OPTION		Galaxy	
CAPACITY - lb (kg)		60 (27)	
OVERALL WIDTH - in (mm)		34 1/16 (865)	
*OVERALL DEPTH - in (mm)		42 9/16 (1081)	
OVERALL HEIGHT - in (mm)		49 7/8 (1267)	
CYLINDER DIAMETER - in (mm)		30 (762)	
CYLINDER DEPTH - in (mm)		22 (559)	
CYLINDER VOLUME - cu. ft. (liters)		9.0 (255)	
DOOR OPENING SIZE - in (mm)		16 1/4 (413)	
DOOR BOTTOM TO FLOOR - in (mm)		14 15/16 (379)	
WATER INLET CONNECTION - in (mm)		2 x 3/4 (19)	
DRAIN DIAMETER - in (mm)		1 x 3 (76)	
DRAIN HEIGHT TO FLOOR - in (mm)		4 11/16 (119)	
MOTOR POWER CONSUMPTION - hp (kw)		3 (2.2)	
TOTAL # OF SPEEDS		6, 9	
CYLINDER SPEEDS - RPM (G-FORCE)	Gentle	31 (0.4)	
	Wash	43 (.8)	
	Distribution	77 (2.5)	
	Very Low	252 (27)	
	Low	434 (80)	
	Medium	485 (100)	
	** High	542 (120)	
	**Very High	594 (150)	
	**Ultra High	686 (200)	
*** VOLTAGE/ CIRCUIT BREAKER - FLA	X	200-208/220- 240/50/60/1/3	15-10 (1 Ph) 15-6 (3 Ph)
	N	440-480/50/60/3	15-4
SHIPPING DIMENSIONS APPROX. - in (mm)	Width	37 1/2 (953)	
	Depth	46 15/16 (1191)	
	Height	56 5/16 (1430)	
NET WEIGHT - lb (kg)		695 (315)	
SHIPPING WEIGHT - lb (kg)		745 (338)	
****AGENCY APPROVALS		c UL _{US}	

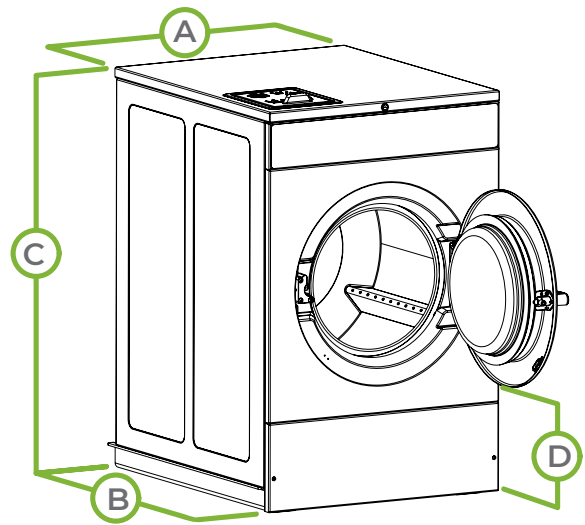

MODEL	HCT060
A. OVERALL WIDTH - in (mm)	34 1/16 (865)
B. *OVERALL DEPTH - in (mm)	42 9/16 (1081)
C. OVERALL HEIGHT - in (mm)	49 7/8 (1267)
D. DOOR BOTTOM TO FLOOR - in (mm)	14 15/16 (379)

*Overall depth includes vacuum breaker to door handle.

**High, Very High, and Ultra High Spin Speeds are available on the Galaxy 400 models only.

***Circuit breaker and amp draw data shown are for models without electric heat. Consult factory for other configurations. Manufacturer strongly recommends using a circuit breaker instead of fuses. Use 3-pole circuit breakers for 3-phase machines.

****Agency approvals may vary depending on configuration. Consult factory for details. Steam connection requires 1/2" N.P.T.

For the most accurate information, the installation guide should be used for all design and construction purposes. Due to continuous product improvements, design and specifications subject to change without notice. The quality management systems at Alliance Laundry Systems are registered to ISO 9001.

On-Premises 80-lb Hardmount Washer-Extractor



Maximized throughput, minimized costs. That's what busy on-premises laundries demand. Huebsch® hardmount washer-extractors deliver those results, while producing exceptional finished wash quality. In addition, their durability ensures the machines will be consistent laundry performers for years to come.

Strength

Our computer-optimized, heavy-duty frame is lighter, lasts longer, balances loads more efficiently, and reduces sound and vibration levels. Huebsch washer-extractors also boast two triple-lip seals and an excluder-face seal for seven layers of bearing protection.

Power

Proprietary inverter-drive technology provides smooth, reliable power, saving you 33% on electricity while maximizing cleaning power. Our inverter also exerts 200 G-Force extraction to remove more moisture from loads and reduce drying time.

Performance

Available in a variety of capacities, including 20 lb, 30 lb, 40 lb, 60 lb, 80 lb and 100 lb capacities, Huebsch cabinet hardmount washer-extractors also offer a variety of control options to match your operation's unique requirements.



Galaxy™ with eBoost™

Customize your washing power with the ability to choose between three water levels while eliminating wasted water with advanced leak detection. PC programming, audit data retrieval and advanced diagnostics save time, while 200 G-Force extraction speeds reduce drying time and utility consumption.

On-Premises 80-lb Hardmount Washer-Extractor Specifications

MODEL		HCT080	
CONTROL OPTION		Galaxy	
CAPACITY - lb (kg)		80 (36)	
OVERALL WIDTH - in (mm)		41 1/2 (1054)	
*OVERALL DEPTH - in (mm)		48 1/2 (1234)	
OVERALL HEIGHT - in (mm)		56 3/16 (1426)	
CYLINDER DIAMETER - in (mm)		36 (916)	
CYLINDER DEPTH - in (mm)		22 (559)	
CYLINDER VOLUME - cu. ft. (liters)		12.4 (354)	
DOOR OPENING SIZE - in (mm)		18 1/2 (470)	
DOOR BOTTOM TO FLOOR - in (mm)		17 15/16 (455)	
WATER INLET CONNECTION - in (mm)		2 x 3/4 (19)	
DRAIN DIAMETER - in (mm)		1 x 3 (76)	
DRAIN HEIGHT TO FLOOR - in (mm)		5 3/4 (145)	
MOTOR POWER CONSUMPTION - hp (kw)		5 (3.7)	
TOTAL # OF SPEEDS		6, 9	
CYLINDER SPEEDS - RPM (G-FORCE)	Gentle	28 (0.4)	
	Wash	39 (.8)	
	Distribution	70 (2.5)	
	Very Low	230 (27)	
	Low	396 (80)	
	Medium	443 (100)	
	** High	495 (120)	
	**Very High	542 (150)	
	**Ultra High	626 (200)	
*** VOLTAGE/ CIRCUIT BREAKER - FLA	X	200-208/220- 240/50/60/1/3	15-12 (1 Ph) 15-8 (3 Ph)
	N	440-480/50/60/3	15-5
SHIPPING DIMENSIONS APPROX. - in (mm)	Width	44 (1118)	
	Depth	54 1/2 (1384)	
	Height	58 5/8 (1488)	
NET WEIGHT - lb (kg)		1210 (549)	
SHIPPING WEIGHT - lb (kg)		1260 (572)	
****AGENCY APPROVALS		c UL _{US}	

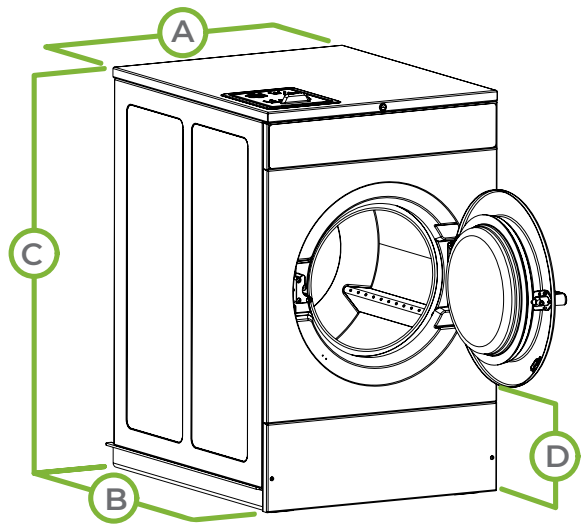

MODEL	HCT080
A. OVERALL WIDTH - in (mm)	41 1/2 (1054)
B. *OVERALL DEPTH - in (mm)	48 1/2 (1234)
C. OVERALL HEIGHT - in (mm)	56 3/16 (1426)
D. DOOR BOTTOM TO FLOOR - in (mm)	17 15/16 (455)

*Overall depth includes vacuum breaker to door handle.

**High, Very High, and Ultra High Spin Speeds are available on the Galaxy 400 models only.

***Circuit breaker and amp draw data shown are for models without electric heat. Consult factory for other configurations. Manufacturer strongly recommends using a circuit breaker instead of fuses. Use 3-pole circuit breakers for 3-phase machines.

****Agency approvals may vary depending on configuration. Consult factory for details. Steam connection requires 1/2" N.P.T.

For the most accurate information, the installation guide should be used for all design and construction purposes. Due to continuous product improvements, design and specifications subject to change without notice. The quality management systems at Alliance Laundry Systems are registered to ISO 9001.

On-Premises 100-lb Hardmount Washer-Extractor



Maximized throughput, minimized costs. That's what busy on-premises laundries demand. Huebsch® hardmount washer-extractors deliver those results, while producing exceptional finished wash quality. In addition, their durability ensures the machines will be consistent laundry performers for years to come.

Strength

Our computer-optimized, heavy-duty frame is lighter, lasts longer, balances loads more efficiently, and reduces sound and vibration levels. Huebsch washer-extractors also boast two triple-lip seals and an excluder-face seal for seven layers of bearing protection.

Power

Proprietary inverter-drive technology provides smooth, reliable power, saving you 33% on electricity while maximizing cleaning power. Our inverter also exerts 200 G-Force extraction to remove more moisture from loads and reduce drying time.

Performance

Available in a variety of capacities, including 20 lb, 30 lb, 40 lb, 60 lb, 80 lb and 100 lb capacities, Huebsch cabinet hardmount washer-extractors also offer a variety of control options to match your operation's unique requirements.



Galaxy™ with eBoost™

Customize your washing power with the ability to choose between three water levels while eliminating wasted water with advanced leak detection. PC programming, audit data retrieval and advanced diagnostics save time, while 200 G-Force extraction speeds reduce drying time and utility consumption.

On-Premises 100-lb Hardmount Washer-Extractor Specifications

MODEL		HCT100	
CONTROL OPTION		Galaxy	
CAPACITY - lb (kg)		100 (45)	
OVERALL WIDTH - in (mm)		41 1/2 (1054)	
*OVERALL DEPTH - in (mm)		52 1/2 (1336)	
OVERALL HEIGHT - in (mm)		56 3/16 (1426)	
CYLINDER DIAMETER - in (mm)		36 (916)	
CYLINDER DEPTH - in (mm)		26 (610)	
CYLINDER VOLUME - cu. ft. (liters)		13.5 (434)	
DOOR OPENING SIZE - in (mm)		18 1/2 (470)	
DOOR BOTTOM TO FLOOR - in (mm)		17 15/16 (455)	
WATER INLET CONNECTION - in (mm)		2 x 3/4 (19)	
DRAIN DIAMETER - in (mm)		1 x 3 (76)	
DRAIN HEIGHT TO FLOOR - in (mm)		5 3/4 (145)	
MOTOR POWER CONSUMPTION - hp (kw)		5 (3.7)	
TOTAL # OF SPEEDS		6, 9	
CYLINDER SPEEDS - RPM (G-FORCE)	Gentle	28 (0.4)	
	Wash	39 (.8)	
	Distribution	70 (2.5)	
	Very Low	230 (27)	
	Low	396 (80)	
	Medium	443 (100)	
	** High	495 (120)	
	**Very High	542 (150)	
	**Ultra High	568 (165)	
*** VOLTAGE/ CIRCUIT BREAKER - FLA	X	200-208/220- 240/50/60/1/3	20-16 (1 Ph) 15-10 (3 Ph)
	N	440-480/50/60/3	15-7
SHIPPING DIMENSIONS APPROX. - in (mm)	Width	44 (1118)	
	Depth	58 1/2 (1486)	
	Height	58 5/8 (1488)	
NET WEIGHT - lb (kg)		1260 (572)	
SHIPPING WEIGHT - lb (kg)		1310 (594)	
****AGENCY APPROVALS		c UL _{US}	

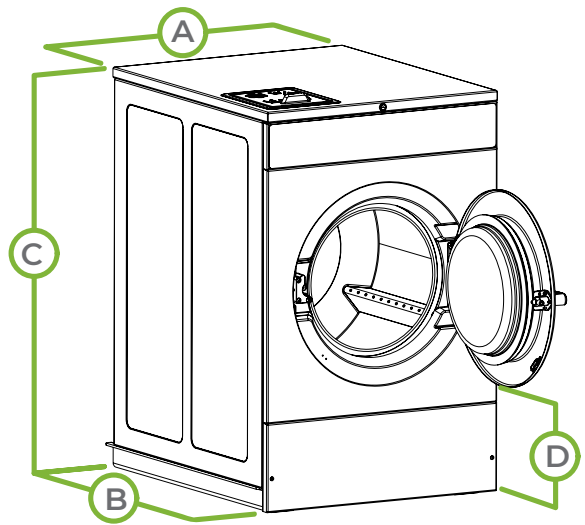

MODEL	HCT100
A. OVERALL WIDTH - in (mm)	41 1/2 (1054)
B. *OVERALL DEPTH - in (mm)	52 1/2 (1336)
C. OVERALL HEIGHT - in (mm)	56 3/16 (1426)
D. DOOR BOTTOM TO FLOOR - in (mm)	17 15/16 (455)

*Overall depth includes vacuum breaker to door handle.

**High, Very High, and Ultra High Spin Speeds are available on the Galaxy 400 models only.

***Circuit breaker and amp draw data shown are for models without electric heat. Consult factory for other configurations. Manufacturer strongly recommends using a circuit breaker instead of fuses. Use 3-pole circuit breakers for 3-phase machines.

****Agency approvals may vary depending on configuration. Consult factory for details. Steam connection requires 1/2" N.P.T.

For the most accurate information, the installation guide should be used for all design and construction purposes. Due to continuous product improvements, design and specifications subject to change without notice. The quality management systems at Alliance Laundry Systems are registered to ISO 9001.

On-Premises I10 Heated Roll Ironer

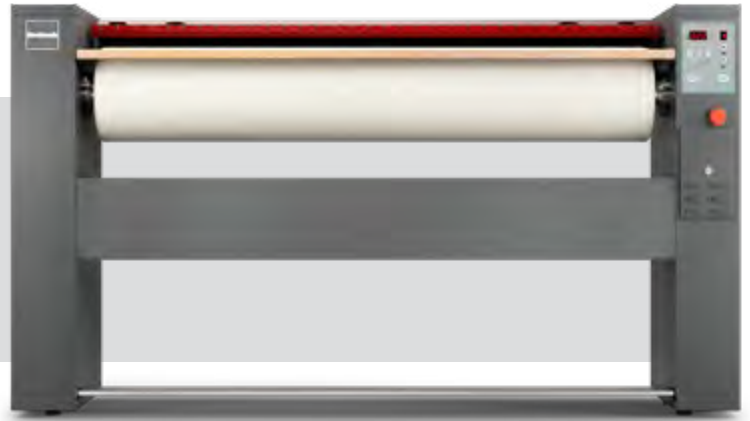

When only the highest quality results will do, our heated-cylinder finishers deliver. They are equipped with a frequency-controlled motor, suspended roll and Nomex® ironing belts to deliver top-of-the-industry results.

Quality

Huebsch Heated Roll Ironers are offered in finished widths of 55 (1400 mm), 66 (1664 mm), 79 (2000 mm), 82 (2080 mm), 102 (2600 mm) and 126 (3200 mm) inches meaning there's a size to fit the needs of any size laundry.

Efficient

Thick, polished-steel cylinders maintain even heat and help make the finishers highly efficient. A totally enclosed cabinet also contributes to its energy efficiency.



Microprocessor Control

Huebsch's versatile Microprocessor Control enables you to store temperature and speed settings to ensure consistent, top-quality results. Temperatures can be set up to 355°F and the unit offers multiple speed settings.

On-Premises I10 Heated Roll Ironer Specifications

SPECIFICATIONS

MODEL		I10-55
AVAILABLE CONTROL		Microprocessor
ROLL DIAMETER - in (mm)		10 (254)
FINISHING WIDTH - in (mm)		55 (1400)
IRONING SPEED - ft/m (m/m)		7-13 (2-4)
IRONER DIMENSIONS (working position) - in (mm)	Width	70 7/8 (1800)
	Depth	16 1/2 (420)
	Height	39 5/8 (1005)
ROLL MOTOR - HP (kw)		0.29 (0.215)
ROLL EXHAUST DUCT - in (mm)		2.17 (55)
E Heat Input Power - HP (kW)		11.3 (8.4)
ELECTRIC HEATING	Electric Requirements - Circuit Breaker	230/60/3 - 25
SHIPPING DIMENSIONS APPROX. - in (mm)	Width	45 1/4 (1150)
	Depth	74 (1880)
	Height	19 11/16 (500)
NET WEIGHT - lb (kg)		328 (149)
SHIPPING WEIGHT - lb (kg)		287 (130)
AGENCY APPROVALS		ETL

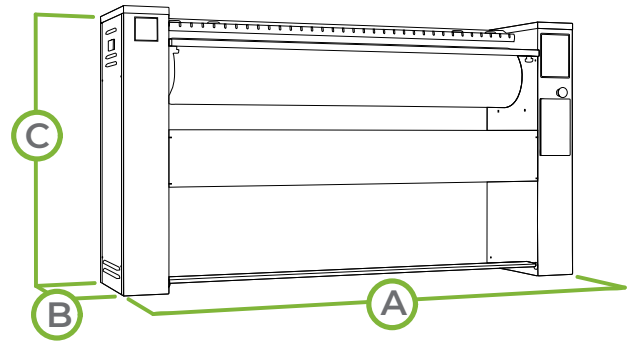

DIMENSIONS

A. OVERALL WIDTH - in (mm)	70 7/8 (1800)
B. OVERALL DEPTH - in (mm)	16 1/2 (420)
C. OVERALL HEIGHT - in (mm)	39 5/8 (1005)

For the most accurate information, the installation guide should be used for all design and construction purposes. Due to continuous product improvements, design and specifications subject to change without notice. The quality management system of Alliance Laundry Systems has been registered to ISO 9001.

On-Premises **FCU13-66** Heated Roll Ironer



When only the highest quality results will do, our heat-ed-cylinder finishers deliver. They are equipped with a frequency-controlled motor, suspended roll and Nomex® ironing belts to deliver top-of-the-industry results.

Quality

Huebsch Heated Roll Ironers are offered in finished widths of 55 (1400 mm), 66 (1664 mm), 79 (2000 mm), 82 (2080 mm), 102 (2600 mm) and 126 (3200 mm) inches meaning there's a size to fit the needs of any size laundry.

Efficient

Thick, polished-steel cylinders maintain even heat and help make the finishers highly efficient. A totally enclosed cabinet also contributes to its energy efficiency.

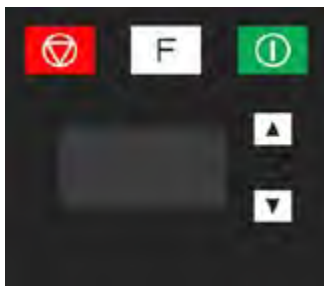

Microprocessor Control

Huebsch's versatile Microprocessor Control enables you to store temperature and speed settings to ensure consistent, top-quality results. Temperatures can be set up to 355°F and the unit offers multiple speed settings.

On-Premises FCU13-66 Heated Roll Ironer Specifications

SPECIFICATIONS

MODEL	FCU13-66	
AVAILABLE CONTROL	Microprocessor	
ROLL DIAMETER - in (mm)	13 (320)	
FINISHING WIDTH - in (mm)	66 (1664)	
IRONING SPEED - ft/m (m/m)	3-20 (1-6)	
IRONER DIMENSIONS (working position) - in (mm)	Width	86 1/2 (2194)
	Depth	30 (765)
	Height	43 3/4 (1110)
ROLL MOTOR - HP (kw)	0.24 (0.18)	
ROLL EXHAUST MOTOR - HP (kw)	0.17 (0.125)	
ROLL EXHAUST DUCT - in (mm)	6 (150)	
ELECTRIC HEATING	E Heat Input Power - HP (kW)	24.3
	Electric Requirements - Circuit Breaker	230/60/3 - 80
GAS HEATING	Max. Gas Input - Btu (kW)	85,303 (25)
	Gas Inlet - in (mm)	3/4 (19)
	Electric Requirements - Circuit Breaker	120/60/1 - 15
SHIPPING WIDTH - in (mm)	86 1/4 (2190)	
SHIPPING DEPTH - in (mm)	31 1/2 (800)	
SHIPPING HEIGHT - in (mm)	49 5/8 (1260)	
SHIPPING WEIGHT - lb (kg)	Electric	1069 (485)
	Gas	1025 (465)
NET WEIGHT - lb (kg)	Electric	959 (435)
	Gas	904 (410)
AGENCY APPROVALS	CSA	

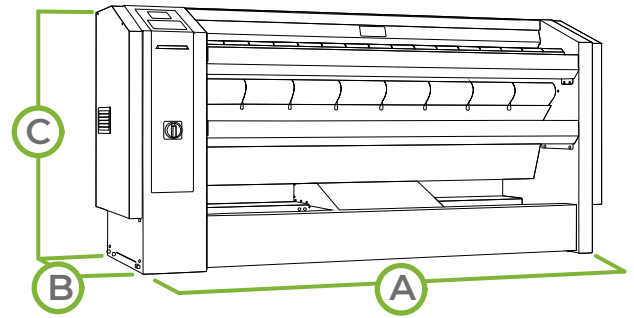

DIMENSIONS

A.	OVERALL WIDTH - in (mm)	86 1/2 (2194)
B.	OVERALL DEPTH - in (mm)	30 (765)
C.	OVERALL HEIGHT - in (mm)	43 3/4 (1110)

For the most accurate information, the installation guide should be used for all design and construction purposes. Due to continuous product improvements, design and specifications subject to change without notice. The quality management system of Alliance Laundry Systems has been registered to ISO 9001.

On-Premises **FCU13-82** Heated Roll Ironer



When only the highest quality results will do, our heat-ed-cylinder finishers deliver. They are equipped with a frequency-controlled motor, suspended roll and Nomex® ironing belts to deliver top-of-the-industry results.

Quality

Huebsch Heated Roll Ironers are offered in finished widths of 55 (1400 mm), 66 (1664 mm), 79 (2000 mm), 82 (2080 mm), 102 (2600 mm) and 126 (3200 mm) inches meaning there's a size to fit the needs of any size laundry.

Efficient

Thick, polished-steel cylinders maintain even heat and help make the finishers highly efficient. A totally enclosed cabinet also contributes to its energy efficiency.

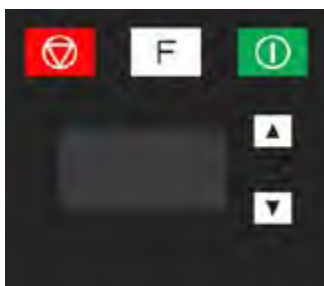

Microprocessor Control

Huebsch's versatile Microprocessor Control enables you to store temperature and speed settings to ensure consistent, top-quality results. Temperatures can be set up to 355°F and the unit offers multiple speed settings.

On-Premises FCU13-82 Heated Roll Ironer Specifications

SPECIFICATIONS

MODEL	FCU13-82	
AVAILABLE CONTROL	Microprocessor	
ROLL DIAMETER - in (mm)	13 (320)	
FINISHING WIDTH - in (mm)	82 (2080)	
IRONING SPEED - ft/m (m/m)	3-20 (1-6)	
IRONER DIMENSIONS (working position) - in (mm)	Width	102 3/4 (2610)
	Depth	30 (765)
	Height	43 3/4 (1110)
ROLL MOTOR - HP (kw)	0.24 (0.18)	
ROLL EXHAUST MOTOR - HP (kw)	0.17 (0.125)	
ROLL EXHAUST DUCT - in (mm)	6 (150)	
ELECTRIC HEATING	E Heat Input Power - HP (kW)	27.9
	Electric Requirements - Circuit Breaker	230/60/3 - 80
GAS HEATING	Max. Gas Input - Btu (kW)	102,364 (30)
	Gas Inlet - in (mm)	3/4 (19)
	Electric Requirements - Circuit Breaker	120/60/1 - 15
SHIPPING WIDTH - in (mm)	102 3/4 (2610)	
SHIPPING DEPTH - in (mm)	31 1/2 (800)	
SHIPPING HEIGHT - in (mm)	49 5/8 (1260)	
SHIPPING WEIGHT - lb (kg)	Electric	1235 (560)
	Gas	1191 (540)
NET WEIGHT - lb (kg)	Electric	1080 (490)
	Gas	1025 (465)
AGENCY APPROVALS	CSA	

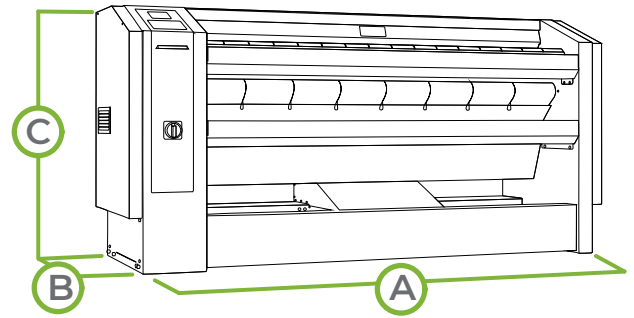

DIMENSIONS

A.	OVERALL WIDTH - in (mm)	102 3/4 (2610)
B.	OVERALL DEPTH - in (mm)	30 (765)
C.	OVERALL HEIGHT - in (mm)	43 3/4 (1110)

For the most accurate information, the installation guide should be used for all design and construction purposes. Due to continuous product improvements, design and specifications subject to change without notice. The quality management system of Alliance Laundry Systems has been registered to ISO 9001.

On-Premises **FCU20-102** Heated Roll Ironer



When only the highest quality results will do, our heat-ed-cylinder finishers deliver. They are equipped with a frequency-controlled motor, suspended roll and Nomex® ironing belts to deliver top-of-the-industry results.

Quality

Huebsch Heated Roll Ironers are offered in finished widths of 55 (1400 mm), 66 (1664 mm), 79 (2000 mm), 82 (2080 mm), 102 (2600 mm) and 126 (3200 mm) inches meaning there's a size to fit the needs of any size laundry.

Efficient

Thick, polished-steel cylinders maintain even heat and help make the finishers highly efficient. A totally enclosed cabinet also contributes to its energy efficiency.

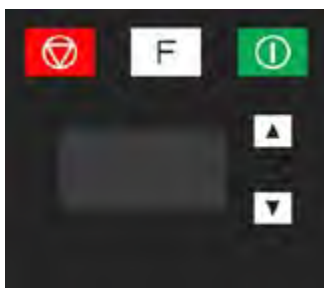

Microprocessor Control

Huebsch's versatile Microprocessor Control enables you to store temperature and speed settings to ensure consistent, top-quality results. Temperatures can be set up to 355°F and the unit offers multiple speed settings.

On-Premises FCU20-102 Heated Roll Ironer Specifications

SPECIFICATIONS

MODEL	FCU20-102	
AVAILABLE CONTROL	Microprocessor	
ROLL DIAMETER - in (mm)	20 (502)	
FINISHING WIDTH - in (mm)	102 (2600)	
IRONING SPEED - ft/m (m/m)	5-26 (1.5-8)	
IRONER DIMENSIONS (working position) - in (mm)	Width	132 (3350)
	Depth	42 3/4 (1087)
	Height	48 1/2 (1232)
ROLL MOTOR - HP (kw)	0.50 (0.37)	
ROLL EXHAUST MOTOR - HP (kw)	0.34 (2 x 0.255)	
ROLL EXHAUST DUCT - in (mm)	6 (2 x 150)	
ELECTRIC HEATING	E Heat Input Power - HP (kW)	54.0
	Electric Requirements - Circuit Breaker	230/60/3 - 175
GAS HEATING	Max. Gas Input - Btu (kW)	177,431 (52)
	Gas Inlet - in (mm)	3/4 (19)
	Electric Requirements - Circuit Breaker	230/60/3 - 15
SHIPPING WIDTH - in (mm)	137 1/4 (3485)	
SHIPPING DEPTH - in (mm)	43 (1095)	
SHIPPING HEIGHT - in (mm)	59 (1550)	
SHIPPING WEIGHT - lb (kg)	Electric	3483 (1580)
	Gas	3549 (1610)
NET WEIGHT - lb (kg)	Electric	2778 (1260)
	Gas	2844 (1290)
AGENCY APPROVALS	CSA	

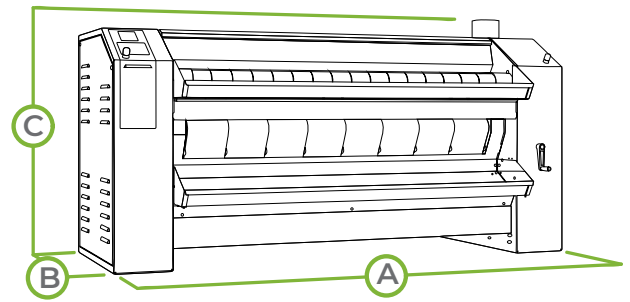

DIMENSIONS

A.	OVERALL WIDTH - in (mm)	132 (3350)
B.	OVERALL DEPTH - in (mm)	42 3/4 (1087)
C.	OVERALL HEIGHT - in (mm)	48 1/2 (1232)

For the most accurate information, the installation guide should be used for all design and construction purposes. Due to continuous product improvements, design and specifications subject to change without notice. The quality management system of Alliance Laundry Systems has been registered to ISO 9001.

On-Premises **FCU20-126** Heated Roll Ironer



When only the highest quality results will do, our heat-ed-cylinder finishers deliver. They are equipped with a frequency-controlled motor, suspended roll and Nomex® ironing belts to deliver top-of-the-industry results.

Quality

Huebsch Heated Roll Ironers are offered in finished widths of 55 (1400 mm), 66 (1664 mm), 79 (2000 mm), 82 (2080 mm), 102 (2600 mm) and 126 (3200 mm) inches meaning there's a size to fit the needs of any size laundry.

Efficient

Thick, polished-steel cylinders maintain even heat and help make the finishers highly efficient. A totally enclosed cabinet also contributes to its energy efficiency.

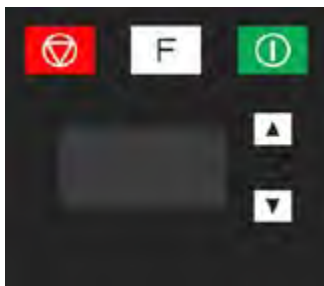

Microprocessor Control

Huebsch's versatile Microprocessor Control enables you to store temperature and speed settings to ensure consistent, top-quality results. Temperatures can be set up to 355°F and the unit offers multiple speed settings.

On-Premises FCU20-126 Heated Roll Ironer Specifications

SPECIFICATIONS

MODELS	FCU20-126	
AVAILABLE CONTROLS	Microprocessor	
ROLL DIAMETER - in (mm)	20 (502)	
FINISHING WIDTH - in (mm)	126 (3200)	
IRONING SPEED - ft/m (m/m)	5-26 (1.5-8)	
IRONER DIMENSIONS (working position) - in (mm)	Width	155 1/2 (3950)
	Depth	42 3/4 (1087)
	Height	48 1/2 (1232)
ROLL MOTOR - HP (kw)	0.50 (0.37)	
ROLL EXHAUST MOTOR - HP (kw)	0.34 (2 x 0.255)	
ROLL EXHAUST DUCT - in (mm)	6 (2 x 150)	
ELECTRIC HEATING	E Heat Input Power - HP (kW)	64.8
	Electric Requirements - Circuit Breaker	230/60/3 - 225
GAS HEATING	Max. Gas Input - Btu (kW)	255,201 (66)
	Gas Inlet - in (mm)	3/4 (19)
	Electric Requirements - Circuit Breaker	230/60/3 - 15
SHIPPING WIDTH - in (mm)	160 3/4 (4085)	
SHIPPING DEPTH - in (mm)	43 (1095)	
SHIPPING HEIGHT - in (mm)	59 (1550)	
SHIPPING WEIGHT - lb (kg)	Electric	4034 (1830)
	Gas	4299 (1950)
NET WEIGHT - lb (kg)	Electric	3241 (1470)
	Gas	3505 (1590)
AGENCY APPROVALS	CSA	

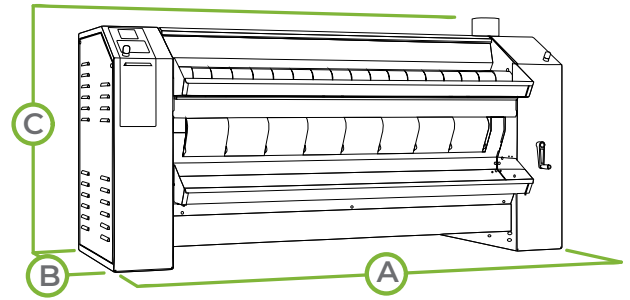

DIMENSIONS

A.	OVERALL WIDTH - in (mm)	155 1/2 (3950)
B.	OVERALL DEPTH - in (mm)	42 3/4 (1087)
C.	OVERALL HEIGHT - in (mm)	48 1/2 (1232)

For the most accurate information, the installation guide should be used for all design and construction purposes. Due to continuous product improvements, design and specifications subject to change without notice. The quality management system of Alliance Laundry Systems has been registered to ISO 9001.

On-Premises Firemen's PPE Drying Cabinet

Huebsch Firemen's PPE Drying Cabinets are engineered to comply with all NFPA 1851 regulations. Efficient drying processes help minimize utility and operating costs and cut drying times down to one-and-a-half to three hours — meaning gear will be ready for action whenever the alarm sounds.



Extra-Large Capacity

The spacious unit allows drying of six full sets of PPE gear (fire jacket, pants, and liners) and up to 15 boots or gloves at once. Optional racks are available for drying additional items such as hoses.

Quality

Durable construction delivers long-lasting, premium drying performance that stands up to the rough demands of your profession.

Efficient

An advanced airflow process sends heated air around and inside turnout gear for thorough, efficient drying.

Microprocessor Control

Huebsch's versatile Microprocessor Control enables you to store temperature and speed settings to ensure consistent, top-quality results.

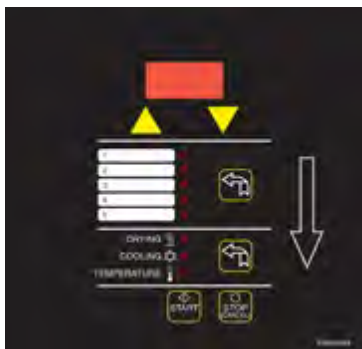

On-Premises Firemen's PPE Drying Cabinet Specifications

SPECIFICATIONS

MODELS		HTGC6EDG44 HTGC6EDG45 HTGC6EDG64 HTGC6EDG65
AVAILABLE CONTROL		Microprocessor
CAPACITY - lb (kg)		6 full sets of Turnout Gear
OVERALL WIDTH - in (mm)	Outer	61.13 (1553)
	Inner	53.94 (1370)
OVERALL DEPTH - in (mm)	Outer	32.75 (832)
	Inner	29.19 (741)
OVERALL HEIGHT - in (mm)	Outer	79.5 (2019)
	Inner	60 (1524)
EXHAUST DIAMETER - in (mm)		6 (152)
OUTLET AIRFLOW - cfm (m3/h)		300 (510)
ELECTRIC HEATING - KW		12 (240) 9 (208)
ELECTRIC CONNECTION - CIRCUIT BREAKER	208V - 50/60 Hz 1 Ph	60 Amp Breaker
	208V - 50/60 Hz 3 Ph	35 Amp Breaker
	240V - 50/60 Hz 1 Ph	70 Amp Breaker
	240V - 50/60 Hz 3 Ph	40 Amp Breaker
NET WEIGHT - lb (kg)		570 (260)
SHIPPING WEIGHT - lb (kg)		630 (290)
AGENCY APPROVALS		

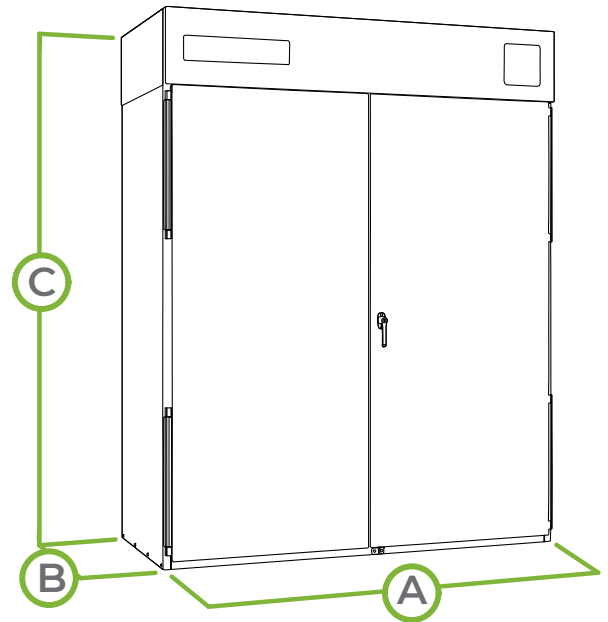

DIMENSIONS

A. OVERALL WIDTH - in (mm)	61.13 (1553)
B. OVERALL DEPTH - in (mm)	32.75 (832)
C. OVERALL HEIGHT - in (mm)	79.5 (2019)

For the most accurate information, the installation guide should be used for all design and construction purposes. Due to continuous product improvements, design and specifications subject to change without notice. The quality management system of Alliance Laundry Systems has been registered to ISO 9001.

Архангельск (8182)63-90-72
Астана (7172)727-132
Астрахань (8512)99-46-04
Барнаул (3852)73-04-60
Белгород (4722)40-23-64
Брянск (4832)59-03-52
Владивосток (423)249-28-31
Волгоград (844)278-03-48
Вологда (8172)26-41-59
Воронеж (473)204-51-73
Екатеринбург (343)384-55-89
Иваново (4932)77-34-06

Ижевск (3412)26-03-58
Иркутск (395)279-98-46
Казань (843)206-01-48
Калининград (4012)72-03-81
Калуга (4842)92-23-67
Кемерово (3842)65-04-62
Киров (8332)68-02-04
Краснодар (861)203-40-90
Красноярск (391)204-63-61
Курск (4712)77-13-04
Липецк (4742)52-20-81
Киргизия (996)312-96-24-47

Магнитогорск (3519)55-03-13
Москва (495)268-04-70
Мурманск (8152)59-64-93
Набережные Челны (8552)20-53-41
Нижний Новгород (831)429-08-12
Новокузнецк (3843)20-46-81
Новосибирск (383)227-86-73
Омск (3812)21-46-40
Орел (4862)44-53-42
Оренбург (3532)37-68-04
Пенза (8412)22-31-16
Казахстан (772)734-952-31

Пермь (342)205-81-47
Ростов-на-Дону (863)308-18-15
Рязань (4912)46-61-64
Самара (846)206-03-16
Санкт-Петербург (812)309-46-40
Саратов (845)249-38-78
Севастополь (8692)22-31-93
Симферополь (3652)67-13-56
Смоленск (4812)29-41-54
Сочи (862)225-72-31
Ставрополь (8652)20-65-13
Таджикистан (992)427-82-92-69

Сургут (3462)77-98-35
Тверь (4822)63-31-35
Томск (3822)98-41-53
Тула (4872)74-02-29
Тюмень (3452)66-21-18
Ульяновск (8422)24-23-59
Уфа (347)229-48-12
Хабаровск (4212)92-98-04
Челябинск (351)202-03-61
Череповец (8202)49-02-64
Ярославль (4852)69-52-93